



28 Clos Gwaith Dur, Ebbw Vale, NP23 6EP

£100,000 Leasehold

Ground Floor Flat • One Bedroom • Popular Location • Allocated Parking •

Ideal Investment Opportunity/First Time Buy



1 Bethcar Street, Ebbw Vale, Gwent, NP23 6HH
Tel: 01495 302301 Email: ebbwvale@bidmeadcook.co.uk
www.bidmeadcook.co.uk

A ground floor flat on the popular Redrow development of Clos Gwaith Dur being conveniently located for access to the town centre and Ebbw Vale train station. The accommodation comprises an entrance hallway, open-plan living/dining room/kitchen, one bedroom and bathroom. Benefits include double glazing, an electric heating system and allocated parking. Early enquiries are recommended.

Agents Note: We are advised this property is Leasehold, a 125 year lease commencing January 2007. The ground rent is fixed at £50 per annum. The Service Charge is paid every 6 months, the last three payments were £750, £750 then £760. The Service Charge is reviewed annually, during March.



Council Tax band: B

Tenure: Leasehold

EPC Energy Efficiency Rating: C

EPC Environmental Impact Rating: C

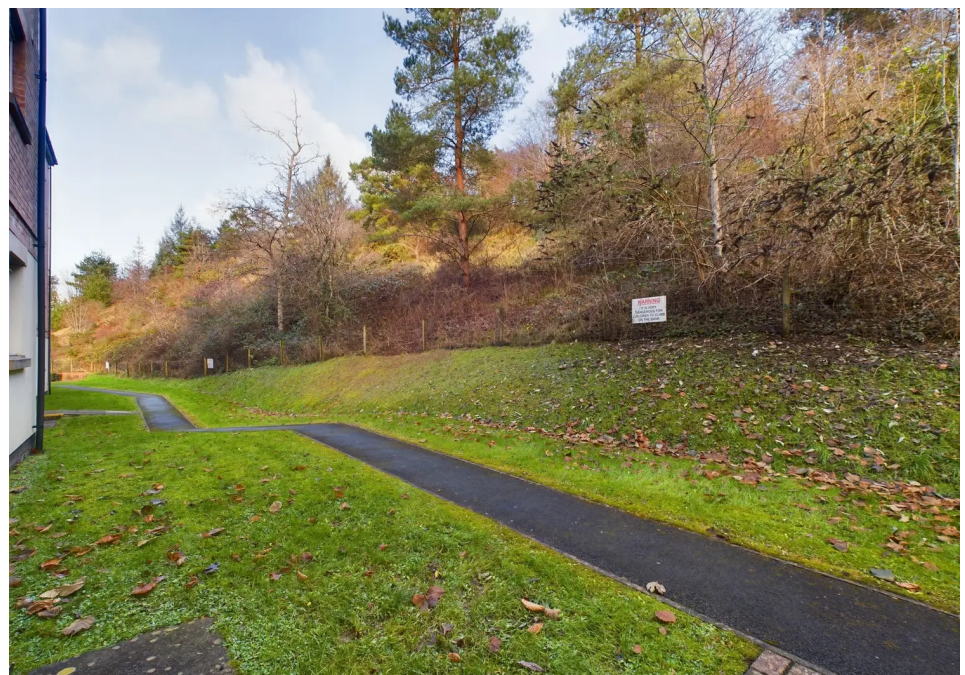

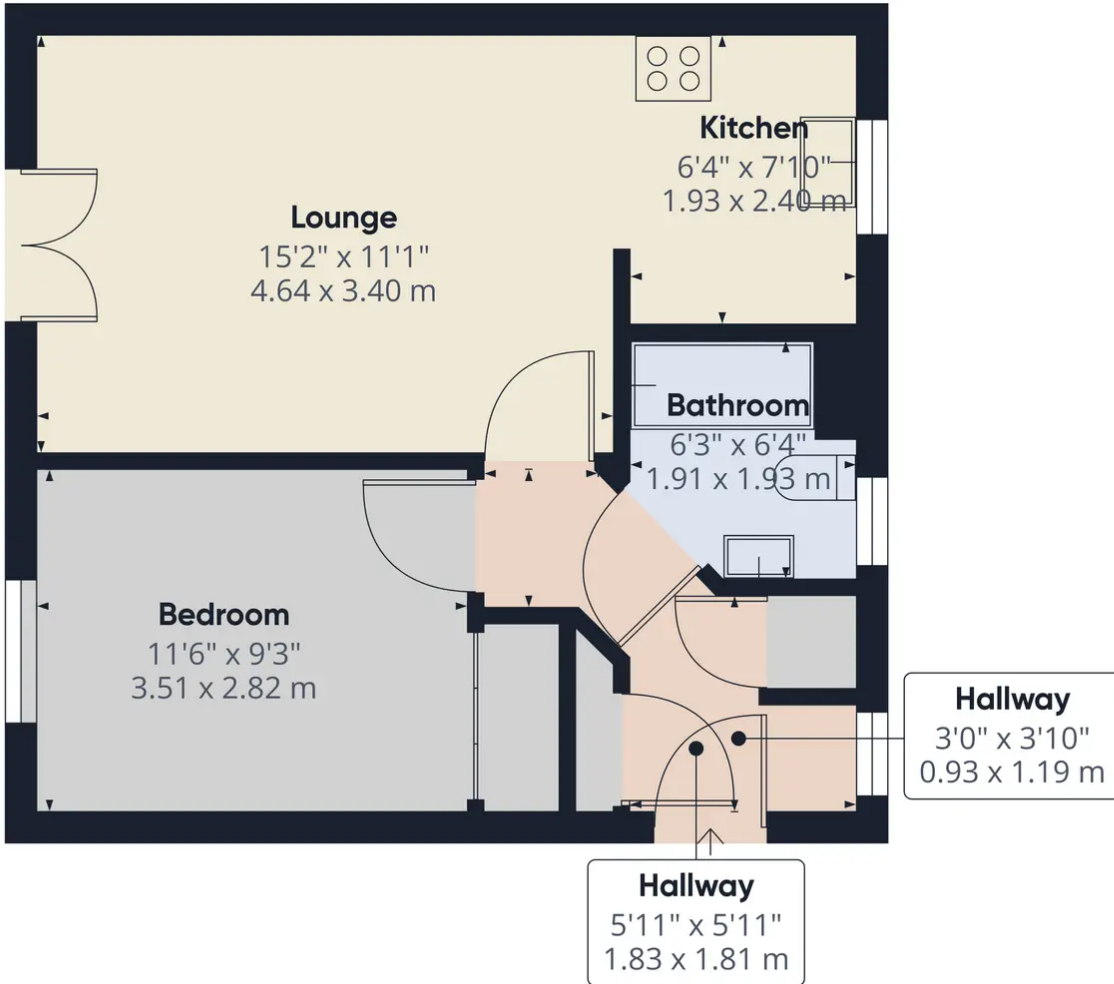

Approximate total area^m
445.84 ft²
41.42 m²

Excluding balconies and terraces

While every attempt has been made to ensure accuracy, all measurements are approximate, not to scale. This floor plan is for illustrative purposes only.

GIRAFFE360



No statement in these details is to be relied upon as representation of fact, and purchasers should satisfy themselves by inspection or otherwise as to the accuracy of the statements contain within. These details do not constitute any part of any offer or contract. Bidmead Cook and their employees and agents do not have any authority to give warranty or representation whatsoever in respect of this property. These details and all statements herein are provided without any responsibility on the part of Bidmead Cook or the vendors. Equipment: Bidmead Cook has not tested the equipment or central heating system mentioned in these particulars and the purchaser are advised to satisfy themselves as to the working order and condition. Measurements: Great care is taken when measuring, but measurements should not be relied upon for ordering carpets, equipment etc. The Laws of copyright protect this material. Bidmead Cook is the owner of the copyright. This property sheet forms part of our database and is protected by the database right and copyright laws. No unauthorised copying or distribution without permission.

Bidmead Cook is a trading name of trading name of BC Acquisition Ltd. Registered in England No.14967217