



58 California Crescent, California

£260,000 Freehold

Stunning property in sought-after California with a sleek modern interior. Features a wood burner, spacious driveway, two double bedrooms, scenic views, large enclosed rear garden with patio, and easy access to open space. Tranquil location with local amenities.

Council Tax band: A

Tenure: Freehold

Stunning property in sought-after California with a sleek modern interior. Features a wood burner, spacious driveway, two double bedrooms, scenic views, large enclosed rear garden with patio, and easy access to open space. Tranquil location with local amenities.

LOCATION

Nestled in the coastal village of Scratby, California Crescent offers a quintessential seaside living experience. This charming locale, situated along the stunning Norfolk coastline, provides residents with breathtaking views and easy access to the sandy shores. California Crescent is well-connected to local amenities, including quaint shops, eateries, and recreational spaces, ensuring a convenient and relaxed lifestyle. The coastal charm extends beyond the boundaries of this residential haven, inviting residents to explore scenic walking trails, enjoy the fresh sea air, and embrace the laid-back atmosphere of Scratby. With its proximity to both natural beauty and essential conveniences, California Crescent stands as an ideal address for those seeking a coastal retreat with the comforts of seaside living.



Stunning property in sought-after California with a sleek modern interior. Features a wood burner, spacious driveway, two double bedrooms, scenic views, large enclosed rear garden with patio, and easy access to open space. Tranquil location with local amenities.

LOCATION

Nestled in the coastal village of Scratby, California Crescent offers a quintessential seaside living experience. This charming locale, situated along the stunning Norfolk coastline, provides residents with breathtaking views and easy access to



Stunning property in sought-after California with a sleek modern interior. Features a wood burner, spacious driveway, two double bedrooms, scenic views, large enclosed rear garden with patio, and easy access to open space. Tranquil location with local amenities.

LOCATION

Nestled in the coastal village of Scratby, California Crescent offers a quintessential seaside living experience. This charming locale, situated along the stunning Norfolk coastline, provides residents with breathtaking views and easy access to the sandy shores. California Crescent is well-connected to local amenities, including quaint shops, eateries, and recreational spaces, ensuring a convenient and relaxed lifestyle. The coastal charm extends beyond the boundaries of this residential haven, inviting residents to explore scenic walking trails, enjoy the fresh sea air, and embrace the laid-back atmosphere of Scratby. With its proximity to both natural beauty and essential conveniences, California Crescent stands as an ideal address for those seeking a coastal retreat with the comforts of seaside living.

CALIFORNIA CRESCENT, CALIFORNIA

Presenting this stunning property, situated in the sought-after location of California, NR29. Boasting a sleek and modern interior throughout, this beautifully presented home offers an ideal setting for family living.

As you enter the property, you are immediately greeted by a spacious driveway, providing ample parking space. The modern interior features a thoughtfully designed layout, ensuring maximum functionality and comfort for everyday living.

The highlight of this property is the feature wood burner, creating a warm and cosy ambience in the living area. Perfect for those chilly evenings, this addition adds a touch of elegance to the overall aesthetic.

With two double bedrooms, this residence provides ample space for family members or guests. The sliding doors in the rear of the property not only flood the living room with natural light but also offer beautiful scenic views of the surrounding area.

The large enclosed rear garden is a true gem, providing a private sanctuary for outdoor relaxation and entertainment. The garden features a patio area, perfect for al fresco dining or hosting summer gatherings. Step onto the lush green lawn, and you'll find a gate leading to open space atop cliffs, allowing for easy access to the great outdoors.



GROUND FLOOR

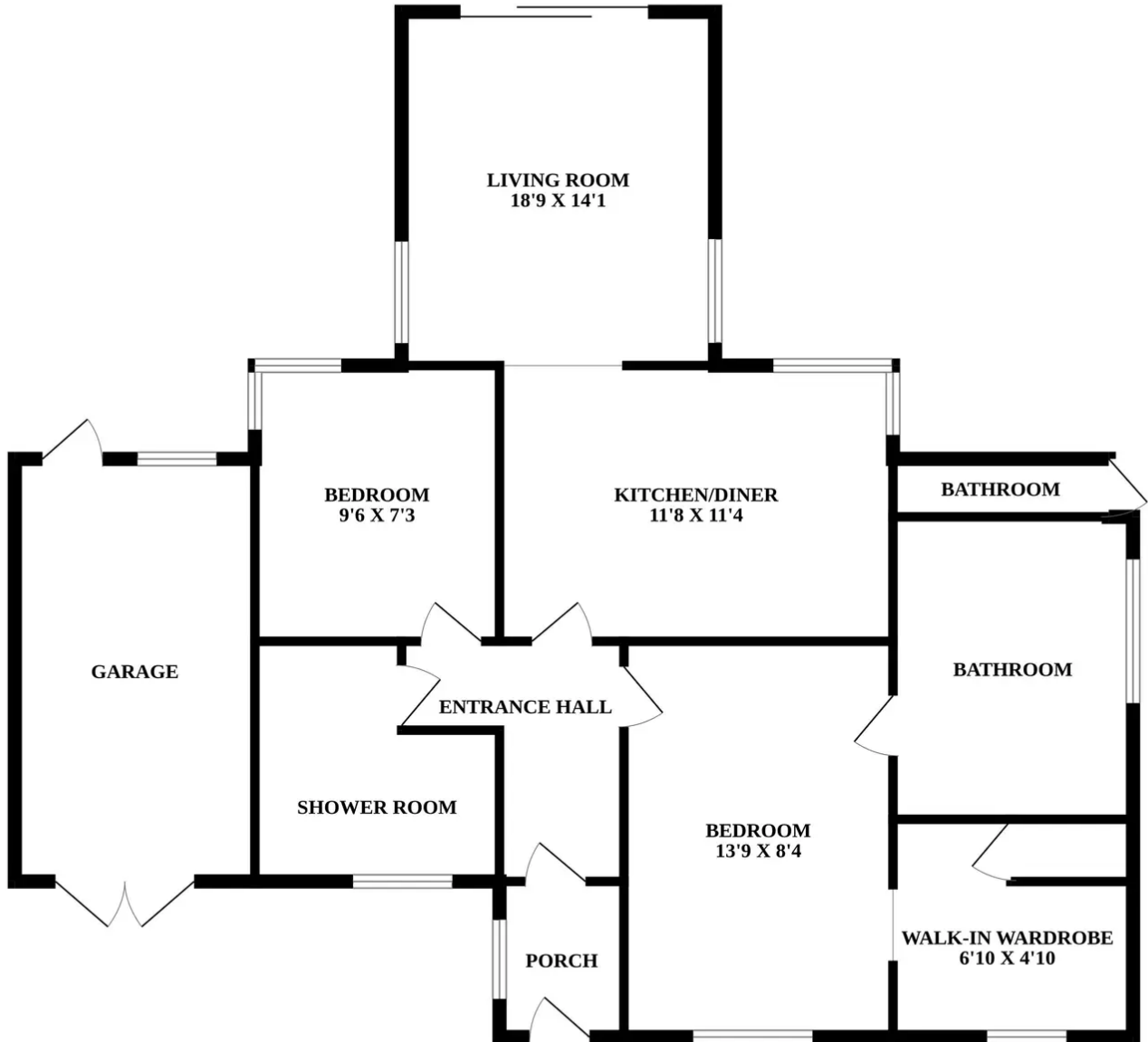

Whilst every attempt has been made to ensure the accuracy of the floorplan contained here, measurements of doors, windows, rooms and any other items are approximate and no responsibility is taken for any error, omission or mis-statement. This plan is for illustrative purposes only and should be used as such by any prospective purchaser. The services, systems and appliances shown have not been tested and no guarantee as to their operability or efficiency can be given.
Made with Metropix ©2023

You can include any text here. The text can be modified upon generating your brochure.

You can include any text here. The text can be modified upon generating your brochure.

