



13 Anthea Road, Paignton

Paignton

£550,000

ABSOLUTE



13 Anthea Road

Paignton, Paignton

Stunning detached family home with spectacular sea views. 4 bedrooms, extended kitchen/diner, converted garage into versatile office space. Beautifully designed interior with bi-folding doors to private enclosed rear garden. Driveway parking for 3-4 cars. Close to amenities and schools.

Council Tax band: D

Tenure: Freehold

EPC Energy Efficiency Rating: E

EPC Environmental Impact Rating: F

- Spectacular sea views
- Extended kitchen/diner
- Converted garage to office space
- Driveway parking
- Private enclosed rear garden
- Detached family home
- Two ensuites and a family bathroom
- Bi-folding doors leading to the garden
- Excellent family location
- Four double bedrooms



13 Anthea Road

Paignton, Paignton

Fabulous cul-de-sac location in Preston, benefitting from the sea views and in a quiet residential area. The property is within easy access of Paignton and other nearby towns and a regular bus service runs nearby. Agents Note-This property is offered for sale on behalf of a relative of a member of staff of Absolute Sales and Lettings, this constitutes a declarable interest within the meaning of the Estate Agents Act 1979 Section 21.

Absolute Sales & Lettings

Absolute Sales & Lettings, 27 Hyde Road - TQ4 5BP

01803 890110

paignton@movewithabsolute.co.uk

<http://www.movewithabsolute.co.uk>



Basement
Approx. 40.1 sq. metres (431.4 sq. feet)

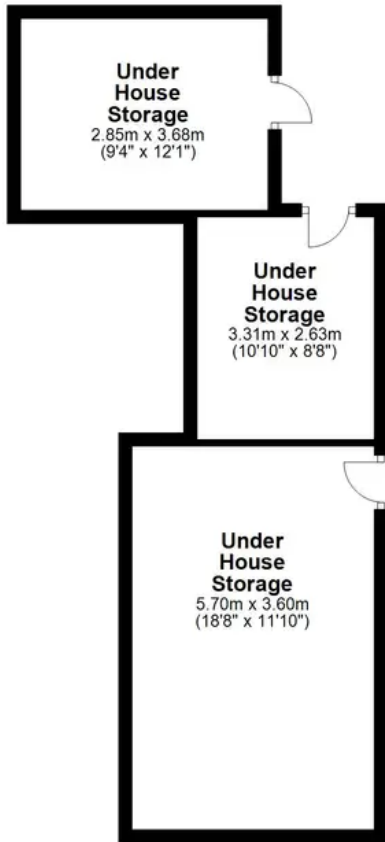

Ground Floor
Approx. 106.5 sq. metres (1145.9 sq. feet)



First Floor
Approx. 57.3 sq. metres (616.7 sq. feet)

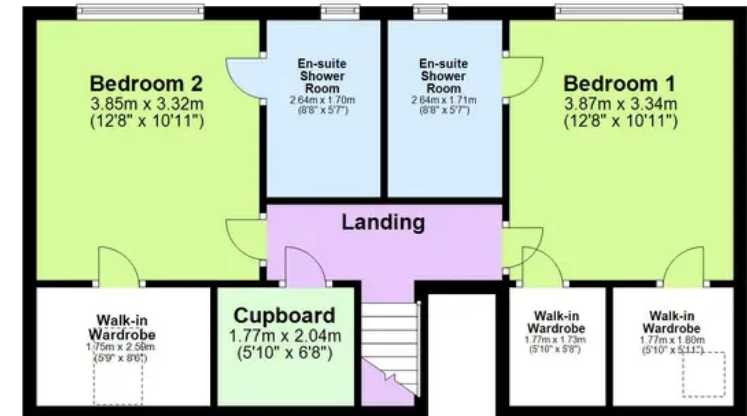

Total area: approx. 203.8 sq. metres (2194.0 sq. feet)