



Stoneleigh Park Road

Epsom

In Excess of £300,000

# Stoneleigh Park Road

## Epsom

- Two double bedrooms
- Ground floor maisonette
- Private garden
- Short walk to mainline station
- Close to amenities
- Perfect opportunity to put your own stamp on a property
- No-chain

Kaybridge Residential are proud to present to the market this ground floor maisonette which boasts two generously proportioned double bedrooms, a private garden, and an excellent location close to transport links and local amenities. With the flexibility to put your personal touch on the property, this is a fantastic opportunity for those seeking a comfortable and tailor-made living space. Upon entering you are greeted with a welcoming hallway which leads to two double bedrooms, bathroom, kitchen and a bay-front living room. Don't miss out on securing this property and starting the next chapter in your life. Contact our experienced team to arrange a viewing today.





## Stoneleigh Park Road

Epsom

Council Tax band: C

Tenure: Leasehold





# Stoneleigh Park Road, Epsom, KT19

Approximate Area = 662 sq ft / 61.4 sq m

For identification only - Not to scale

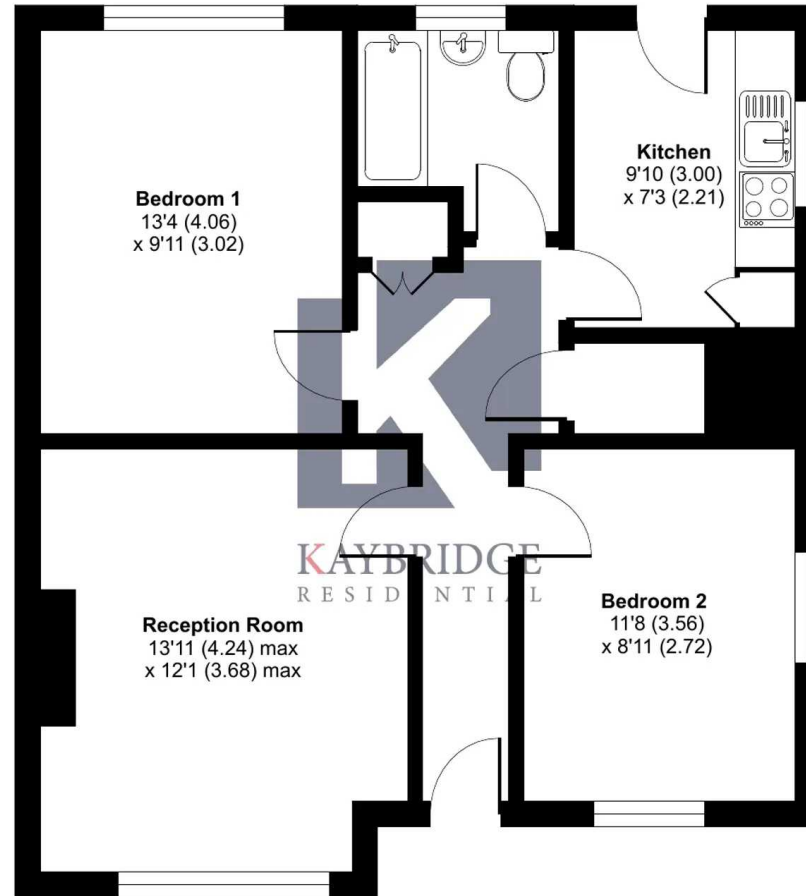

GROUND FLOOR



Floor plan produced in accordance with RICS Property Measurement Standards incorporating International Property Measurement Standards (IPMS2 Residential). © nlcheom 2023. Produced for Kaybridge Residential Ltd. REF: 1067806



## Kaybridge Residential Epsom

Kaybridge Residential Estate Agents, 23 Stoneleigh Broadway - KT17 2JE

02080040474 • [info@kbridge.co.uk](mailto:info@kbridge.co.uk) • [www.kaybridgeresidential.co.uk/](http://www.kaybridgeresidential.co.uk/)