



## FOR SALE

3 Bed Semi-Detached House in Pintail Close, Whetstone, LE8 6XW  
£240,000

\*\*\* No Chain \*\*\* Three bedroom semi detached property occupying a quiet cul-de-sac position and on a generous plot. The accommodation comprises entrance hall, lounge, dining room, kitchen, conservatory, three bedrooms, bathroom, detached garage, rear garden and off road parking.



GROUND FLOOR  
475 sq.ft. (44.1 sq.m.) approx.

1ST FLOOR  
350 sq.ft. (32.5 sq.m.) approx.

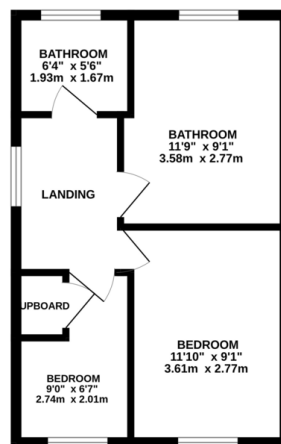
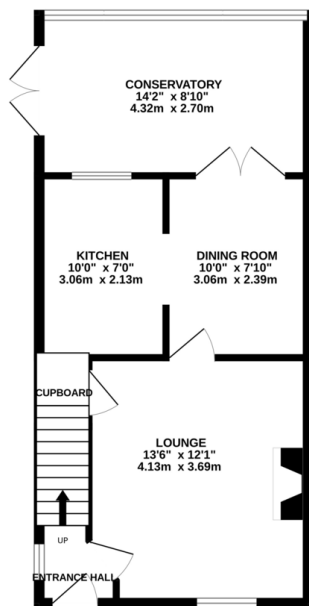

TOTAL FLOOR AREA: 825 sq.ft. (76.6 sq.m.) approx.  
While every attempt has been made to ensure the accuracy of the foregoing contained here, measurements of doors, windows, rooms and any other items are approximate and no responsibility is taken for any error, omission or mis-statement. The plan is for guidance purposes only and should be checked as such by any prospective purchaser. The services, systems and appliances shown have not been tested and no guarantee is to their operability or efficiency can be given.  
Made with Metropix ©2023

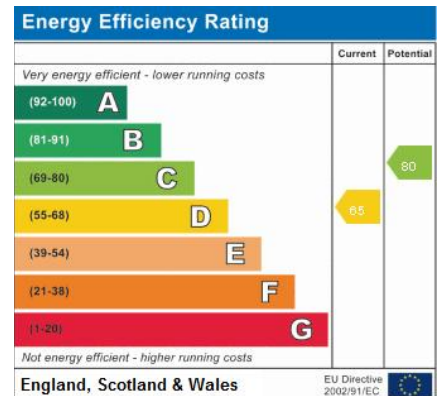

- No Chain
- Corner Plot
- Semi Detached
- Three Bedrooms
- Quiet Cul-De-Sac
- Detached Garage
- Good Size Rear Garden
- Conservatory

**Agents Note:** Whilst every care has been taken to prepare these sales particulars, they are for guidance purposes only. All measurements are approximate are for general guidance purposes only and whilst every care has been taken to ensure their accuracy, they should not be relied upon and potential buyers are advised to recheck the measurements.

