



2 Bedroom End Terraced House £1750pcm

Wye House Gardens, Marlborough, SN8 1AB

mcfarlane
property.com

2 Bedroom Terraced House

Marlborough,

- Walking Distance to High Street
- Allocated Parking
- Two double bedrooms with built in wardrobes
- Study Area

An elegant Regency style, mews house offering versatile accommodation situated in a prestigious and peaceful location overlooking established beautifully maintained gardens within walking distance to the High Street.

The Living Room has an attractive fireplace with living-flame electric fire and double doors into the Conservatory with French Doors onto the terrace and views over the beautiful gardens. The Dining Room overlooks a small courtyard garden to the rear and leads into the Kitchen, fitted with a range of wall and base units with worktops, inset sink and drainer, inset oven and hob, extractor over, built in dishwasher, fridge freezer and tiled floor. The Cloakroom is fitted with a white suite comprising low level w.c & hand basin, part-tiled walls, space and plumbing for washing machine. Both Bedrooms off a galleried landing, are good sized doubles with fitted wardrobes. The



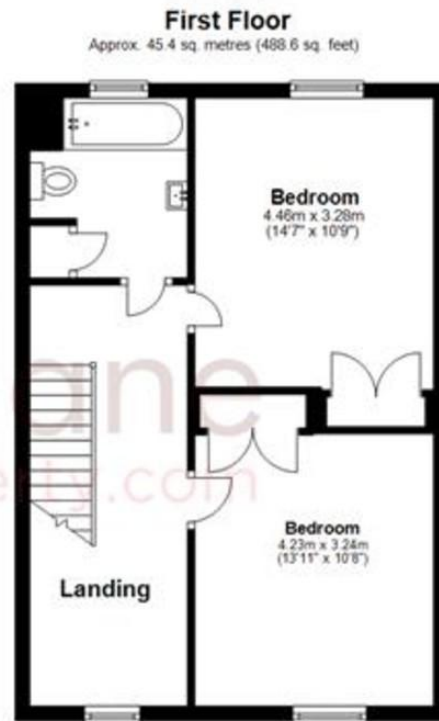

Total area: approx. 96.1 sq. metres (1033.9 sq. feet)

We where you LIVE

Our team are friendly, experienced and are all local. They know it better than they do their own living rooms and can help you find what you're looking for because **we love where we live.**

We would be delighted to show you around this property.

Because every home needs a personal touch.

If you would like to view this property then please get in touch.

☎ 01793 611841

✉ lettings@mcfarlaneproperty.com

mcfarlaneproperty.com

mcfarlane
property.com

Cricklade.
102 High Street
Cricklade SN6 6AA
☎ 01793 751044

Marlborough.
106 High Street
Marlborough SN8 1LT
☎ 01672 514380

Old Town.
28-30 Wood Street
Swindon SN1 4AB
☎ 01793 296880

Swindon.
The Village Centre,
Redhouse SN25 2FW
☎ 01793 296600

Agents Note: Whilst every care has been taken to prepare these sales particulars, they are for guidance purposes only. All measurements are approximate are for general guidance purposes only and whilst every care has been taken to ensure their accuracy, they should not be relied upon and potential buyers are advised to recheck the measurements