



High Street, Colnbrook

£1,100 PCM

This one bedroom spacious first floor flat is located in Colnbrook High Street and is walking distance to the local amenities. The property comprises: a communal lobby with intercom entry, entrance hall, lounge, kitchen, bedroom and bathroom. The historic village of Colnbrook is situated within easy access of the M4/M25 motorways and Heathrow Airport. Windsor and Slough shopping centres are a short driving distance. Wraysbury Railway Station is a short drive and serves the Windsor/Waterloo line. Available now. Unfurnished. Energy rating: C



B.S. Bennett Estate Agents

2 Staines Road, Wraysbury, Staines, Middlesex, TW19 5BS
t: 01784 483839 e: post@bsbennett.co.uk

bsbennett.co.uk

B. S. BENNETT



Location: Centrally located with local amenities including a Budgens convenience store, chemist and public houses including the Ostrich Inn. Situated to the west of Heathrow with easy access to the M25 and M4 motorways. Also, handily placed for some local bus routes.

Deposit: 5 weeks rent which is £1,269.00 for this rental. The deposit is used to cover any potential damages. The deposit will be protected by one of the approved schemes.

Local Authority: Slough Borough Council

Observatory House, 25 Windsor Rd, Slough, Berkshire SL1 2EL

Council Tax Band: C

Payable 2023/2024: £1,835.47

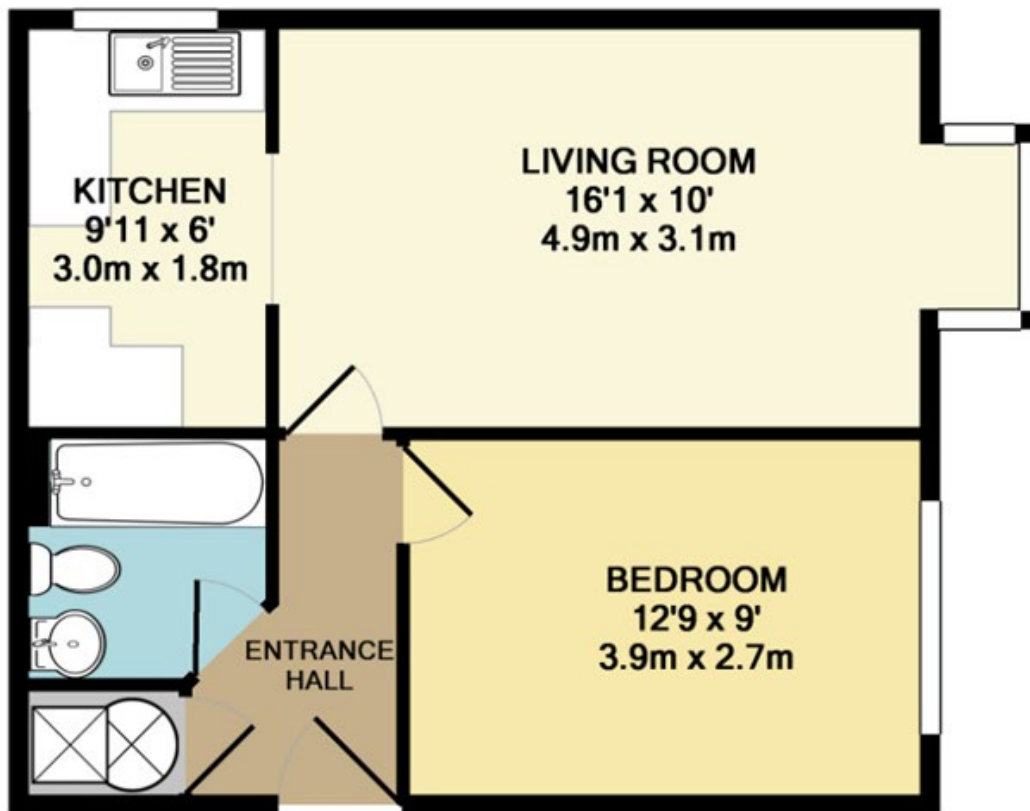

TOTAL APPROX. FLOOR AREA 428 SQ.FT. (39.8 SQ.M.)

Whilst every attempt has been made to ensure the accuracy of the floor plan contained here, measurements of doors, windows, rooms and any other items are approximate and no responsibility is taken for any error, omission, or mis-statement. This plan is for illustrative purposes only and should be used as such by any prospective purchaser. The services, systems and appliances shown have not been tested and no guarantee as to their operability or efficiency can be given

Made with Metropix ©2017