



Elliot Heath
ESTATE AGENTS

43 Moorymead Close, Watton At Stone

Guide Price **£210,000**

43 Moorymead Close

Watton At Stone, Hertford

Beautifully presented ground floor 1-bed apartment in popular Watton At Stone village. Spacious living/dining room, modern kitchen, bathroom & double bedroom. UPVC double glazing, communal parking & gardens. Motorway links & train station for easy commuting. Call 01920 293333 for a viewing. Council Tax band: B

Tenure: Leasehold

EPC Energy Efficiency Rating: E

EPC Environmental Impact Rating: D



Ground Floor

Approx. 38.9 sq. metres (418.9 sq. feet)

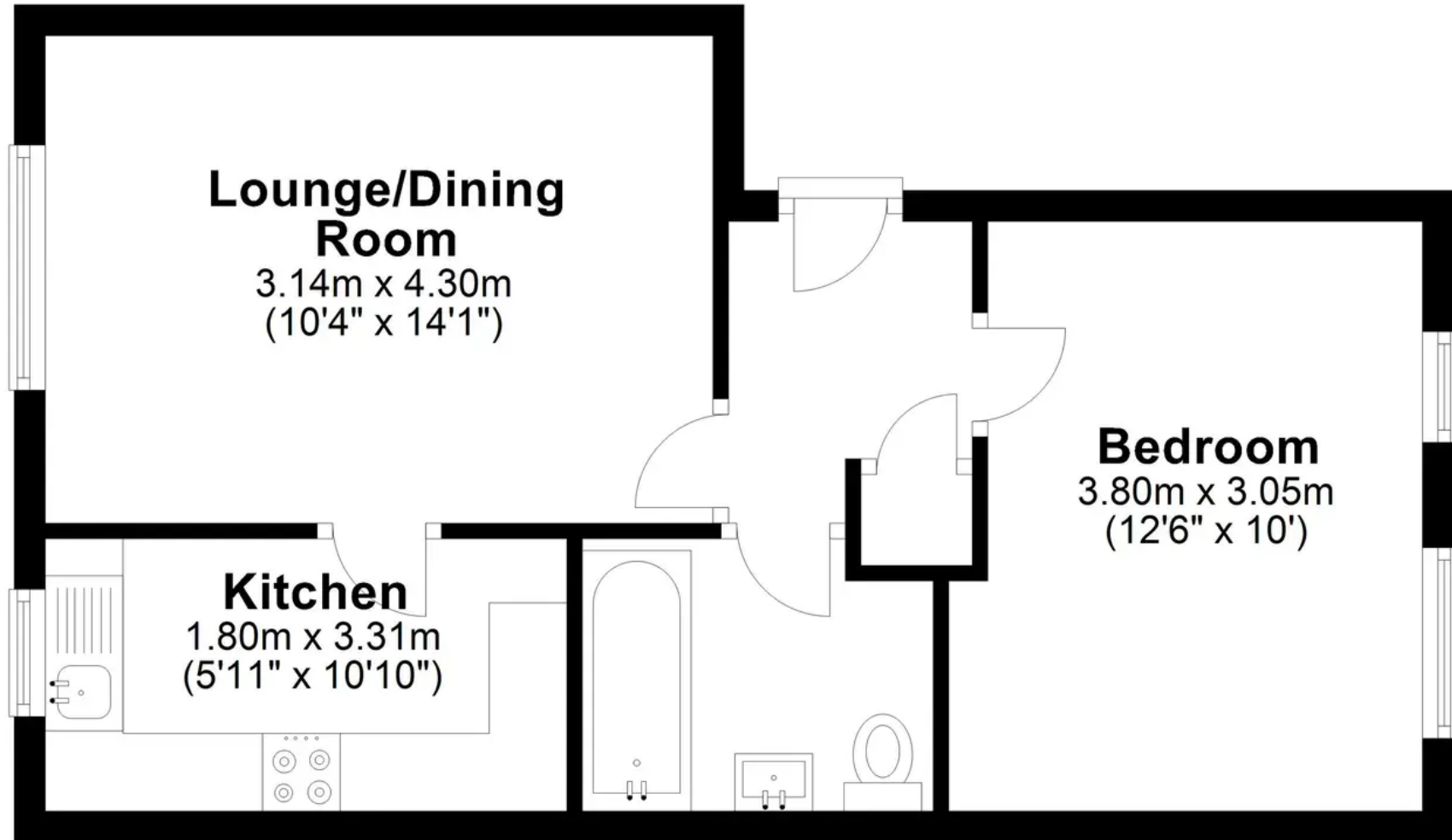

Total area: approx. 38.9 sq. metres (418.9 sq. feet)

FOR ILLUSTRATIVE PURPOSES ONLY, NOT TO SCALE

Whilst every attempt has been made to ensure the accuracy of the floor plan shown, all measurements, positioning, fixtures, features, fittings and any other data shown are an approximate interpretation for illustrative purposes only and are not to scale. No responsibility is taken for any error, omission, miss-statement or use of data shown.

Property marketing provided by www.matthewkyle.co.uk

Entrance Hall

Entry phone system, wood effect flooring, cupboard housing hot water tank, doors to:

Lounge/Dining Room

10' 4" x 14' 1" (3.15m x 4.29m)

With double glazed window to side aspect, wood effect flooring, under floor heating, door to:

Kitchen

5' 11" x 10' 10" (1.80m x 3.30m)

With double glazed window to side aspect. Fitted with a range of wall and base storage units with work surface over incorporating a sink and drainer unit, induction hob with integrated oven beneath and extractor hood over, plumbing for washing machine, fridge/freezer, tiled splash back areas.

Bedroom

12' 6" x 10' 0" (3.81m x 3.05m)

With two double glazed windows to side aspect, electric radiator.

Bathroom

Fitted with a suite comprising panel enclosed bath with mixer tap and shower over and glass shower screen, vanity unit with inset wash hand basin, dual flush wc, heated towel rail, tiled splash back areas.





Communal Garden

Communal garden area.

ALLOCATED PARKING

1 Parking Space

Communal parking area.





Elliot Heath Estate Agents

Elliot Heath Estate Agents, 7 Star Street - SG12 7AA

01920 29 33 33

hello@elliotheath.co.uk

elliotheath.co.uk