

25 Stewart Court

A superb two bedroom chain free first floor retirement apartment in the pretty spot of Stewart Court, Epping.

Council Tax band: E

Tenure: Leasehold

- FIRST FLOOR APARTMENT
- TOWN CENTRE LOCATION
- COMMUNAL LOUNGE AREA WITH KITCHENETTE
- LAUNDRY FACILITIES
- GREAT COMMUNAL GARDENS
- CHAIN FREE
- WALK IN SHOWER



Lounge

23' 6" x 8' 1" (7.16m x 2.46m)

Kitchen

8' 1" x 7' 5" (2.46m x 2.26m)

Bedroom One

10' 11" x 9' 3" (3.33m x 2.82m)

Bedroom Two

14' 0" x 10' 0" (4.27m x 3.05m)

Family Bathroom

Storage Room

Spacious, bright and airy, the smartly presented apartments of Stewart Court are a great find. Entered via intercom access and catering for the over 55's, here you are only moments away from Epping's wonderful high street. Inside you'll find a roomy living area that's full of natural light and with neutral interiors - the perfect accompaniment for your existing furniture to slot right in! Within the kitchen, you'll find integrated appliances and fitted units to cater for all your storage needs. In addition, with two double bedrooms you have so much scope here. The second double would make a great guestroom or separate dining space - the options are endless! Completing the inside, the bathroom is smartly presented with a vanity unit providing plenty of storage space to keep all your toiletries neatly stored away.





Hammond
& Smith



Hammond
& Smith



Hammond
& Smith



Hammond
& Smith

Ground Floor

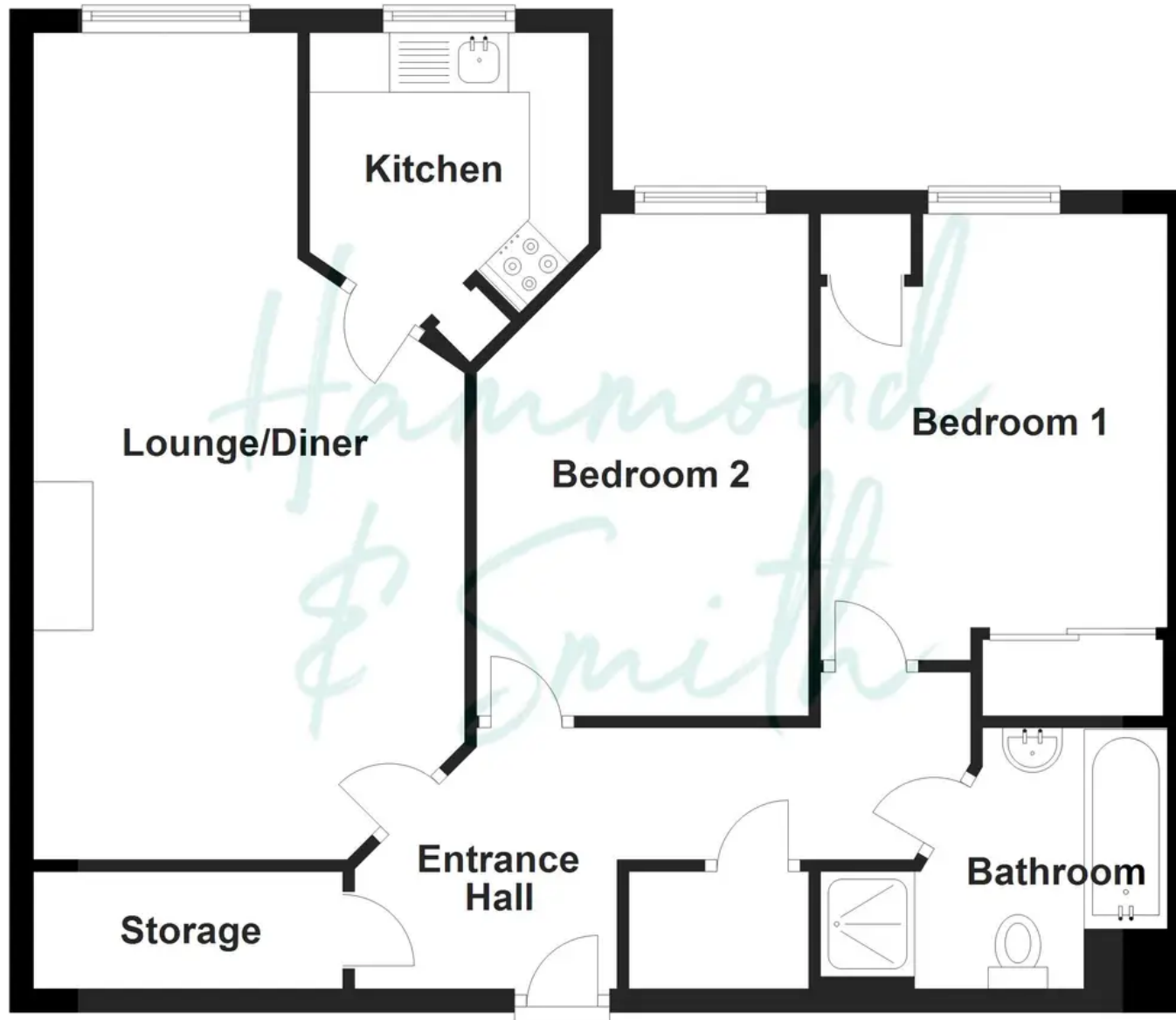

Floorplans are provided for guidance only. They are not to scale & must not form any part of a legal contract or be reproduced
Plan produced using PlanUp.