

44 Hillyfields

Loughton, Loughton

Located just a short walk from both Debden & Loughton Central Line Station is this well presented Ground Floor flat with private garden space!

Council Tax band: C

Tenure: Leasehold

- GROUND FLOOR APARTMENT
- PRIVATE GARDENS
- WALKING DISTANCE TO CENTRAL LINE STATION
- RESIDENTS PARKING
- SHORT WALK TO LOCAL AMENITIES
- TWO DOUBLE BEDROOMS
- FRONT AND REAR PROPERTY ACCESS



Lounge

13' 8" x 12' 2" (4.17m x 3.71m)

Kitchen

12' 2" x 11' 2" (3.71m x 3.4m)

Bedroom 1

13' 9" x 10' 0" (4.19m x 3.05m)

Bedroom 2

12' 2" x 11' 2" (3.71m x 3.4m)

Bathroom

Stepping inside this wonderful property you are greeted with a large front reception room, gaining an abundance of light through the front windows overlooking green spaces. The general aspect of space this home offers is felt all around the property, with the separate Kitchen/Diner that gives you a generous amount of worktop space, breakfast bar and enough room to house all your appliances. The property also offers 2 good sized double bedrooms, one currently being used as a home gym however would make amazing office space for Hybrid working/WFH'ers...

Once you have opened the rear door you are met with your own private rear garden, a perfect place to relax after dinner...imagine cooking up a BBQ after a long week at work in the summer months, or kicking a ball about with your little one - having this private space is ideal for any prospective buyer!





Ground Floor

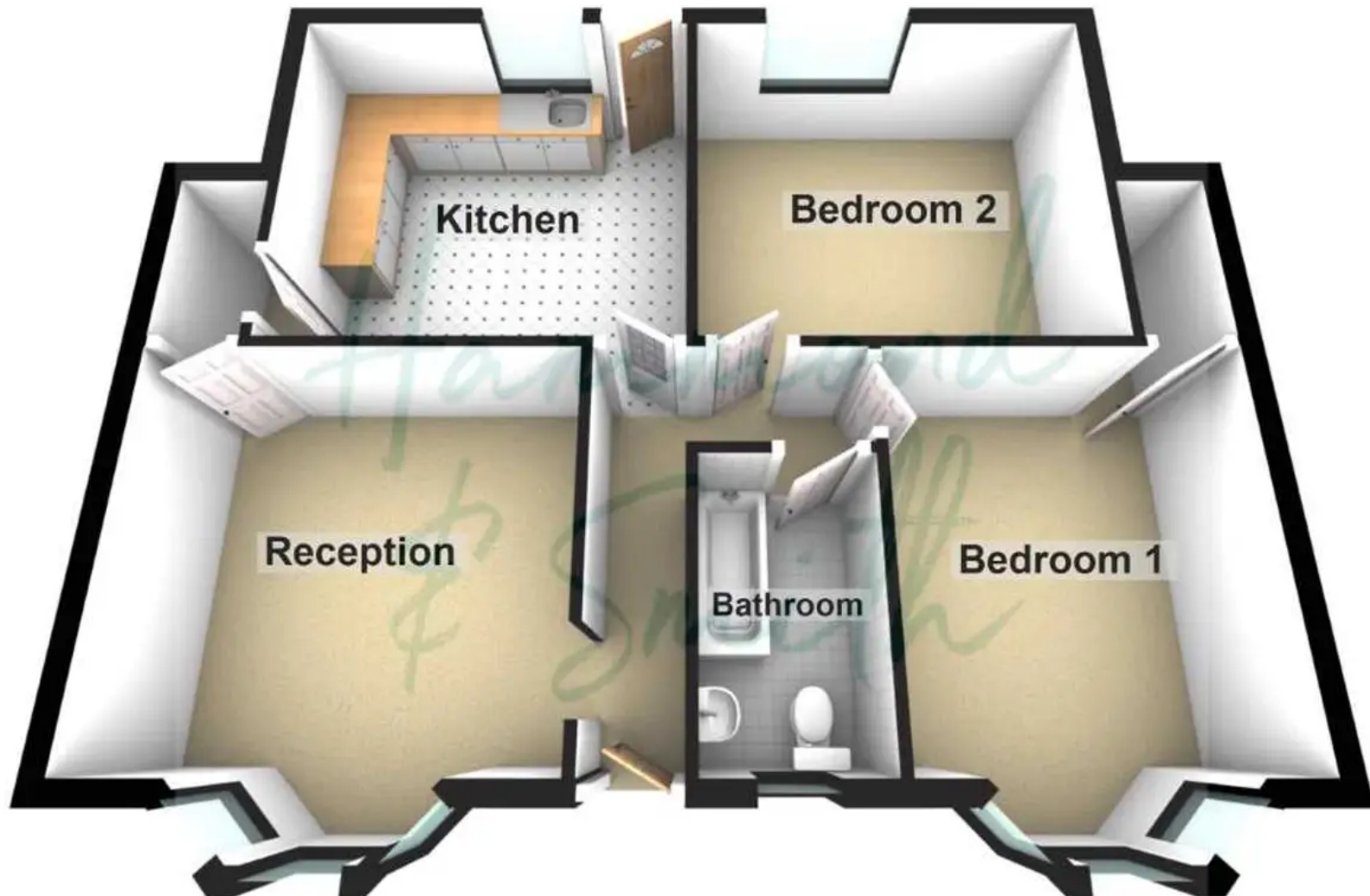

Floorplans are provided for guidance only. They are not to scale & must not form any part of a legal contract
or be reproduced
Plan produced using PlanUp.