

55 Charles Street

Epping, Epping

With fantastic opportunity to add your own mark, this three bedroom home along Charles Street, Epping is a superb find. Just a short walk Epping Tube Station and with opportunity to extend (STP) this is one not to miss.

Council Tax band: D

Tenure: Freehold

- CLOSE TO EPPING STATION
- OFF ROAD PARKING
- IDEAL FIRST TIME BUY
- CLOSE TO IVY CHIMNEYS AND COOPERSALE HALL SCHOOL
- POTENTIAL TO EXTEND (STP)
- THREE BEDROOMS
- ESTABLISHED GARDEN



Entrance Hall

Lounge Area

12' 10" x 11' 9" (3.90m x 3.57m)

Dining Area

14' 8" x 9' 11" (4.48m x 3.02m)

Shower Room

8' 6" x 4' 11" (2.60m x 1.50m)

Kitchen

15' 7" x 7' 8" (4.74m x 2.34m)

Bedroom 1

14' 8" x 12' 10" (4.48m x 3.90m)

Bedroom 2

11' 2" x 6' 9" (3.41m x 2.07m)

Bedroom 3

9' 11" x 7' 7" (3.02m x 2.31m)





Ground Floor

Approx. 42.7 sq. metres (459.7 sq. feet)

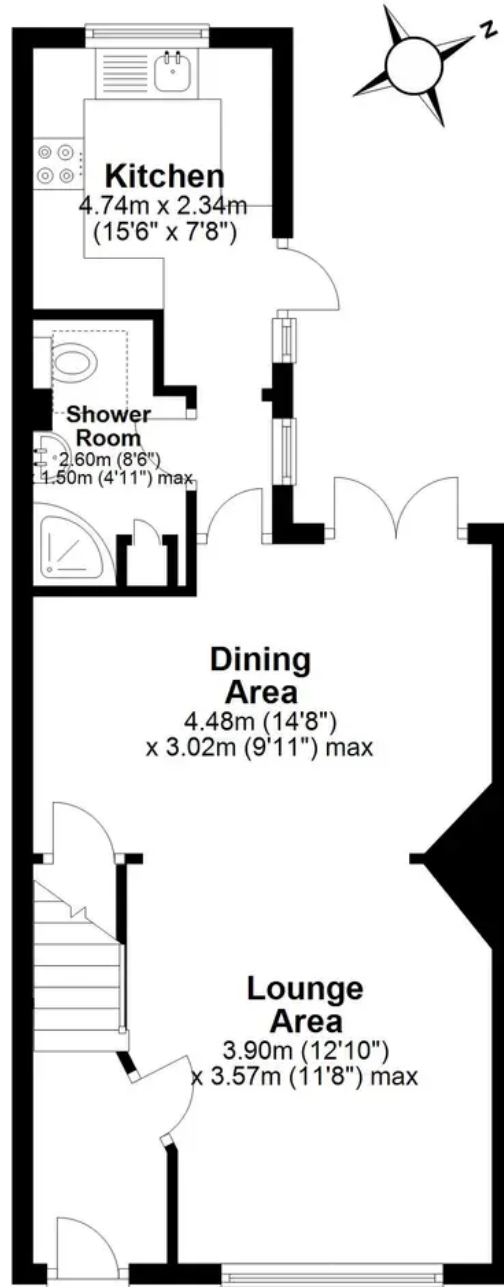

First Floor

Approx. 33.2 sq. metres (357.3 sq. feet)

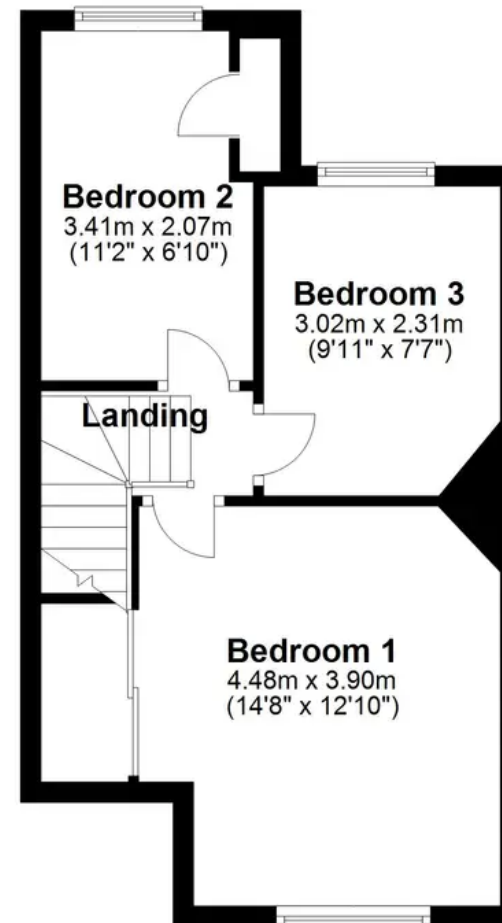

Total area: approx. 75.9 sq. metres (816.9 sq. feet)