



**23 Robin Hill, Maidenhead, Berkshire SL6 2GZ**

## 23 ROBIN HILL, MAIDENHEAD BERKSHIRE SL6 2GZ

**PRICE: £500,000 LEASEHOLD**

Offered to the market with NO ONWARD CHAIN. A stunning & spacious apartment overlooking Maidenhead Golf Course situated in a sought-after location within walking distance of Maidenhead town centre & railway station (Elizabeth Line). This executive penthouse apartment offers an abundance of natural light, spacious rooms and good quality fixtures and fittings. The property features a master bedroom with en-suite, dual aspect second double bedroom with fitted wardrobes & Juliet balcony, family bathroom, large open plan living/dining room with French doors leading to generous terrace with views over the golf course and fully fitted kitchen with integrated appliances. Outside the property benefits from one allocated carport parking space and access to stunning communal gardens with direct access onto the golf course.

**\*GATED DEVELOPMENT \*LIFT & STAIRCASE TO SECOND FLOOR \*DOUBLE ASPECT LIVING/DINING ROOM LEADING ONTO SUN TERRACE \*FITTED & EQUIPPED KITCHEN \*MAIN BEDROOM WITH EN-SUITE SHOWER ROOM \*GUEST DOUBLE BEDROOM \*FAMILY BATHROOM \*ALLOCATED CAR PORT WITH STORAGE CONTAINER \*VISITOR PARKING \*EXTENSIVE COMMUNAL GARDENS \*EPC RATING C \*COUNCIL TAX BAND E**

Ground rent : £200 per annum  
Service Charge £2884 per annum  
Lease remaining: 107 years





**SECOND FLOOR**  
1035 sq.ft. (96.2 sq.m.) approx.

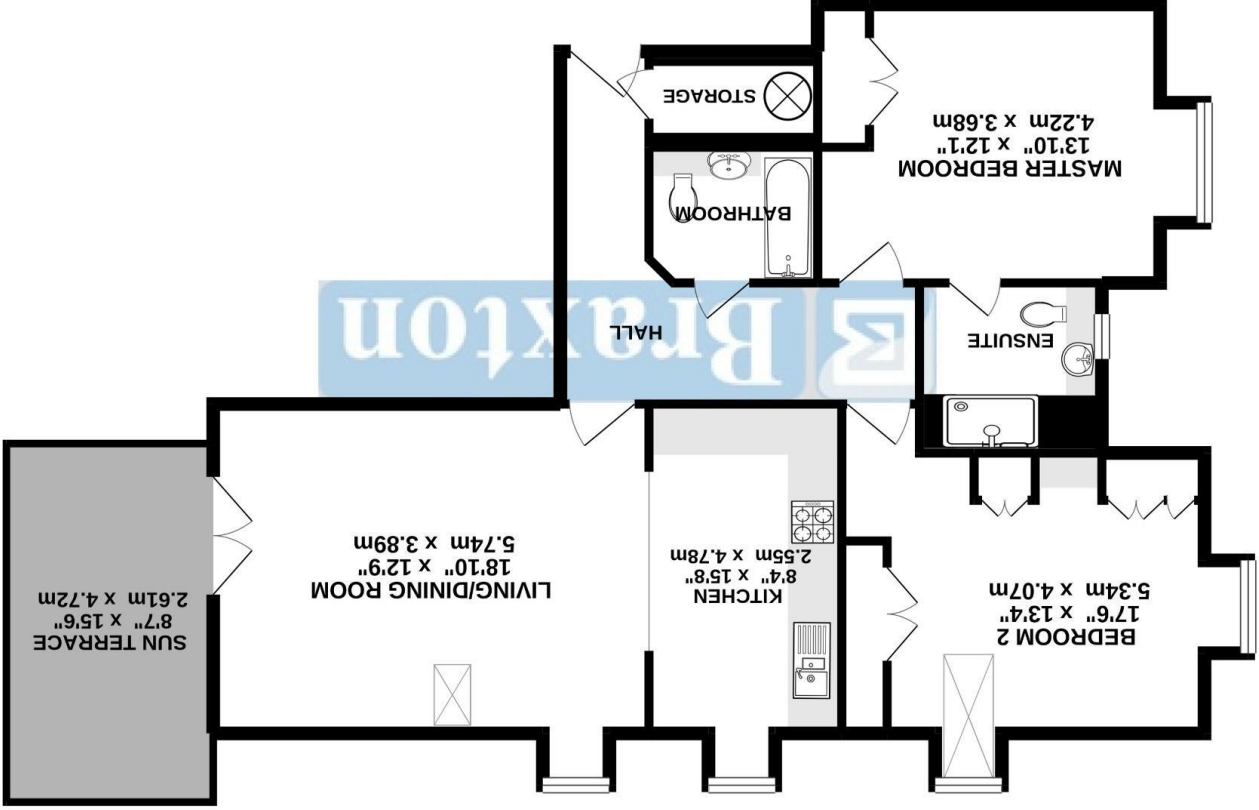

TOTAL FLOOR AREA : 1035 sq.ft. (96.2 sq.m.) approx.  
 Whilst every attempt has been made to ensure the accuracy of the floorplan contained here, measurements of doors, windows, rooms and any other items are approximate and no responsibility is taken for any error, omission or mis-statement. This plan is for illustrative purposes only and should be used as such by any prospective purchaser. The services, systems and appliances shown have not been tested and no guarantee as to their operability or efficiency can be given.  
 Made with Metropix ©2021



39-41 High Street, Maidenhead, Berkshire SL6 1JF  
 Tel: 01628 674234 Fax: 01628 785432  
 Email: [property@braxtons.co.uk](mailto:property@braxtons.co.uk)  
[braxtons.co.uk](http://braxtons.co.uk)  
 Residential Sales | Land & New Homes | Properties to Let | Landlords, Lettings and Management Services

