

25  
YEARS

SERVING  
BEACONSFIELD  
SINCE 1998



103 Maxwell Road, Beaconsfield

Guide Price £600,000

*Ashington Page*

A beautifully presented and spacious, 3 bedroom, terraced family home with off-street parking for two cars and a south facing garden. This lovely home is ideally located within a short walk of the shops, restaurants and the mainline station to London Marylebone with fast trains of less than 25 minutes. It is also within catchment for the popular St Mary's school, sought after grammar and private schools. Planning permission has been approved for a single storey ground floor extension. Application number PL/20/0229/FA.

Tenure: Freehold

EPC: C

Directions: Sat Nav HP9 IRF

Council Tax Band D

These particulars are for guidance only. They are prepared and issued in good faith and are intended to give a fair summary of the property. Any description should not be relied on as a statement or representation of fact or that the property, or its services, are in good condition. The photographs show only certain parts of the property at the time they were taken. Any areas, measurements or distance given are approximate only. Any reference to alterations to, or use of, any part of the property is not a statement that any necessary planning, building regulations or other consent has been obtained. These matters must be verified by an intending purchaser. All statements contained in these particulars in relation to the property are made without responsibility of Ashington Page or its clients. Neither Ashington Page (nor any joint agents) nor any of their employees has any authority to make or give any representation or warranty whatsoever in relation to the property

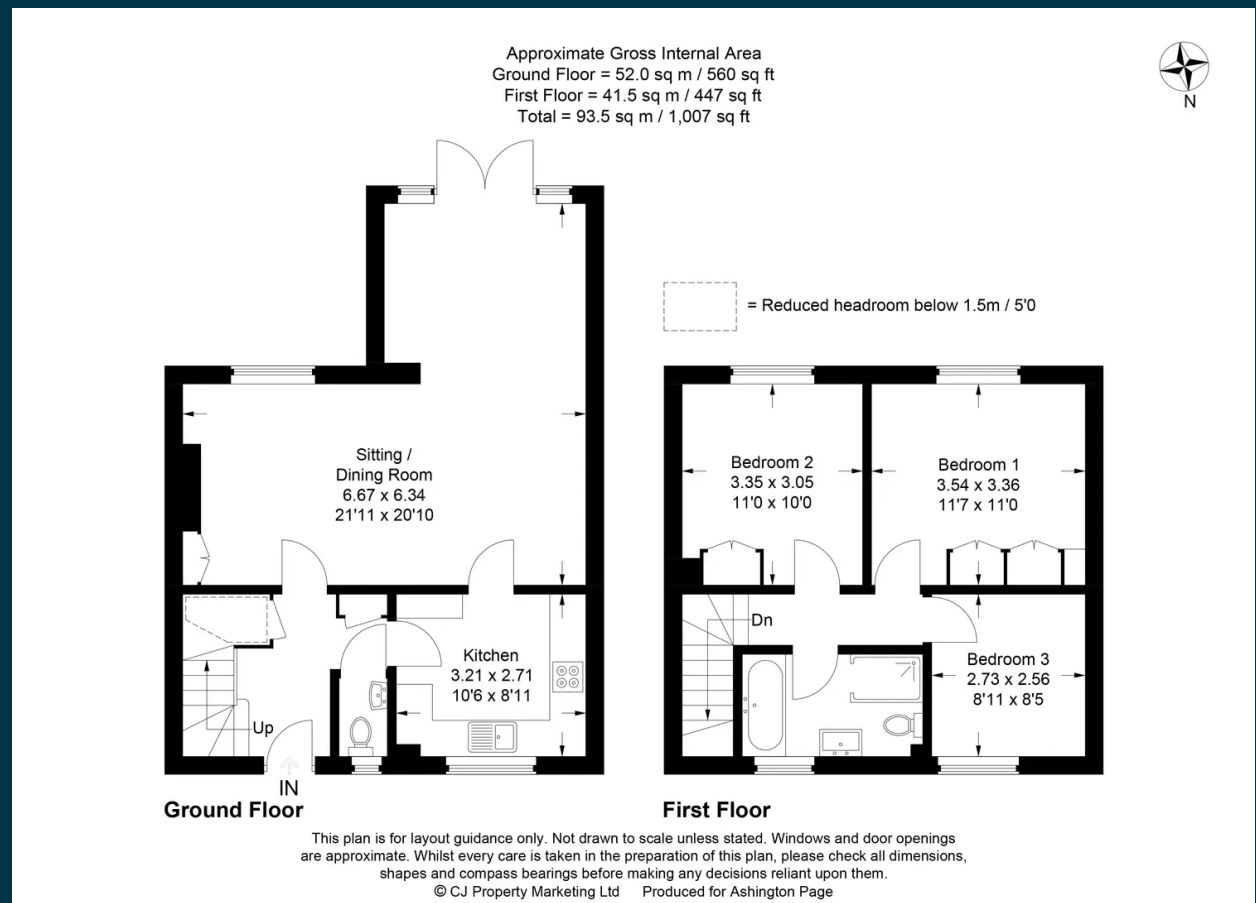

01494 680018  
 info@ashingtonpage.co.uk  
 www.AshingtonPage.co.uk

