



## 3 Bedroom Semi-Detached House

52 Cherry Tree Road, Cricklade, Swindon, SN6 6ES

Asking Price Of £315,000

**mcfarlane**  
property.com



## 3 Bedroom Semi-Detached Cricklade

- SPACIOUS FAMILY HOME
- LARGE CORNER PLOT
- EXTENDED ACCOMMODATION

- EXTENDED SEMI DETACHED FAMILY HOME -  
LARGE CORNER PLOT - SPACIOUS LIVING  
ACCOMMODATION - REFITTED  
KITCHEN/BREAKFAST ROOM - THREE BEDROOMS -  
MODERN BATHROOM - ENCLOSED REAR GARDEN -  
OPEN SWEEPING DRIVEWAY -

A spacious extended three bedroom family home located in a large corner plot within easy reach of all local amenities including good local schools, shops and transport facilities. The property offers versatile living accommodation to include: Entrance Hallway, Lounge, Refitted Kitchen/Breakfast Room, Cloakroom, Landing, Three bedrooms and Family Bathroom. Outside there are enclosed Rear Gardens and open sweeping Driveway to the front with Ample Parking. Viewing is highly recommended.







# We where you LIVE

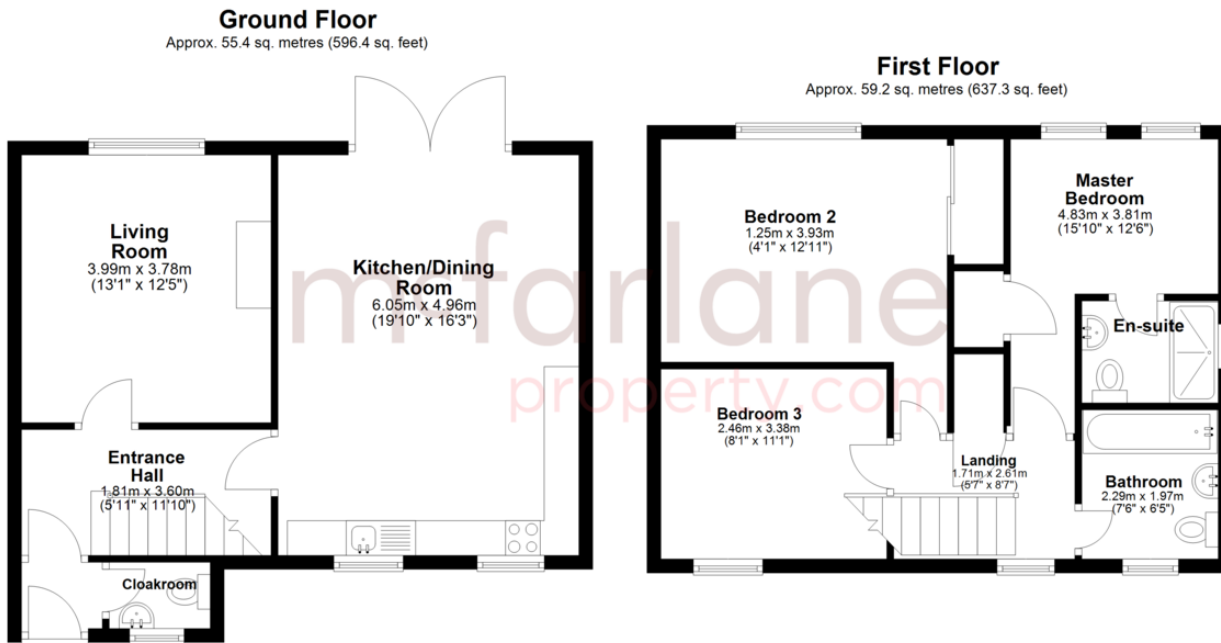

Total area: approx. 114.6 sq. metres (1233.8 sq. feet)

Our team are friendly, experienced and are all local. They know it better than they do their own living rooms and can help you find what you're looking for because **we love where we live.**

We would be delighted to show you around this property.

**Because every home needs a personal touch.**

**If you would like to view this property then please get in touch.**

📞 01793 751044

✉ cricklade@mcfarlaneproperty.com

[mcfarlaneproperty.com](http://mcfarlaneproperty.com)

**mcfarlane**  
property.com

**Cricklade.**  
102 High Street  
Cricklade SN6 6AA  
📞 01793 751044

**Marlborough.**  
106 High Street  
Marlborough SN8 1LT  
📞 01672 514380

**Old Town.**  
28-30 Wood Street  
Swindon SN1 4AB  
📞 01793 296880

**Swindon.**  
The Village Centre,  
Redhouse SN25 2FW  
📞 01793 296600

Agents Note: Whilst every care has been taken to prepare these sales particulars, they are for guidance purposes only. All measurements are approximate and are for general guidance purposes only and whilst every care has been taken to ensure their accuracy, they should not be relied upon and potential buyers are advised to recheck the measurements