



PUTTERILLS

est. 1992

2 Railway Cottages, Little Wymondley, Hertfordshire, SG4 7JP

Guide Price: £340,000

A Victorian terrace in Little Wymondley, log burner in kitchen, open fire in living room, conservatory, flexible outbuilding, landscaped gardens and parking.

Charming two-bedroom Victorian terrace in Little Wymondley featuring a cozy log burner in the kitchen and an inviting open fire in the living room. Enjoy a bright conservatory and a versatile outbuilding suitable for a utility room or study. The property boasts landscaped gardens, convenient parking, and easy access to picturesque countryside walks. Located in close proximity to Hitchin and Stevenage, this home offers a perfect blend of character and practicality.

Little Wymondley benefits from two pubs nearby and there are comprehensive shopping and recreational facilities together with excellent schooling and train stations at nearby Hitchin and Stevenage. The A1(M) is also within easy reach.







Ground Floor

Main area: approx. 44.7 sq. metres (481.5 sq. feet)
Plus outbuildings, approx. 10.3 sq. metres (110.6 sq. feet)

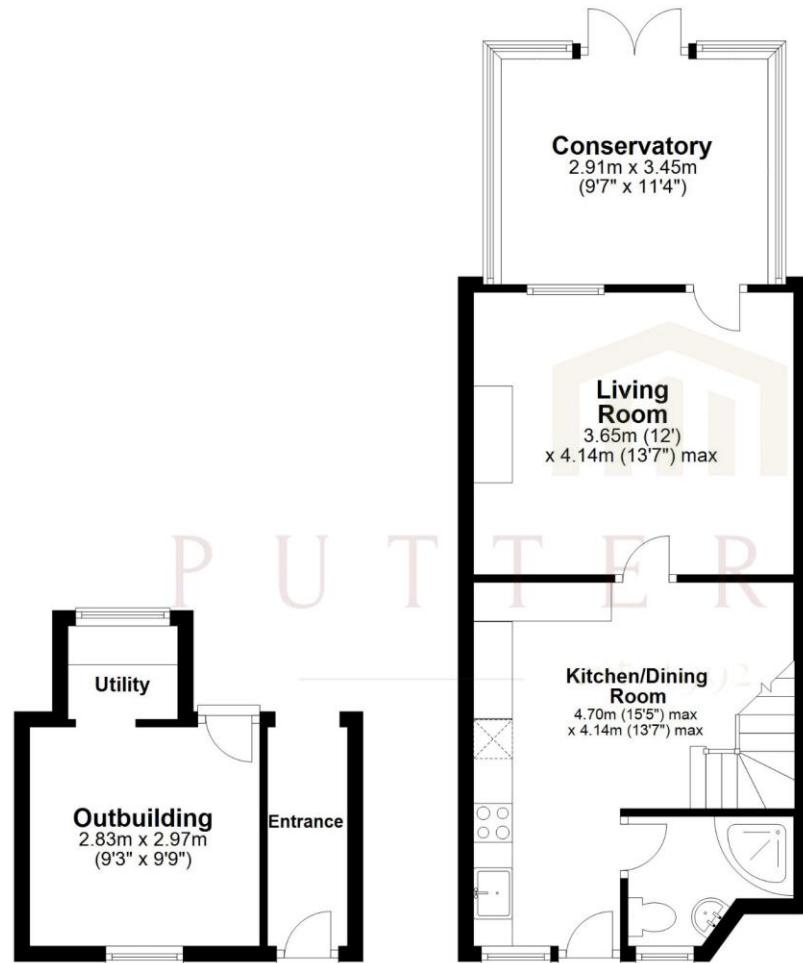

First Floor

Approx. 27.0 sq. metres (290.4 sq. feet)

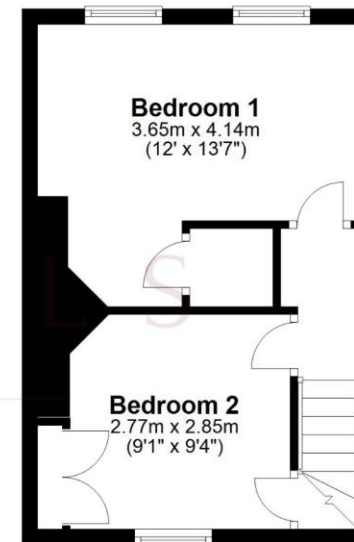

Main area: Approx. 71.7 sq. metres (771.9 sq. feet)

Plus outbuildings, approx. 10.3 sq. metres (110.6 sq. feet)

Floor Plan measurements are approximate & for illustrative purposes only. While we do not doubt the floor plans accuracy, we make no guarantee, warranty or representation as to the accuracy and completeness of the floor plan.
Plan produced using PlanUp.