



Stott Gardens, Cambridge

+44 (0) 1223 508050

[lettings@cookecurtis.co.uk](mailto:lettings@cookecurtis.co.uk)

[www.cookecurtis.co.uk](http://www.cookecurtis.co.uk)

A end of terrace, smartly presented two bedroom house located just off Milton Road allowing easy access to the city centre, the Cambridge Science Park and Cambridge North station.

£1,600pcm

Stott Gardens, CB4 1FJ



This two-bedroom home on Stott Gardens offers great, recently refurbished and spacious accommodation with a large living area and two double bedrooms. The property has a spacious outdoor space in the rear garden, including side gate access and outdoor storage. Gas central heating is present throughout and the property benefits from its recent refurbishment.

The property comprises of an entrance hall with a separate door, a spacious living room and a modern kitchen complete with a partial range of white goods including fridge, freezer, oven and hob. This then leads to the back door into the garden which is accessible by the side gate and features outdoor storage.



Upstairs there are two bedrooms, both doubles. The main bathroom comes with a full suite of bath with a shower over, wash basin and WC along with a mirror, storage cabinet and towel rail.

Parking is residents only off street. Available now. Video tour available.







58sqm / 629sqft

---

2 bed, 1 bath, 1 recep

---

EPC – C / 70

---

Council tax band - C

---

Gas central heating

---

Off road parking

---

Recently refurbished

---

Available Immediately

---



### Ground Floor

Approx. 29.9 sq. metres (321.9 sq. feet)

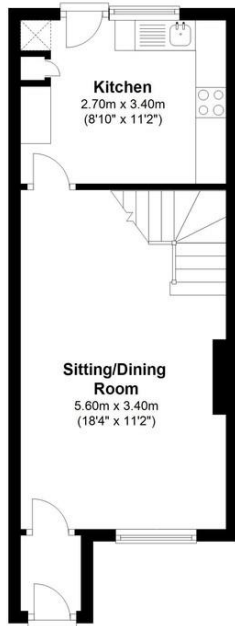

### First Floor

Approx. 28.6 sq. metres (307.4 sq. feet)

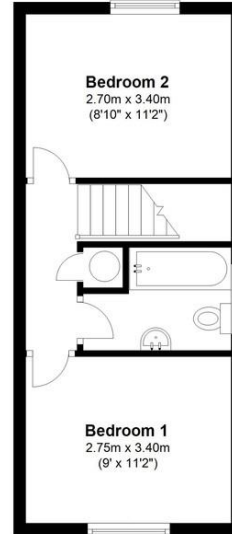

Total area: approx. 58.5 sq. metres (629.3 sq. feet)

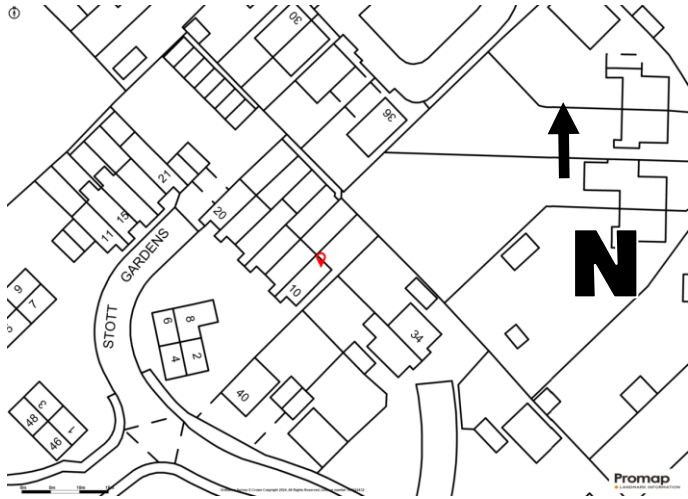

Stott Gardens is in the north side of the city, just off Milton Road. Nearby there are several shops including a Co-Op, butchers, and a local greengrocer, as well as restaurants and public houses. Just a 15-minute walk or a brisk 5-minute cycle will take you to Cambridge Regional College and the Science Park. Both the City Centre and Cambridge North station are a short 10-minute cycle away. There is access out to both the A14 and M11, as well as local attractions such as Milton Country Park nearby.

COOKE  
CURTIS  
& CO