

£150,000

Newgate Street, Doddington, Cambridgeshire PE15 0SR



To arrange a viewing call us now on 01354 694900

Simply STUNNING, this well proportioned one bedroom mid terrace cottage is BEAUTIFULLY PRESENTED throughout and has been truly loved by our seller.

The accommodation comprises living room, kitchen/diner, bedroom and bathroom.

There is a good size garden to the rear and a modern electrical heating system in place.

Energy rating C

Ground Floor

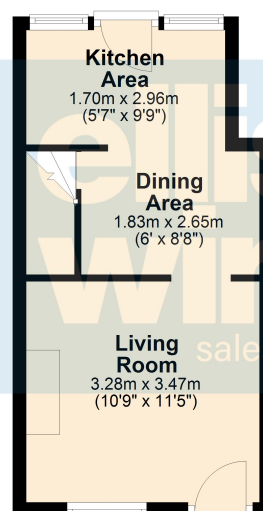

First Floor

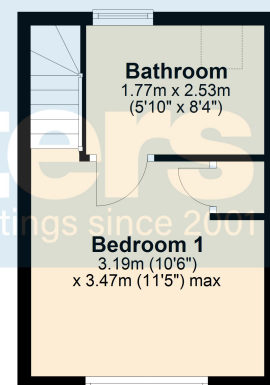

£150,000

Newgate Street, Doddington, Cambridgeshire PE15 0SR



GROUND FLOOR

LIVING ROOM

3.47m (11'5") x 3.28m (10'9")

Window to front, feature fireplace (which has potential for a wood burner) with over mantle, wall lights.

DINING AREA

2.65m (8'8") x 1.83m (6')

Wall units with breakfast bar under, stairs leading to first floor.

KITCHEN AREA

2.96m (9'9") x 1.70m (5'7")

Wall and base units complete with freestanding electric cooker, space for fridge/freezer, single sink and drainer, plumbing for washing machine, windows to rear and door out to garden.



FIRST FLOOR

BEDROOM 1

3.47m (11'5") max. x 3.19m (10'6")

Window to front, airing cupboard, access into loft space.



BATHROOM

2.53m (8'4") x 1.77m (5'10")

Fitted with a panelled bath which has mixer tap shower, low level WC and hand wash basin. Window to rear and Velux.



OUTSIDE

The rear garden is laid mainly to lawn with flower borders, gravel patio areas and storage shed.

SERVICES

Mains electricity, water and drainage. The property has modern electric heating.

TENURE

Freehold

Fenland District Council tax band A

Energy rating E



Ellis Winters & Co 20 Market Hill, Chatteris, Cambridgeshire, PE16 6BA

Tel: 01354 694900 Email: info@elliswinters.co.uk www.elliswinters.co.uk

Ellis Winters has not tested any apparatus, equipment fitting or services and so cannot verify that they are in working order. The buyer is advised to obtain verification from their solicitor or surveyor. Floor plans are for representational purposes only and are not to scale.