

RIPPON | 2 BEDROOM HOUSE | 65m²

- 2 bedrooms
- Kitchen/dining room
- Both bedrooms with en-suite
- Downstairs cloakroom
- Two parking spaces
- Lawned garden

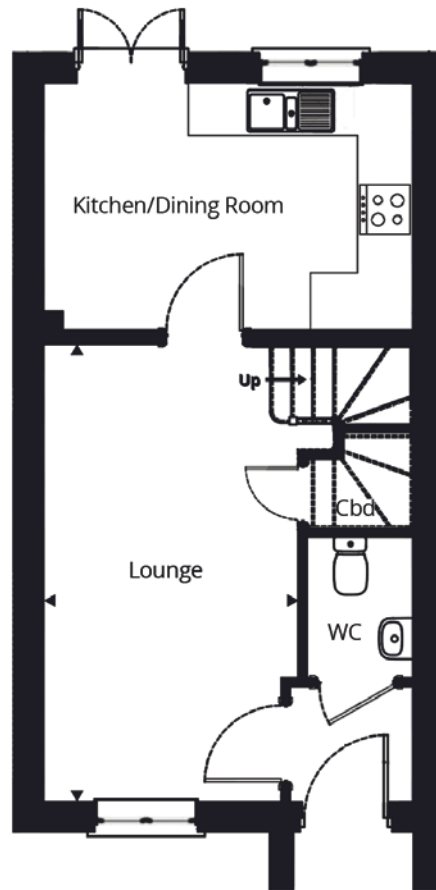

A two bedroom house comprising a lounge, downstairs cloakroom and kitchen/dining room with double doors leading into the garden. Stairs up to the first floor lead you to the two bedrooms both with the benefit of an en-suite bathroom.



GROUND FLOOR

KITCHEN/DINING ROOM	LOUNGE
4 x 2.7m (13'3" x 8'11")	2.7 x 5m (9'2" x 16'6")

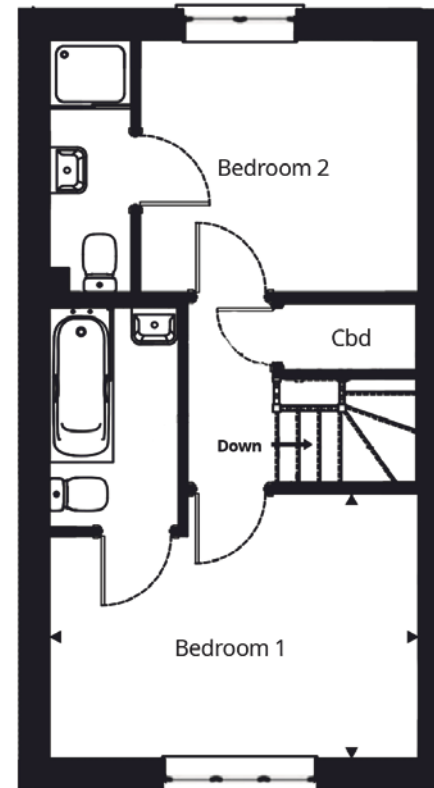

FIRST FLOOR

BEDROOM 1	BEDROOM 2
4.1 x 2.9 (13'3" x 9'6")	3.1 x 2.8m (10'0" x 9'1")

The information provided is for guidance only. It is not part of a contract or offer. All dimensions are subject to construction tolerances and images vary between plots. Windows, external finishes and landscaping may vary. It is important that purchasers ensure that they are happy with the details of their plot with the Sales Advisor. Boundary treatments altered for artistic effects. All information is correct at time of print but is subject to change.