



6 Shortacres, Nutfield

Guide Price £475,000



6 Shortacres

A stunning two bedroom mid-terraced house located in the desirable village of Nutfield. Built by Msrs. Berkeley Homes, 'Shortacres' is an exclusive and private development consisting of just fourteen homes situated in a quiet cul-de-sac with picturesque woodland to the rear. This property offers a tranquil and idyllic living environment.

The interior of the house boasts two spacious double bedrooms, including a master bedroom with an en-suite bathroom. The ground floor features a generously sized lounge, a well-equipped kitchen diner, and a delightful conservatory, providing ample space for both relaxation and entertainment.

Additionally, there is a convenient cloakroom/wc for guests.

With a garage and allocated parking, residents will never have to worry about finding parking space for their vehicles.

Moving outside, the property features a lovely private rear garden, perfect for outdoor activities and gatherings. In addition to the private garden, residents of 'Shortacres' also have access to large communal gardens, providing a beautiful shared space for relaxation and socialising. Whether enjoying a peaceful morning coffee or hosting a barbeque with friends and family, the outside space of this property offers endless possibilities.

Situated in Nutfield Village, approximately two miles east of Redhill town centre, this home benefits from its convenient location. Commuters will find London Gatwick Airport less than eight miles away, and with easy access to the M25 and M23 motorway networks, travelling around the area and beyond is effortless. Nutfield also has its own railway station at South Nutfield, with quick connections to Redhill, then onwards to London Bridge and London Victoria, making this property an ideal choice for those who need to commute to the city.





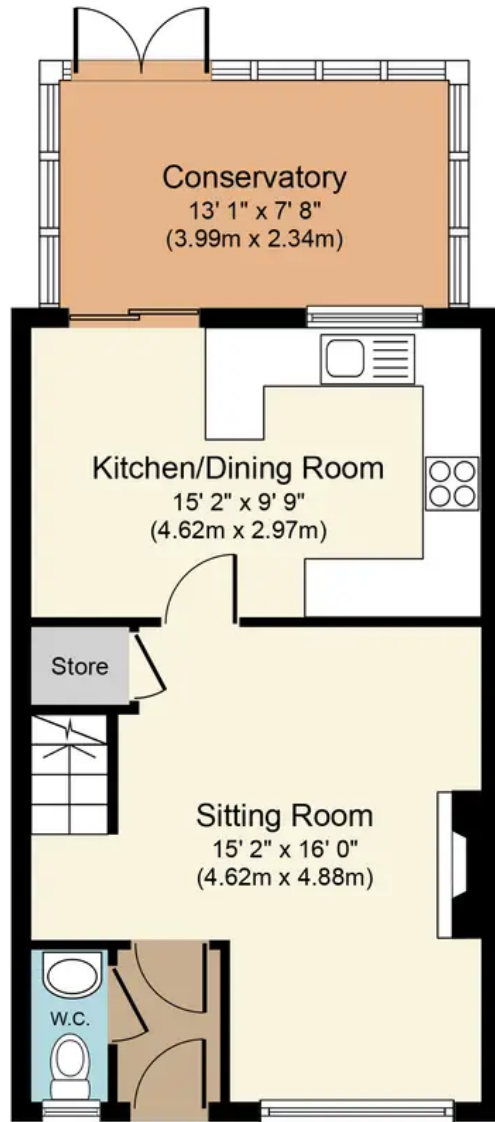

Ground Floor
Approximate Floor Area
517 sq. ft.
(48.0 sq. m.)

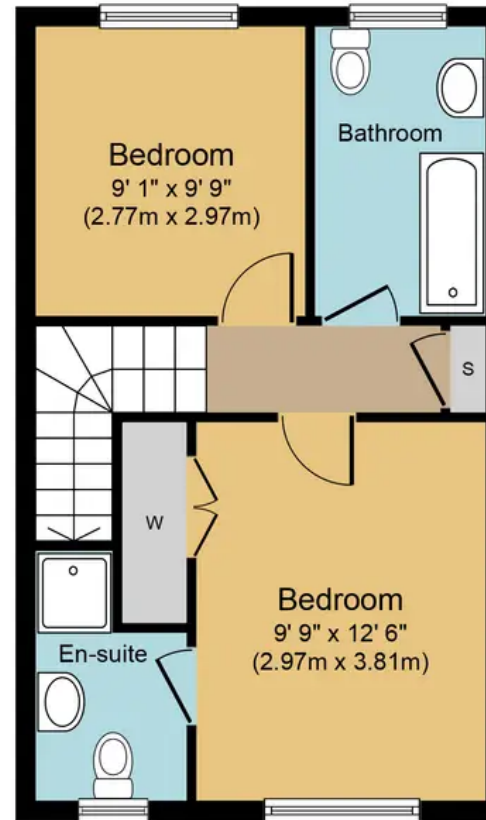

First Floor
Approximate Floor Area
398 sq. ft.
(37.0 sq. m.)



Shortacres, RH1

Approx. Gross Internal Floor Area 915 sq. ft. (85.0 sq. m.)



Whilst every attempt has been made to ensure the accuracy of the floor plan contained here, measurements of doors, windows, rooms and any other items are approximate and no responsibility is taken for any error, omission, or mis-statement. The measurements should not be relied upon for valuation, transaction and/or funding purposes. This plan is for illustrative purposes only and should be used as such by any prospective purchaser or tenant. The services, systems and appliances shown have not been tested and no guarantee as to their operability or efficiency can be given.