

Crucible Homes



Bethel Road, Eastwood,
Rotherham, S65 1QU

Asking Price Of
£100,000



Overview

FREEHOLD

Council tax band A

Two bedrooms

Gas central heating and double glazing

Great investment opportunity

Viewing by appointment only



Description

****ATTENTION INVESTORS**** Offered to the market with vacant possession or a sitting tenant is this two bedroom mid terraced property. In our opinion the property would be ideal for the investor and lies within easy reach of Rotherham Town Centre and local amenities. The living accommodation comprises of a living room. kitchen/diner, two bedrooms and bathroom. Outside to the rear of the property is the yard. The property is within easy access to lots of local amenities, public transport and motorway links.



Score	Energy rating	Current	Potential
92+	A		
81-91	B		
69-80	C		75 C
55-68	D		
39-54	E	48 E	
21-38	F		
1-20	G		

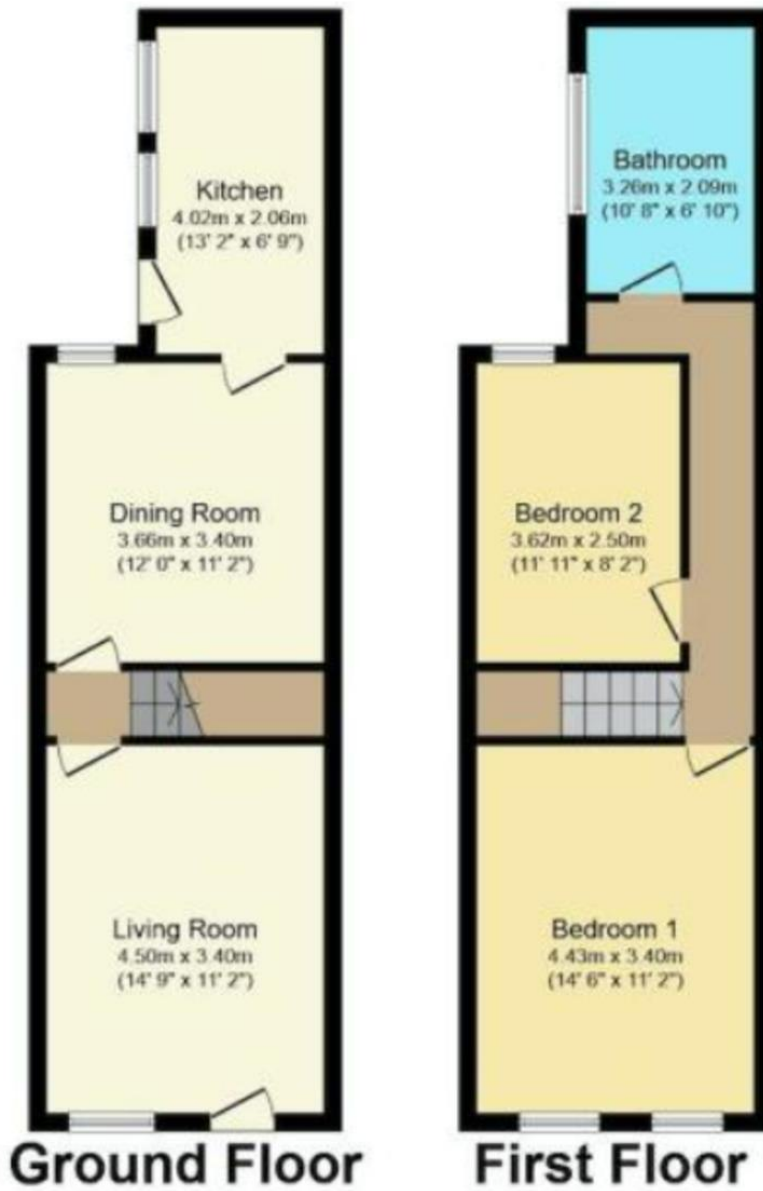

PRS
Property Redress Scheme



[onTheMarket.com](#)

[rightmove](#)
find your happy

[Zoopla.co.uk](#)
Smarter property search



Find us on Facebook **Crucible Sales & Lettings**



Follow us on Twitter **@cruciblesalelet**



Find us on Instagram **cruciblesalelet**