



One Bedroom Semi-Detached House

Rogers Meadow, Marlborough

Asking price of £215,000

mcfarlane
property.com

Rogers Meadow Marlborough

- ◆ Ideal property for first time buyers/investors
- ◆ Benefits from two parking spaces
- ◆ Good sized south facing garden

For sale with no onward chain, this cosy one-bedroom house in Marlborough is the perfect home for the first-time buyer or an investor, and benefits from a lovely secluded south facing rear garden.

This semi-detached home has a wonderful, homely feel from the moment you enter into the entrance porch. The downstairs accommodation comprises of open plan living room and kitchen. There is a useful storage cupboard under the stairs.

Upstairs you will find one double bedroom with a large built-in double wardrobe and the bathroom with bath and shower over.

At the rear and side of the property is a pretty garden. This secluded part walled garden is south facing and has been designed with lawn and stocked beds with flowers, shrubs and trees. This great home also benefits from a two parking spaces.



We 
where you
LIVE

Ground Floor

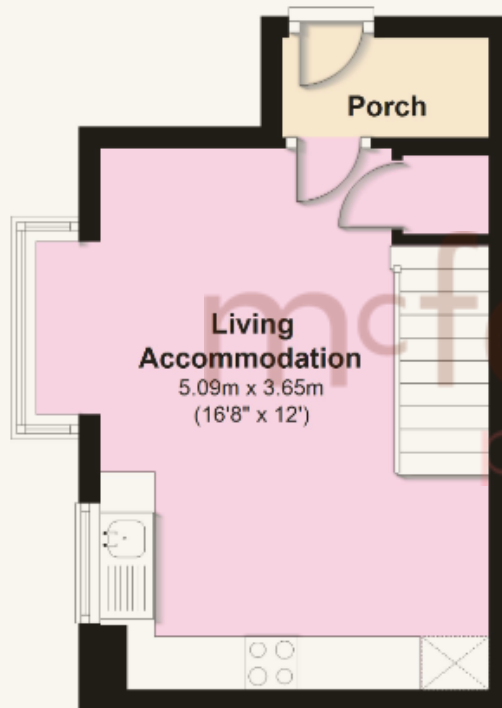

First Floor

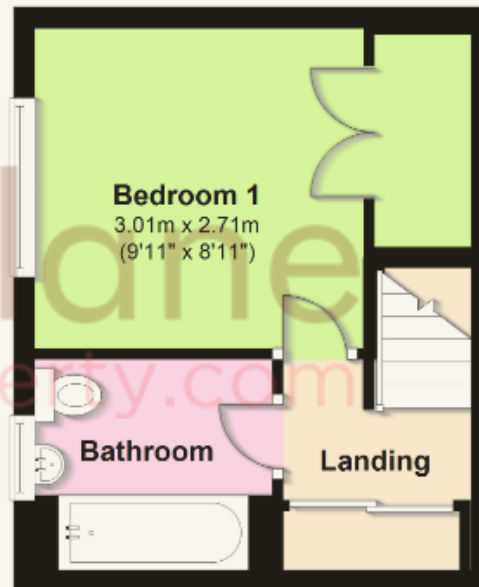

Our team are friendly, experienced and are all local. They know it better than they do their own living rooms and can help you find what you're looking for because **we love where we live.**

We would be delighted to show you around this property.

Because every home needs a personal touch.

If you would like to view this property then please get in touch.

☎ 01672 514380

✉ marlborough@mcfarlaneproperty.com

mcfarlaneproperty.com

mcfarlane
property.com

Cricklade.
102 High Street
Cricklade SN6 6AA
☎ 01793 751044

Marlborough.
106 High Street
Marlborough SN8 1LT
☎ 01672 514380

Old Town.
28-30 Wood Street
Swindon SN1 4AB
☎ 01793 296880

Swindon.
The Village Centre,
Redhouse SN25 2FW
☎ 01793 296600

Agents Note: Whilst every care has been taken to prepare these sales particulars, they are for guidance purposes only. All measurements are approximate are for general guidance purposes only and whilst every care has been taken to ensure their accuracy, they should not be relied upon and potential buyers are advised to recheck the measurements