

# Maryla Lodge NW4

Total Area: 871 ft² ... 80.9 m²

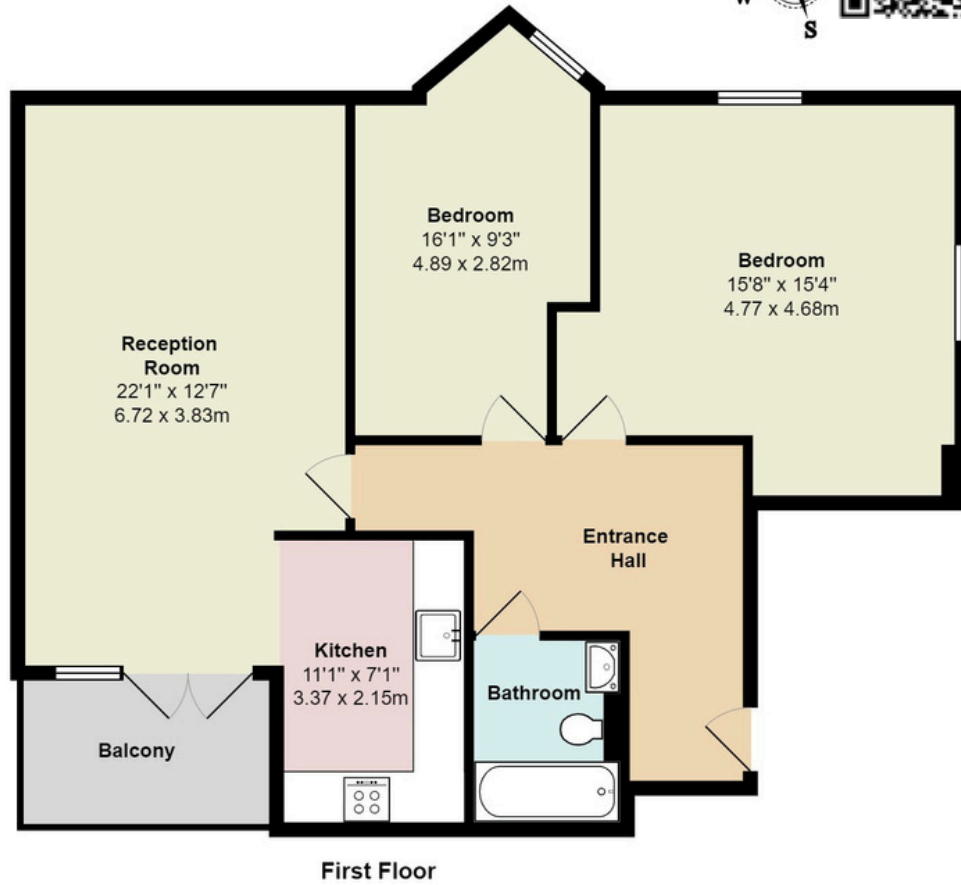

All measurements are approximate and for display purposes only



Tenure Leasehold



871 sqft / 80.9 m2



2 Bedrooms



1 Bathrooms



Street Parking

Score	Energy rating	Current	Potential
92+	A		
81-91	B	84 B	84 B
69-80	C		
55-68	D		
39-54	E		
21-38	F		
1-20	G		

## Maryla Lodge, London, NW4

£425,000

Maryla Lodge is a brand new development of apartments situated on a quiet street just off Remais Road and within walking distance of Hendon Central Station. The property boasts a tranquil location away from the bustling streets, offering residents added comfort and peace.

The 871 square foot two-bedroom apartment features a spacious open-plan kitchen/living room with a charming farmhouse-style design. The kitchen comes equipped with elegant splashback tiling, integrated appliances, and a gas hob, and it opens onto a delightful private terrace, perfect for entertaining guests.

The main bedroom is generously sized with an additional bedroom. The modern four-piece family bathroom features mosaic-style flooring for a contemporary touch.

Additional amenities include gas central heating, convenient bike storage, and the option for off-street parking (extra charge by negotiation). The apartments also offer plentiful storage solutions to keep belongings organized and clutter-free.

Tenure: Leasehold.

Leasehold

Brand new 150 year lease

Service Charge - £1644.11 per annum (13% allocation)

903-905 Finchley Road Golders Green London NW11 7PE

Telephone 020 8381 4970 Email [info@moreland.uk.com](mailto:info@moreland.uk.com)

Registered Office Unit 8, Alpha Business Park, Travellers Close, Welham Green AL9 7NT Registered in England No. 3663497 Vat No. 701775936

Residential Sales Lettings Full Management Financial Services New Homes



