

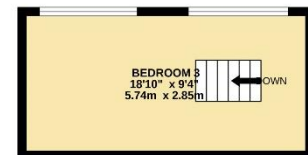

13 Main Street | North Anston | Sheffield | S25 4BD Guide Price £300,000 to £325,000

Bell & Co Estates are delighted to present this THREE BEDROOM, DETACHED property in the popular village of North Anston selling with no chain. With properties like this not coming to market very often, call now to avoid disappointment. Briefly comprising of large airy entrance Hallway with storage cupboard and Downstairs W/C, STUNNING open plan Living Room with OPEN FIRE, Dining area with CONSERVATORY to the rear which allows a lot of natural light and Family Kitchen with integrated appliances and spectacular views! To the first floor are THREE LARGE DOUBLE BEDROOMS and family Bathroom complete with corner bath and separate shower cubicle. To the rear of the property is a Detached Garage, large driveway and tranquil garden. Behind the garage is an ANNEX which houses a living area complete with LOG BURNER, spiral staircase and bedroom with WALK IN WARDROBE. Within very close proximity to all local amenities and schools, this property would make the perfect family home!

- DETACHED PROPERTY
- Spectacular Views!
- Spacious Throughout
- Kitchen with Appliances
- Large Lounge / Diner with Open GAS FIRE
- Three Double Bedrooms
- SEPARATE ANNEX!!!!!!

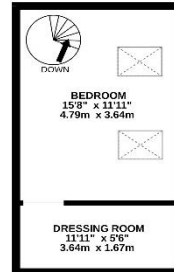
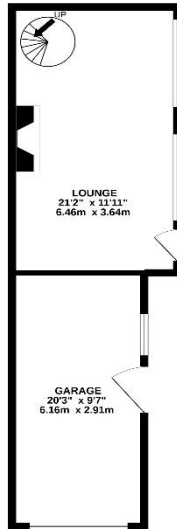

Contact Details

79 Wales Road
Kiveton Park
Sheffield
South Yorkshire
S26 6RA

www.bellcoestates.com

03333 580590

13, Main Street
North Anston
SHEFFIELD
S25 4BD

Energy rating

E

Valid until
18 January 2028

Certificate number
9788-1096-7289-5358-8970

Property type Semi-detached house

Total floor area 136 square metres

Agents Note: Whilst every care has been taken to prepare these sales particulars, they are for guidance purposes only. All measurements are approximate and for general guidance purposes only and whilst every care has been taken to ensure their accuracy, they should not be relied upon and potential buyers are advised to recheck the measurements