



2 Bedroom Cottage

High Street, Cricklade, Wiltshire, SN6 6AP

Asking Price Of £225,000

mcfarlane
property.com

2 Bedroom Cottage

Cricklade, Wilts

-
- SUPERB TWO BEDROOM TERRACED COTTAGE
 - IDEAL FIRST PURCHASE OR INVESTMENT
 - WALKING DISTANCE TO ALL AMENITIES
-

- TWO DOUBLE BEDROOM TERRACED COTTAGE - IDEAL INVESTMENT OR FIRST PURCHASE - WALKING DISTANCE TO LOCAL AMENITIES - CHARMING ORIGINAL CHARACTER - GARDENS - NO ONWARD CHAIN -

A charming terraced two double bedroom cottage located in the High Street Cricklade, within easy reach of all local amenities. The accommodation comprises: Entrance, Hallway, Sitting Room, Fitted Kitchen/Dining Room with rear aspect, Ground Floor Bathroom, Landing and Two Double Bedrooms. Additionally there is Gas Central Heating and Double Glazing. Outside there are attractive enclosed rear Gardens. No Onward Chain.



Call to View

McFarlane Sales & Lettings
High Street
Cricklade
Wiltshire
SN6 6AY

01793 751 044

mcfarlane
property.com



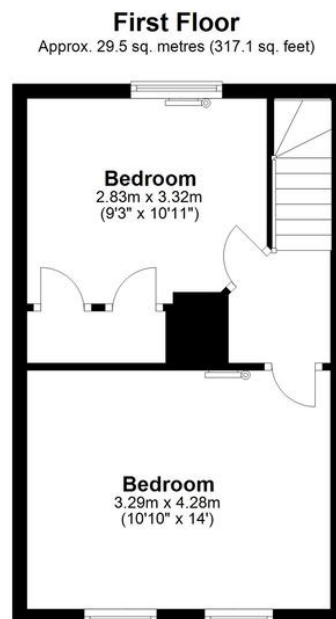
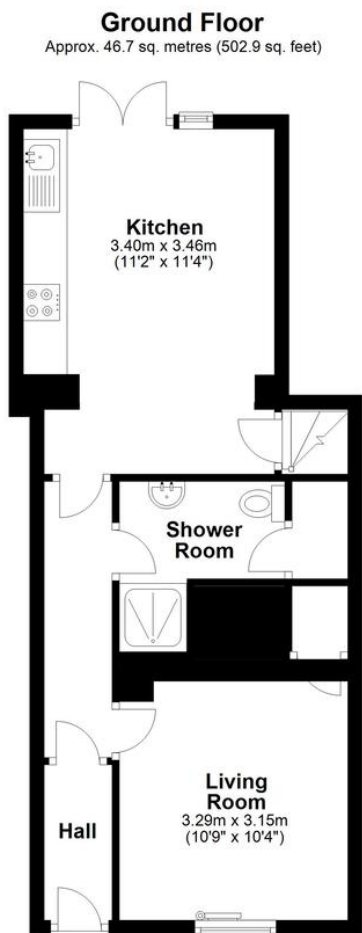

Total area: approx. 76.2 sq. metres (820.0 sq. feet)

We 
where you
LIVE

Our team are friendly, experienced and are all local. They know it better than they do their own living rooms and can help you find what you're looking for because **we love where we live.**

We would be delighted to show you around this property.

**Because every home
needs a personal touch.**

**If you would like to view this
property then please get in touch.**

 01793 751044

 cricklade@mcfarlaneproperty.com

mcfarlaneproperty.com

mcfarlane
property.com

Cricklade.
102 High Street
Cricklade SN6 6AA
 01793 751044

Marlborough.
106 High Street
Marlborough SN8 1LT
 01672 514380

Old Town.
28-30 Wood Street
Swindon SN1 4AB
 01793 296880

Swindon.
The Village Centre,
Redhouse SN25 2FW
 01793 296600

Agents Note: Whilst every care has been taken to prepare these sales particulars, they are for guidance purposes only. All measurements are approximate are for general guidance purposes only and whilst every care has been taken to ensure their accuracy, they should not be relied upon and potential buyers are advised to recheck the measurements