





Introducing this charming 4-bedroom semi-detached house with a garden annex, perfect for modern living. The ground floor comprises a cosy living room, a versatile bedroom, a spacious dining room, a well-equipped kitchen, and a convenient downstairs w/c. On the first floor there are three additional bedrooms and a family bathroom, providing ample space for the whole family. Outside, the garden boasts a separate annex with electricity, offering endless possibilities for use such as an office or a gym. Parking for one car is available at the front of the property, ensuring convenience. With the potential to extend into the loft (STTP), this home presents an exciting opportunity for future expansion. Previous submissions for loft extension further highlight the feasibility of this option, making this property an enticing prospect for those seeking both comfort and potential.

4-bedroom semi-detached house with a garden annex

Parking for one car at the front

Potential loft extension opportunity

Garden features a separate annex with electricity

Highly Recommended! Viewings Available!

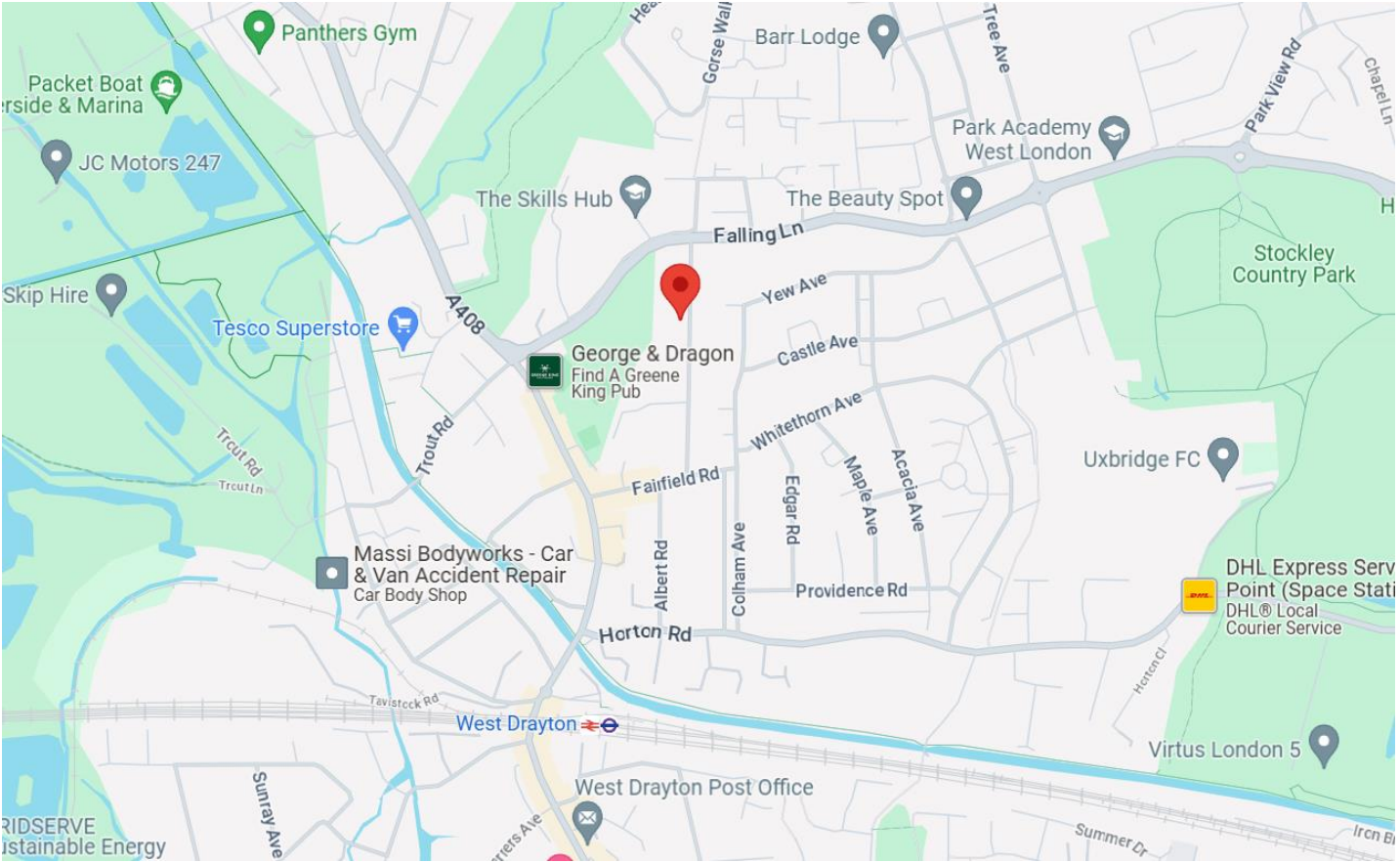

REAR ANNEX  
274 sq.ft. (25.4 sq.m.) approx.

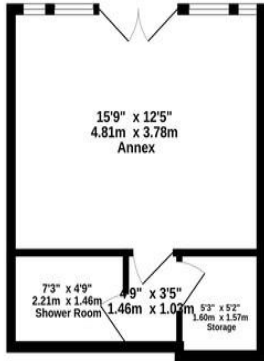

GROUND FLOOR  
593 sq.ft. (55.1 sq.m.) approx.

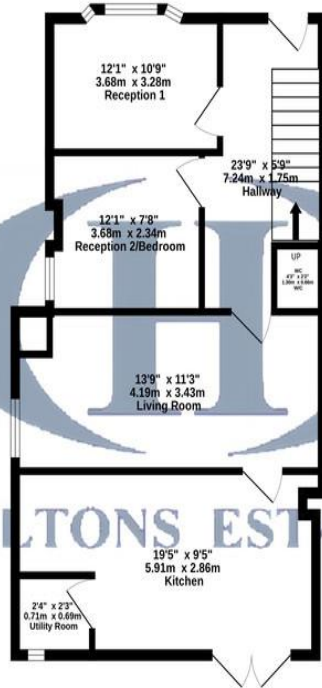

1ST FLOOR  
482 sq.ft. (44.8 sq.m.) approx.

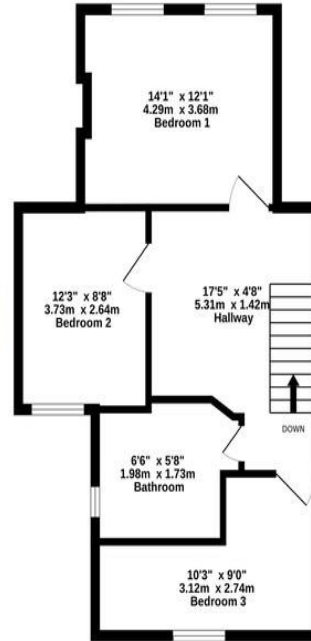

TOTAL FLOOR AREA: 1349 sq.ft. (125.3 sq.m.) approx.

Whilst every attempt has been made to ensure the accuracy of the floorplan contained here, measurements of doors, windows, rooms and any other items are approximate and no responsibility is taken for any error, omission or mis-statement. This plan is for illustrative purposes only and should be used as such by any prospective purchaser. The services, systems and appliances shown have not been tested and no guarantee as to their operability or efficiency can be given.  
Made with Metropix ©2024

