

25
YEARS

SERVING
BEACONSFIELD
SINCE 1998



3 Wynnswick Road, Seer Green

In Excess of £525,000

Ashington Page

NO CHAIN! Nestled in a serene setting, this delightful cottage offers a blend of rustic charm and modern comforts. The feature stable front door welcomes you into the property and the delightful living room with bespoke alcove shelves and boasting wooden floors throughout, this space exudes warmth and cosiness. Wooden blinds complement the wood burning stove nestled within the fireplace

Freehold

EPC D

Sat Nav HP9 2XW

Council Tax D

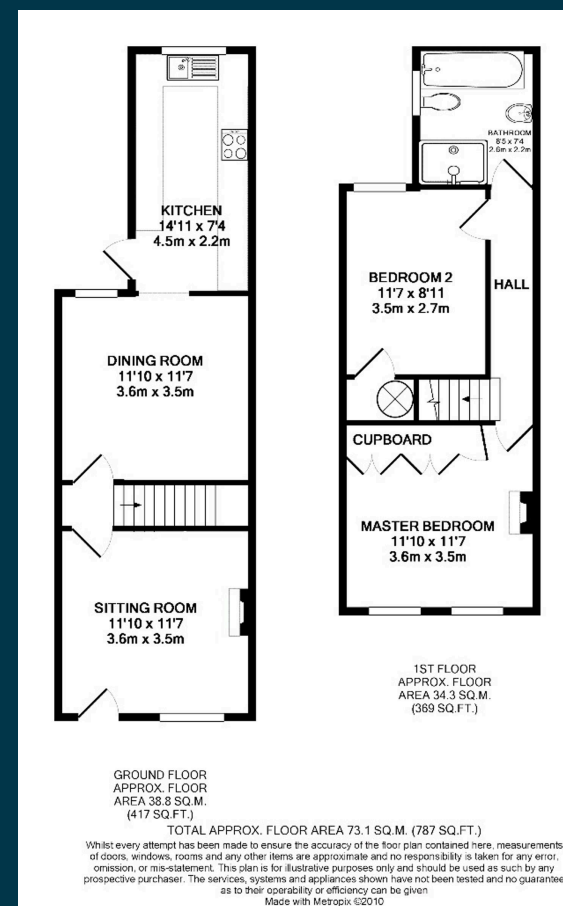

These particulars are for guidance only. They are prepared and issued in good faith and are intended to give a fair summary of the property. Any description should not be relied on as a statement or representation of fact or that the property, or its services, are in good condition. The photographs show only certain parts of the property at the time they were taken. Any areas, measurements or distance given are approximate only. Any reference to alterations to, or use of, any part of the property is not a statement that any necessary planning, building regulations or other consent has been obtained. These matters must be verified by an intending purchaser. All statements contained in these particulars in relation to the property are made without responsibility of Ashington Page or its clients. Neither Ashington Page (nor any joint agents) nor any of their employees has any authority to make or give any representation or warranty whatsoever in relation to the property

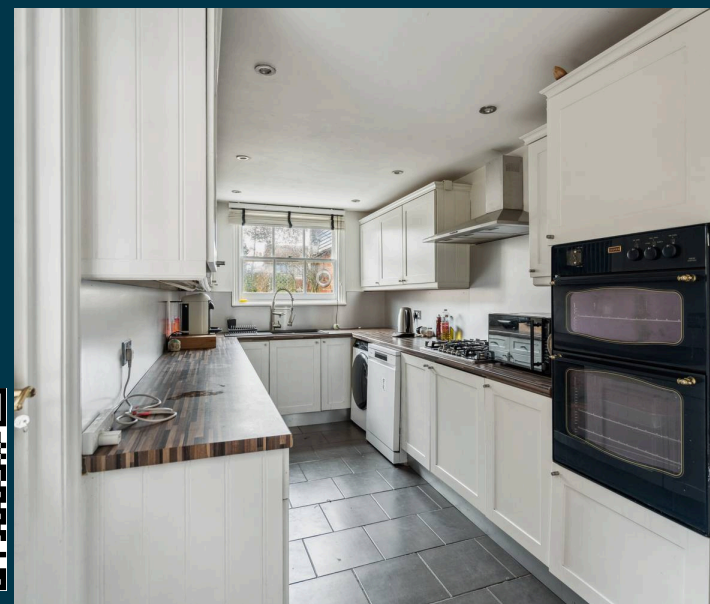

01494 680018
info@ashingtonpage.co.uk
www.AshingtonPage.co.uk



