



22 Harewood Court, 545 Limpsfield Road – CR6 9DX

Guide Price **£174,950**



22 Harewood Court

, Warlingham

A one bedroom first floor retirement flat situated in a convenient location within a short walk of Sainsbury's supermarket.

Council Tax band: D

Tenure: Leasehold

EPC Energy Efficiency Rating:

EPC Environmental Impact Rating:

- Double Bedroom with Fitted Wardrobes
- Lounge/Dining Room
- Shower Room
- Residents Lounge
- Entry Phone System
- Communal Gardens



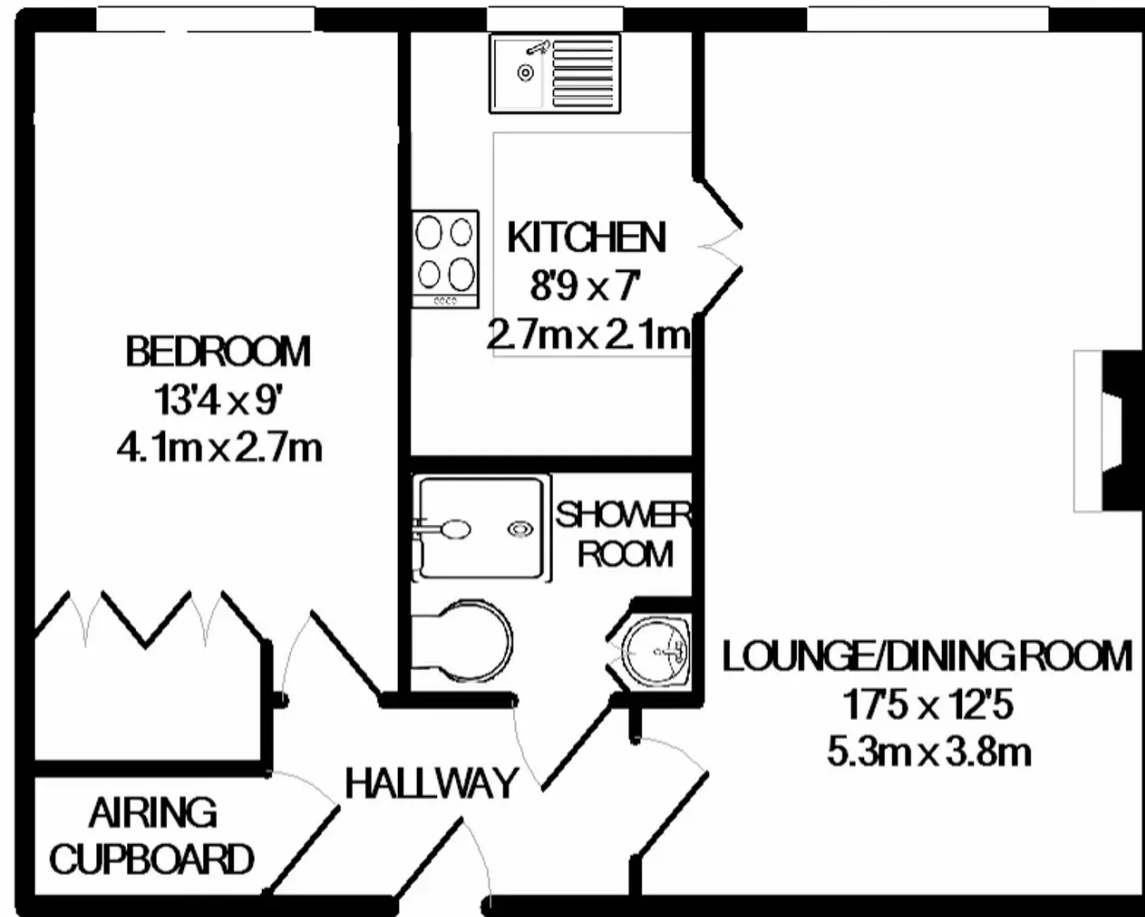

HAREWOOD COURT, LIMPSFIELD ROAD, WARLINGHAM, SURREY, CR6
TOTAL APPROX. FLOOR AREA 469 SQ.FT. (43.6 SQ.M.)

Whilst every attempt has been made to ensure the accuracy of the floor plan contained here, measurements of doors, windows, rooms and any other items are approximate and no responsibility is taken for any error, omission, or mis-statement. This plan is for illustrative purposes only and should be used as such by any prospective purchaser. The services, systems and appliances shown have not been tested and no guarantee as to their operability or efficiency can be given

Made with Metropix ©2012



Park & Bailey Warlingham

Park & Bailey, 426 Limpsfield Road - CR6 9LA

01883 626326 • warlingham@parkandbailey.co.uk • www.parkandbailey.co.uk/