



40 Rowan Terrace, Blackburn

Offers Over £118,000



40 Rowan Terrace

Blackburn, Bathgate

Well-presented 3 bed mid-terrace offering plenty of natural light. Generously proportioned lounge with open views. Low-maintenance gardens front and rear with patio area. Close to amenities and transport links. Don't miss out - arrange a viewing today!

Tenure: Freehold

- Driveway
- Open views to front
- Three good sized bedrooms
- Kitchen with appliances



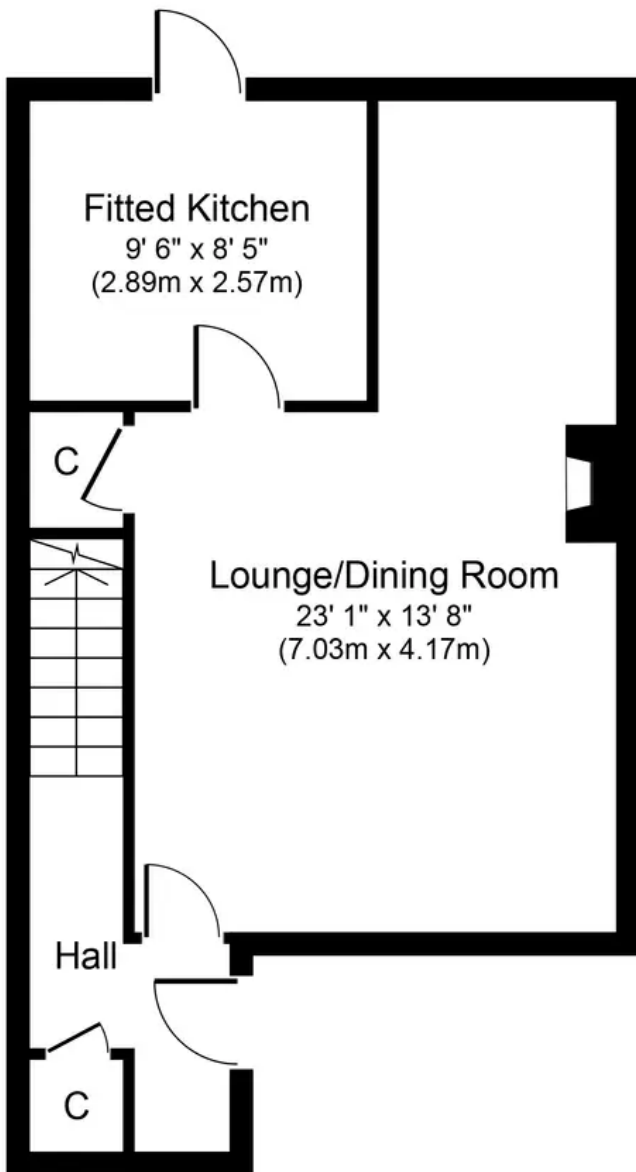

Ground Floor
Approximate Floor Area
421 sq. ft.
(39.1 sq. m.)

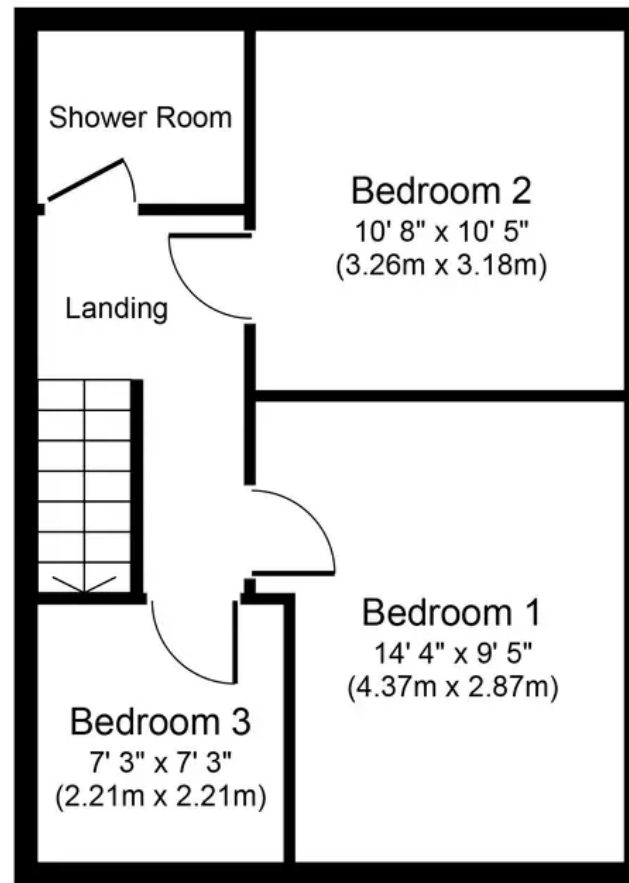

First Floor
Approximate Floor Area
386 sq. ft.
(35.9 sq. m.)

Whilst every attempt has been made to ensure the accuracy of the floor plan contained here, measurements of doors, windows, rooms and any other items are approximate and no responsibility is taken for any error, omission, or mis-statement. The measurements should not be relied upon for valuation, transaction and/or funding purposes. This plan is for illustrative purposes only and should be used as such by any prospective purchaser or tenant. The services, systems and appliances shown have not been tested and no guarantee as to their operability or efficiency can be given.



KnightBain Estate Agents

Knightbain, 4 Greendykes Road, Broxburn - EH52 5AG

01506 852000

info@knightbain.co.uk

www.knightbain.co.uk/

