



38 Springfield Avenue, Holbury – SO45 2LP

£359,950 Freehold

Three bedroom bungalow. The property features two reception rooms. Benefitting from a modern oil fuelled central heating system and double glazing throughout. The property has been extended to the rear and side, creating additional living space and enhancing the overall layout.

Outside is large rear garden, perfect for relaxing and enjoying the outdoors. Well-established plants, shrubs, and fruit trees border the hedgerows, creating a relaxing and pleasant environment. The outbuildings include a timber greenhouse, timber shed, and a further plastic storage shed.

In addition, the property offers off-road parking for several cars. There is also a garage situated at the bottom of the driveway.

GROUND FLOOR
883 sq.ft. (82.0 sq.m.) approx.

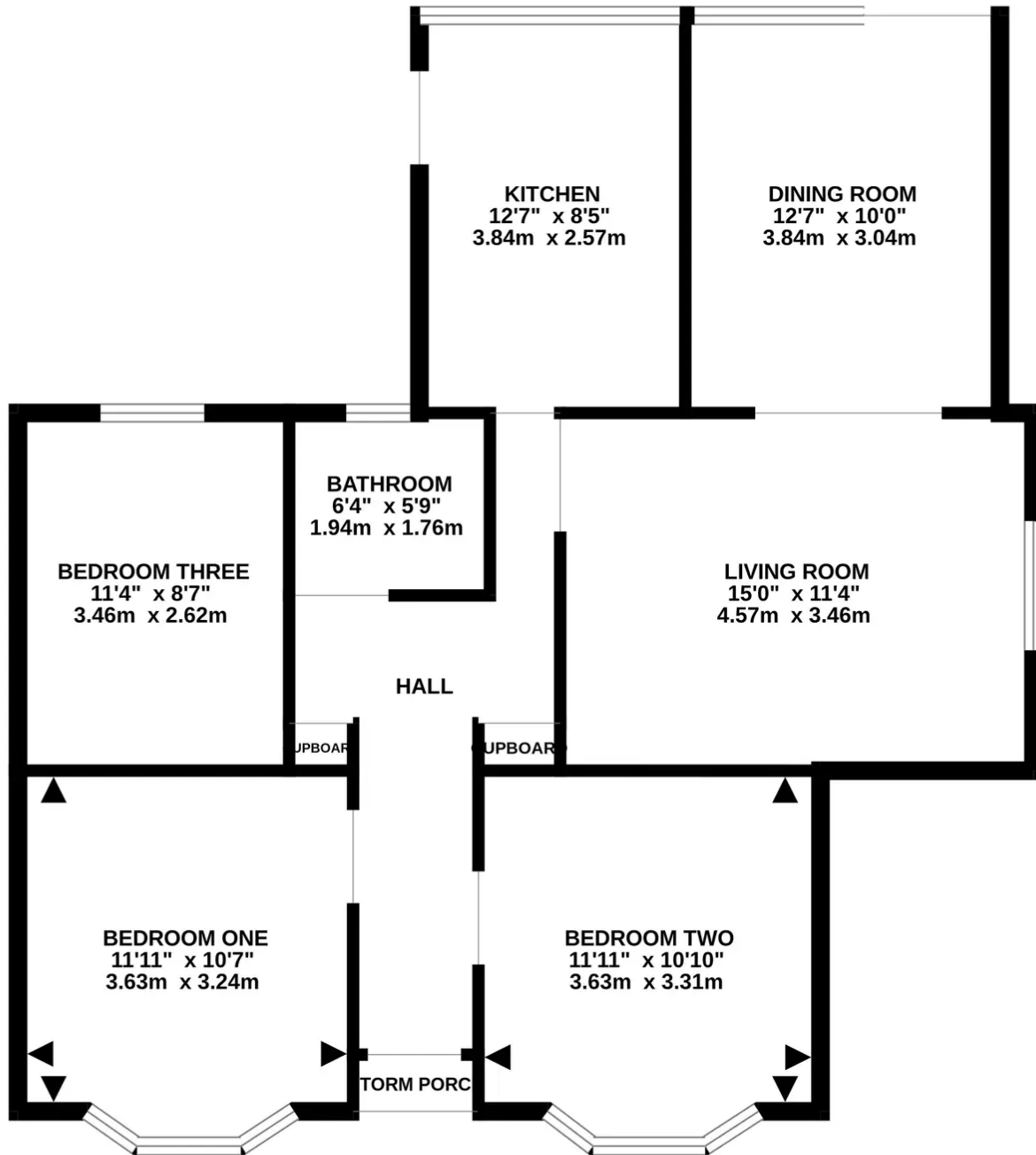

TOTAL FLOOR AREA : 883 sq.ft. (82.0 sq.m.) approx.

Whilst every attempt has been made to ensure the accuracy of the floorplan contained here, measurements of doors, windows, rooms and any other items are approximate and no responsibility is taken for any error, omission or mis-statement. This plan is for illustrative purposes only and should be used as such by any prospective purchaser. The services, systems and appliances shown have not been tested and no guarantee as to their operability or efficiency can be given.

Made with Metropix ©2024

You can include any text here. The text can be modified upon generating your brochure.



1 Southward House
Dibden Purlieu SO45 4PT



T: 02380 844405
info@anthonyjamesproperties.co.uk