

25  
YEARS

SERVING  
BEACONSFIELD  
SINCE 1998

4 Berkley Road, Beaconsfield

Guide Price £1,265,000

*Ashington Page*

A captivating family home surrounded by local woods and scenic walks. This four-bedroom residence offers an idyllic lifestyle within walking distance to shops and the station, combining the perfect blend of modern elegance and functionality.

EPC D

Freehold

Council Tax: South Bucks G

Approximate Gross Internal Area  
 Ground Floor = 109.6 sq m / 1,180 sq ft  
 First Floor = 62.8 sq m / 676 sq ft  
 Second Floor = 27.9 sq m / 300 sq ft  
 Outbuildings = 51 sq m / 549 sq ft  
 Total = 251.3 sq m / 2,705 sq ft

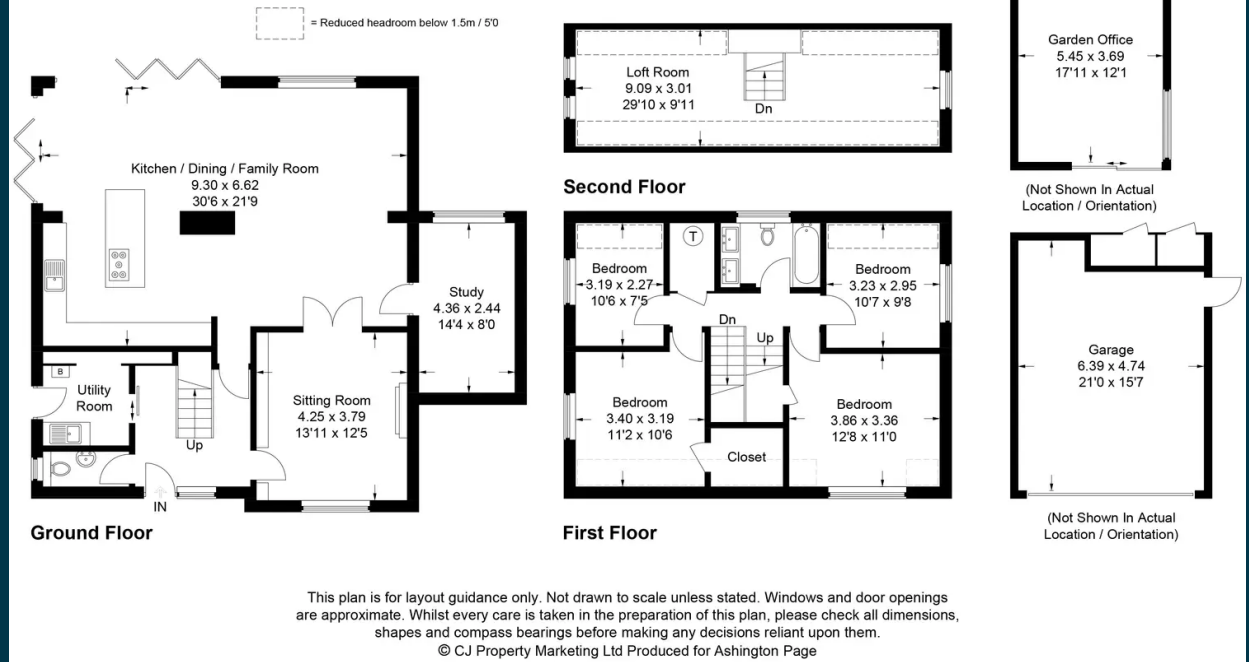

These particulars are for guidance only. They are prepared and issued in good faith and are intended to give a fair summary of the property. Any description should not be relied on as a statement or representation of fact or that the property, or its services, are in good condition. The photographs show only certain parts of the property at the time they were taken. Any areas, measurements or distance given are approximate only. Any reference to alterations to, or use of, any part of the property is not a statement that any necessary planning, building regulations or other consent has been obtained. These matters must be verified by an intending purchaser. All statements contained in these particulars in relation to the property are made without responsibility of Ashington Page or its clients. Neither Ashington Page (nor any joint agents) nor any of their employees has any authority to make or give any representation or warranty whatsoever in relation to the property



01494 680018  
 info@ashingtonpage.co.uk  
 www.AshingtonPage.co.uk

