

92+	A
81-91	B
69-80	C
55-68	D
39-54	E
21-38	F
1-20	G

37 F

87 B

This floorplan is only for illustrative purposes and is not to scale. Measurements of rooms, doors, windows, and any items are approximate and no responsibility is taken for any error, omission or mis-statement. Icons of items such as bathroom suites are representations only and may not look like the real items. Made with Made Snappy 360.

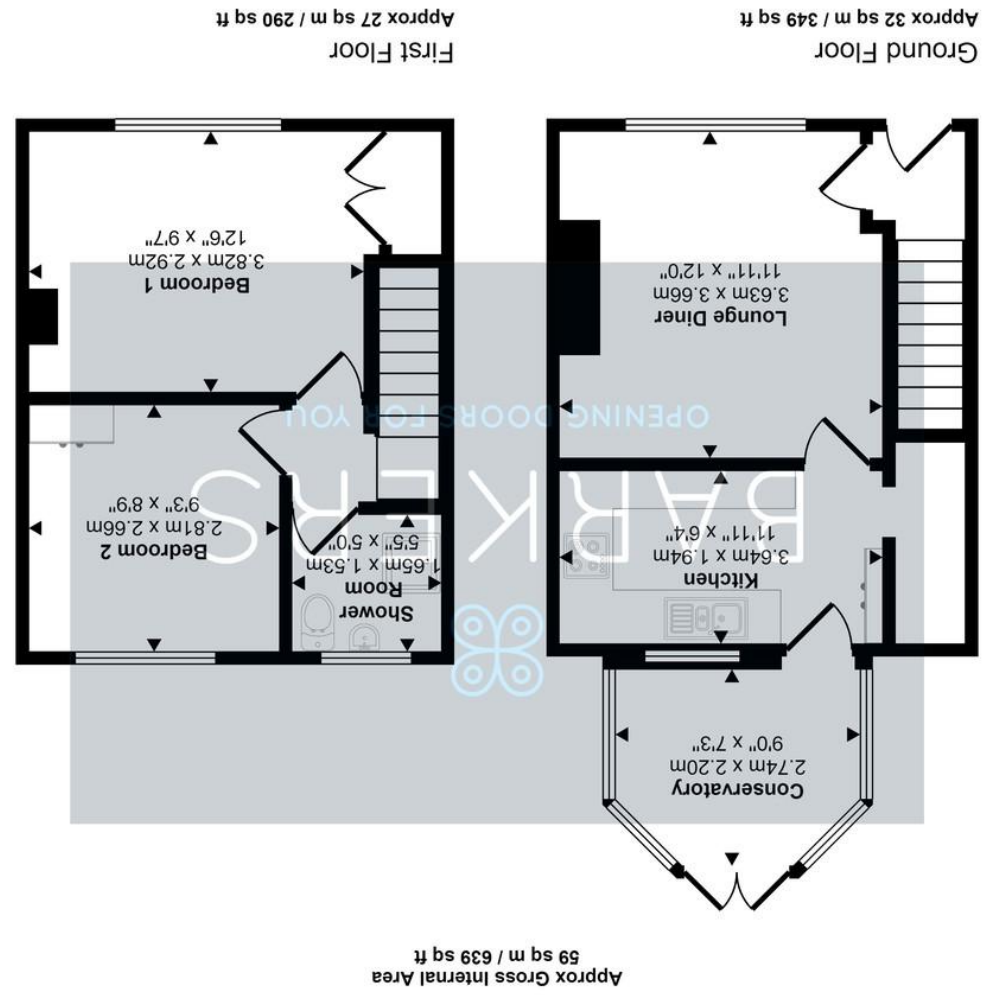

123 Birkenshaw Lane

Birkenshaw, Bradford, BD11 2HD

Asking Price Of £140,000

- MID TERRACE PROPERTY
- TWO BEDROOMS
- SHOWER ROOM
- CONSERVATORY
- GARDENS FRONT & REAR
- VIEWS OVER FIELDS TO REAR
- POPULAR LOCATION



Full Description

Offered with No Chain, Barkers are pleased to offer For Sale this two bedroom mid town house, with gardens front and rear and having a pleasant open aspect to the rear. The property is situated in a popular and convenient location, close to local amenities and transport links. The property briefly comprises; entrance hall with stairs to first floor, lounge, kitchen, conservatory, two bedrooms and shower room. Externally there are gardens to front and rear, with a lovely aspect to the rear with views over fields.

ENTRANCE HALL

External door into hall with stairs to first floor and door to lounge.

LOUNGE

11' 10" x 12' 0" (3.63m x 3.66m)

Spacious room having an Adam style fireplace with living flame gas fire, with marble effect hearth and back. Double glazed window. Door to kitchen.

KITCHEN

11' 11" x 6' 4" (3.64m x 1.94m)

Fitted with a range of wall and base units, one and a half bowl stainless steel sink, tiled splashbacks, plumbing for automatic washing machine, electric oven and gas hob with built-in extractor hood over. Part glazed door to conservatory.

CONSERVATORY

8' 11" x 7' 2" (2.74m x 2.20m)

Enjoying views over farmland. French doors opening on to the rear garden.

FIRS FLOOR LANDING

With loft access point, door to 2 bedrooms and bathroom.

BEDROOM ONE

12' 6" x 9' 6" (3.82m x 2.92m)

Double bedroom with built in cupboards.

BEDROOM TWO

9' 2" x 8' 8" (2.81m x 2.66m)

Double bedrooms with built in cupboards. Views over farmland.

SHOWER ROOM

5' 4" x 5' 0" (1.65m x 1.53m)

Comprising a three piece modern white suite with wash basin set in vanity unit, WC, shower cubicle with electric shower. Tiled floor.



EXTERNAL

To the front of the property there is a paved garden area with planed borders and mature shrubs. At the rear the property has a low maintenance paved garden with planted borders and views over fields.

ADDITIONAL INFORMATION

Tenure: Freehold

Council Tax Band: A

DIRECTIONS

From our Birkenshaw office proceed across Whitehall Road East onto Birkenshaw Lane and the property can be identified by our For Sale board.

