

Church Hall Church Lane, Church End, Haynes, Bedford, MK45 3QP  
Offers In The Region Of £250,000



**\*THE BEST AND FINAL OFFER DEADLINE HAS NOW PASSED ON THIS PROPERTY\***

Located in the Village of Haynes a single story former community hall with potential for conversion subject to appropriate permissions. The building currently comprises; Entrance Hall, Hall, Kitchen, Two WC's. The Village is ideally situated for easy access into Bedford, Milton Keynes and Luton.

Freeh

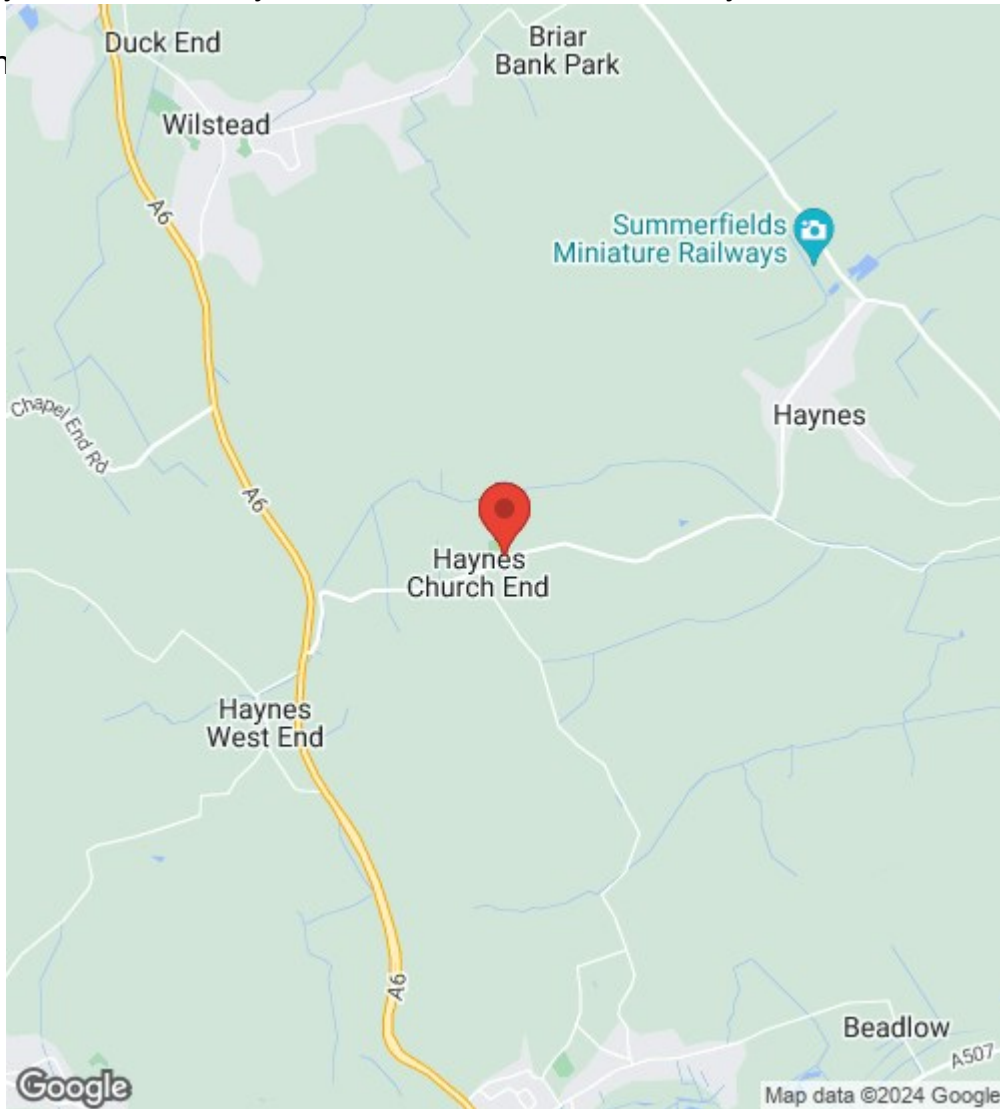



### Ground Floor

Approx. 66.5 sq. metres (715.3 sq. feet)

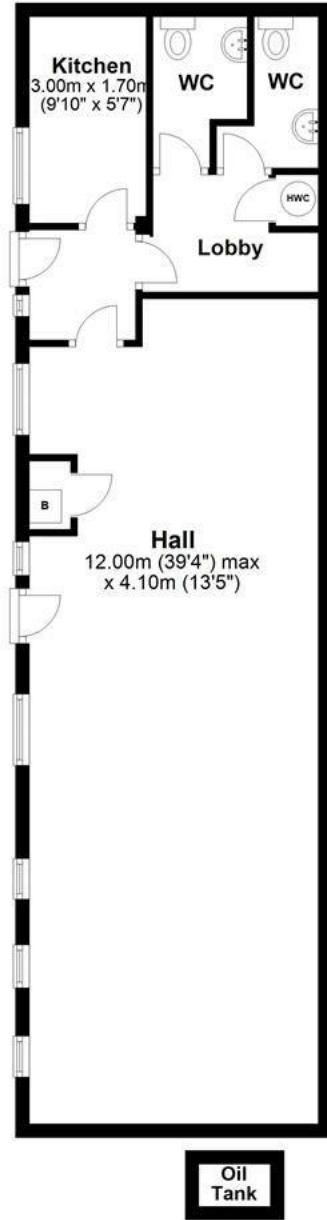

Total area: approx. 66.5 sq. metres (715.3 sq. feet)

Floorplan is not to scale and to be used for layout guidance only. Any measurements shown should not be relied upon. Floor Area (Sq/m) includes all areas shown on plan except Balconies, Patios, Eaves, Garden and Areas unless otherwise indicated.

Plan produced using PlanUp.

### Site Plan (Exterior wall measurements)

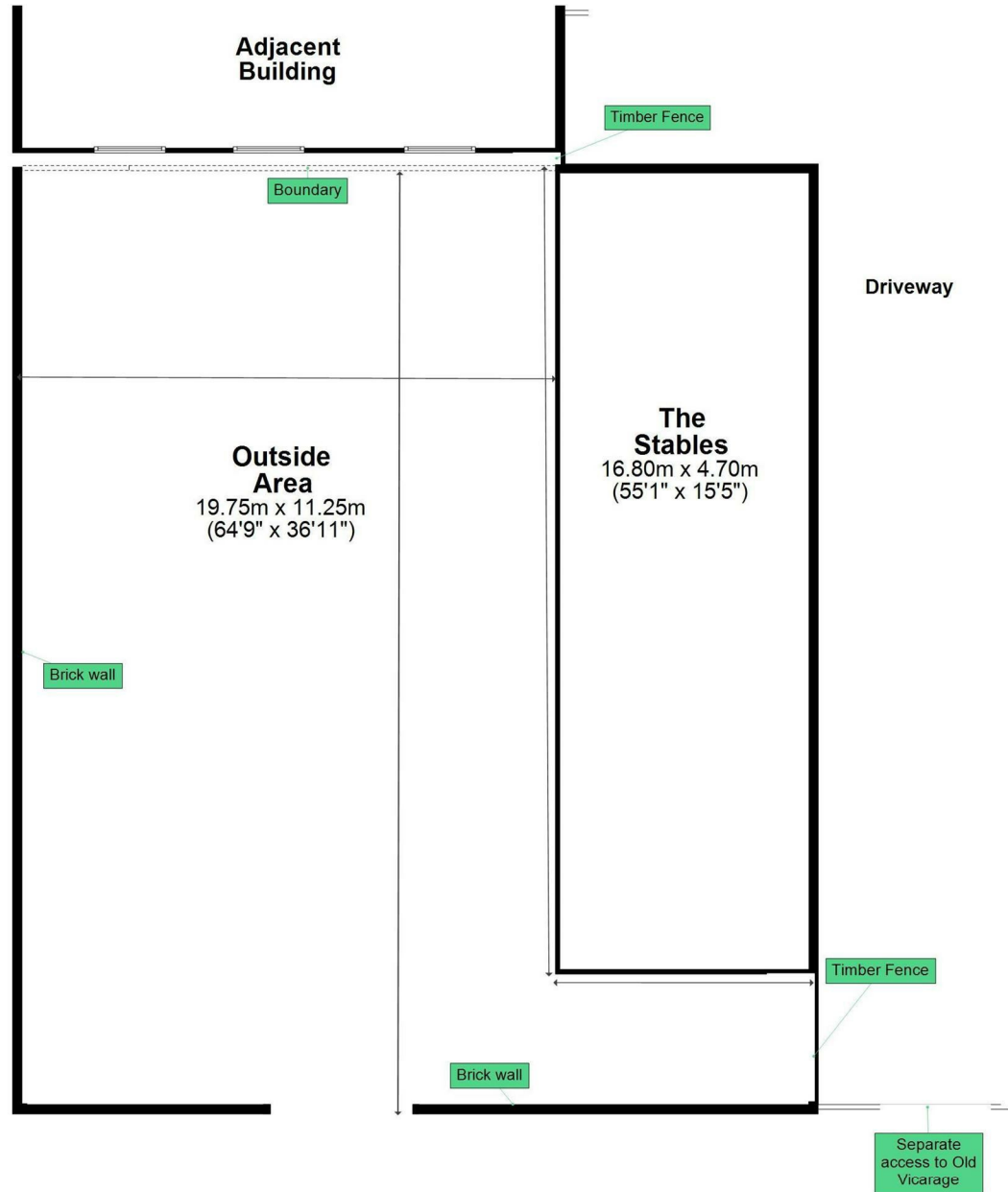

This floor plan is a guide to layout and is for identification purposes only. It is not to scale and any measurements shown should not be relied upon. SQUARE FOOTAGE/METERAGE when shown INCLUDES ALL AREAS ON PLAN EXCEPT BALCONY/EAVES, unless otherwise indicated.  
Plan produced using PlanUp.



These particulars, whilst believed to be accurate are set out as a general outline only for guidance and do not constitute any part of an offer or contract. Intending purchasers should not rely on them as statements of representation of fact, but must satisfy themselves by inspection or otherwise as to their accuracy. No person in this company's employment has the authority to make or give any representation or warranty in respect of the property.

16 London Road, St Albans, Hertfordshire, AL1 1NG  
Tel: 01727 581239 Email: [sales@spaceestates.com](mailto:sales@spaceestates.com)  
[www.spaceestates.com](http://www.spaceestates.com)