

Crucible Homes



Doncaster Road
Mexborough, S64 0HL

%priceQualifier%
%price%

Overview

Two Bedrooms

Option To Be A Three Bedroom

Two Reception Rooms

Spacious Living Accommodation

Long Term Let Available

EPC Rating - D



Description

SUMMARY

Available on a LONG term let is this SPACIOUS TWO bedroom terrace property, which has the option of being a THREE bedroom.

Property has recently just had new flooring in some of the rooms, along with redecoration and a new bathroom.

The layout of the property consists of; well portioned lounge, dining room, spacious kitchen and entrance to cellar.

To the first floor are two double bedrooms and the option for a third, as there is an additional room that comes off the second bedroom. There is a spacious brand new bathroom with his fitted with WC, wash hand basin and bath with shower over.

Externally is a rear enclosed yard and on street parking.



GROUND FLOOR



1ST FLOOR

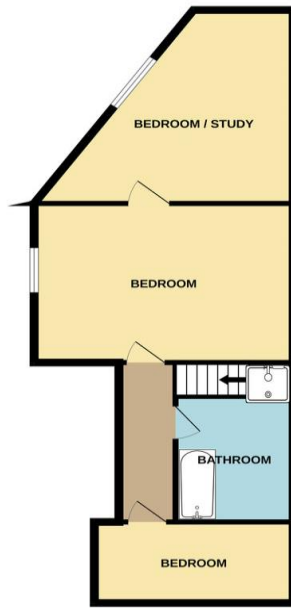

While every attempt has been made to ensure the accuracy of the floorplan contained here, measurements of doors, windows, rooms and any other items are approximate and no responsibility is taken for any error, omission or mis-statement. This plan is for illustrative purposes only and should be used as such by any prospective purchaser. The vendor's agents and solicitors given here and herein listed and no guarantee as to their quality or efficiency can be given. Made with Metropix ©2024

Score	Energy rating	Current	Potential
92+	A		
81-91	B		85 B
69-80	C		
55-68	D	67 D	
39-54	E		
21-38	F		
1-20	G		

AGENCY NOTE EPC Rating - D

Council Tax Band - A

ENTRANCE HALL

LOUNGE 16' 11" x 12' 0" (5.18m x 3.68m)

DINING ROOM 14' 11" x 13' 8" (4.57m x 4.19m)

KITCHEN 17' 5" x 8' 5" (5.31m x 2.59m)

FIRST FLOOR

FIRST FLOOR LANDING

BEDROOM ONE 16' 4" x 12' 0" (4.98m x 3.68m)

OPTIONAL ROOM 15' 1" x 9' 6" (4.62m x 2.92m)

BEDROOM THREE 12' 7" x 7' 6" (3.86m x 2.31m)

BATHROOM

EXTERIOR

