

# Crucible Homes

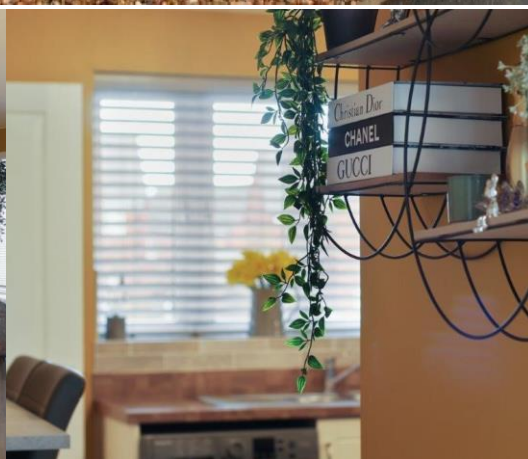

Spring Meadow  
Tibshelf, DE55 5QU

£170,000

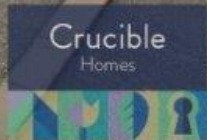

## Overview

Two Bedrooms

Modern Throughout

Breakfasting Kitchen

Rear Enclosed Garden

Off Road Parking

EPC Rating - B



## Description

**SUMMARY** Crucible Homes welcome this TWO bedroom MOVE IN READY property in the popular area of Tibshelf.

This property is perfect for anyone wanting to get onto the property ladder and experience modern living, with a touch of class.

Property benefits from having a breakfasting kitchen, with the option of some free standing kitchen appliances being part of the sale.

From the front of the property you enter into a small lobby which take you through to the modern breakfasting kitchen with ample wall and base units and space for free standing appliances, along with a front facing UPVC window looking out onto green space. From the kitchen you enter into the living room which has been tastefully decorated with wall paneling and UPVC French Doors leading to the low maintenance rear enclosed garden.



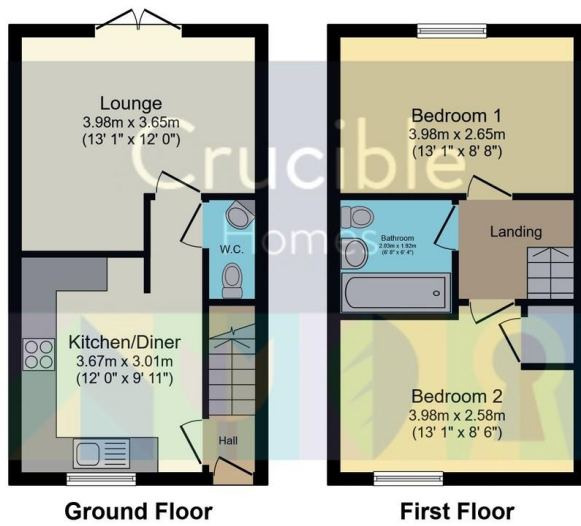

This plan is for illustration purposes only and may not be representative of the property. Plan not to scale. Powered by PropertyBox

Score	Energy rating	Current	Potential
92+	A		97 A
81-91	B	83 B	
69-80	C		
55-68	D		
39-54	E		
21-38	F		
1-20	G		

To the first floor are two good sized bedrooms and a modern family bathroom fitted in a white suite, with shower over.

Property is ideally located in good distance to local amenities including eateries, schools and local shops, along with accessing the local transport links.

Call Crucible Homes to arrange a viewing 01709 500333.

AGENCY NOTE

EPC Rating - B

Council Tax Band - B

Source of Heating - Gas Central Heating

Parking - Off Road

Construction - Brick

