



2 Bedroom Semi-Detached House

Tamworth Drive, Shaw, Swindon, SN5 5SG

Offers In Excess Of £220,000

mcfarlane
property.com

2 Bedroom Semi-Detached Swindon West

- WELL PRESENTED TWO BEDROOM SEMI
- IDEAL FIRST PURCHASE OR INVESTMENT
- SOUGHT AFTER WEST SWINDON LOCATION

- WELL PRESENTED SEMI DETACHED HOUSE -
SOUGHT AFTER WEST SWINDON LOCATION - IDEAL
FIRST PURCHASE OR INVESTMENT - TWO DOUBLE
BEDROOMS - GARDEN ROOM/HOME OFFICE -
GARAGE & GARDENS - NO CHAIN -

A well presented two bedroom semi detached house located in this sought after West Swindon location within easy reach of all local amenities, good schools and transport facilities. The accommodation comprises: Entrance Porch, Lounge, Fitted Kitchen/Dining Room, Landing, Two Bedrooms, Bathroom and Additional Garden Room/Home Office. Outside there are enclosed rear Gardens, Garage and Driveway. No Onward Chain.



Call to View

McFarlane Sales & Lettings
High Street
Cricklade
Wiltshire
SN6 6AY

01793 751 044

mcfarlane
property.com



Ground Floor

Approx. 51.3 sq. metres (552.4 sq. feet)

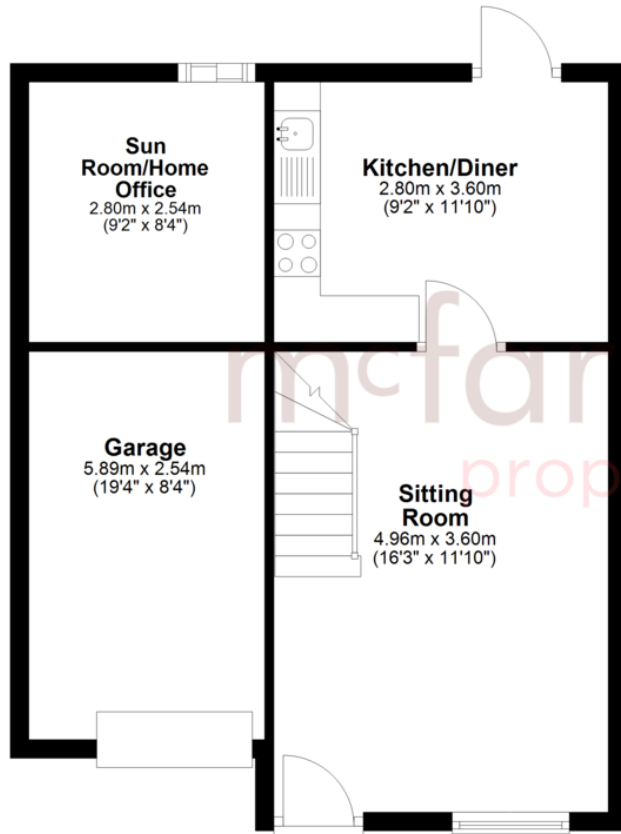

First Floor

Approx. 27.1 sq. metres (291.3 sq. feet)

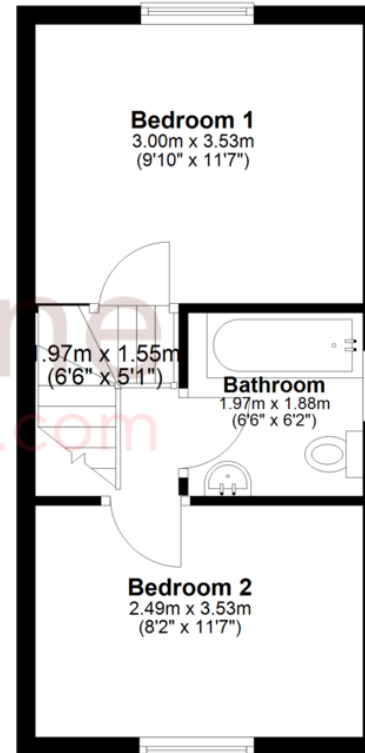

Total area: approx. 78.4 sq. metres (843.7 sq. feet)

We 
where you
LIVE

Our team are friendly, experienced and are all local. They know it better than they do their own living rooms and can help you find what you're looking for because **we love where we live.**

We would be delighted to show you around this property.

**Because every home
needs a personal touch.**

**If you would like to view this
property then please get in touch.**

📞 01793 751044

✉ cricklade@mcfarlaneproperty.com

mcfarlaneproperty.com

mcfarlane
property.com

Cricklade.

102 High Street
Cricklade SN6 6AA

📞 01793 751044

Marlborough.

106 High Street
Marlborough SN8 1LT

📞 01672 514380

Old Town.

28-30 Wood Street
Swindon SN1 4AB

📞 01793 296880

Swindon.

The Village Centre,
Redhouse SN25 2FW

📞 01793 296600

Agents Note: Whilst every care has been taken to prepare these sales particulars, they are for guidance purposes only. All measurements are approximate are for general guidance purposes only and whilst every care has been taken to ensure their accuracy, they should not be relied upon and potential buyers are advised to recheck the measurements