

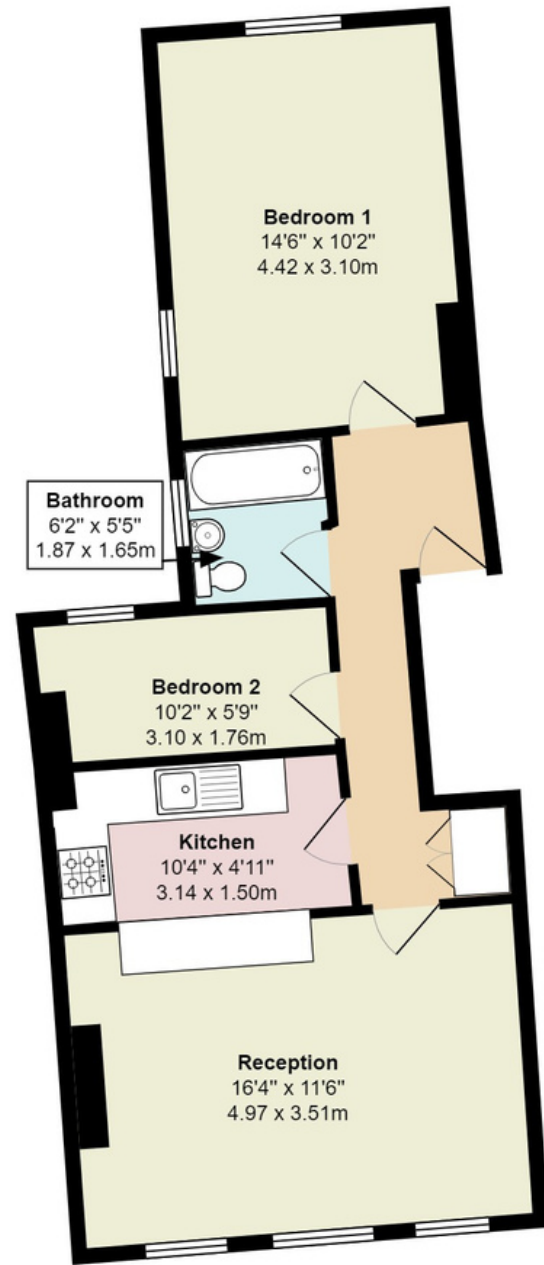

Crewys Road NW2

Total Area: 579 ft² ... 53.8 m²



First Floor

All measurements are approximate and for display purposes only



Crewys Road, Childs Hill, NW2

Guide Price : £435,000

Crewys Road, where comfort and style intertwine to create the perfect urban oasis. This spacious 2-bedroom apartment is meticulously designed, offering a contemporary living space that caters to your every need.

Upon entering, you will be greeted by a welcoming hallway, leading you to the heart of the home. The generously sized reception room awaits, bathed in natural light, the apartment also includes a modern kitchen, two bedrooms and bathroom.

Situated in the highly sought-after area of Crewys Road, the property benefits from being in close proximity to an array of amenities. From trendy boutique cafes and restaurants to well-established schools and parks, everything you need is right at your doorstep. Not to mention the excellent transport links that connect you to the heart of Central London, Greater London and beyond.

Whether you're a first-time buyer, a young couple, or looking for a lucrative investment opportunity, this apartment ticks all the boxes. Don't miss out on the chance to call Crewys Road your home. Contact us today to arrange a viewing and take the first step towards a lifestyle of comfort, style, and convenience.

Leasehold - 113 Years remaining
Ground Rent - £150 per annum



903-905 Finchley Road Golders Green London NW11 7PE

Telephone 020 8381 4970 Email info@moreland.uk.com

Registered Office Unit 8, Alpha Business Park, Travellers Close, Welham Green AL9 7NT Registered in England No. 3663497 Vat No. 701775936

Residential Sales Lettings Full Management Financial Services New Homes





Tenure Leasehold

441.32 sqft

2 Bedrooms

1 Bathroom

Permit

