



Bernard Crescent

Minehead, TA24 5HP
£125,000 Leasehold

			D
1	1	1	EPC

**Wilkie May
& Tuckwood**

Floor Plan

ACCOMMODATION *[All measurements are approximate],*

COMMUNAL ENTRANCE HALL

ENTRANCE HALL

LOUNGE 15'10" (4.82m) x 10'4" (3.14m)

STUDY/BEDROOM TWO 6'7" (2.00m) x 5'8" (1.72m)

KITCHEN 6'8" (2.03m) x 6'5" (1.95m)

BEDROOM ONE 14'9" (4.49m) x 8'1" (2.46m)

SHOWER ROOM

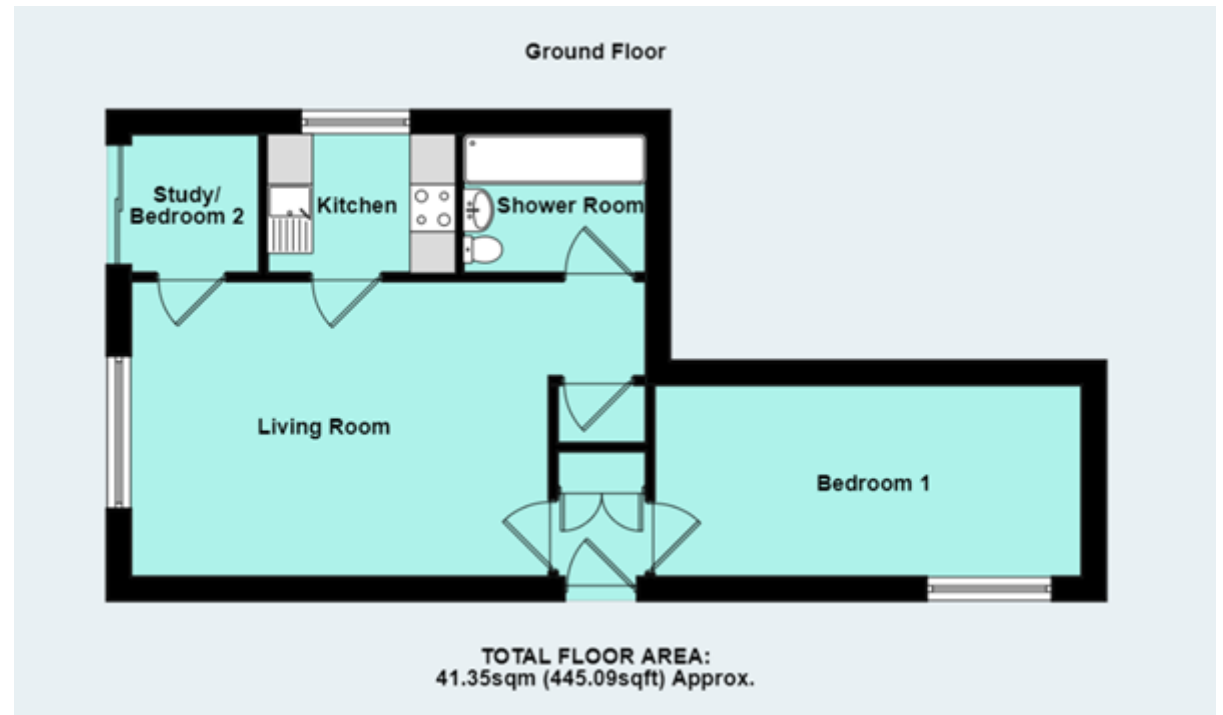

Description

A one bedroom ground floor Apartment situated within a purpose-built development a short walk from Minehead town centre. The property benefits from gas fired central heating and double glazing, a re-fitted shower room, well-maintained communal gardens, a drying area, residents' parking area and is offered for sale with NO ONWARD CHAIN.

- Ground floor Apartment
- 1 bedroom
- Lovely communal gardens
- Off road parking
- NO ONWARD CHAIN



THE ACCOMMODATION COMPRISES IN BRIEF: door into ENTRANCE HALL with shelved cupboard.

LIVING ROOM: good-sized room with window to the front enjoying an open aspect and door to:

STUDY/BEDROOM 2: which has patio doors leading out to the gardens.

KITCHEN: modern fitted kitchen with window to the side and wall mounted gas fired boiler.

BEDROOM 1: good-sized room with a window to the side.

SHOWER ROOM: re-fitted with a suite comprising a large walk-in shower cubicle with electric shower, low level wc and wash hand basin.

OUTSIDE: the property is set within well-maintained communal gardens with residents' parking area to the front and a drying area.



GENERAL REMARKS AND STIPULATION

Tenure: The property is offered for sale leasehold by private treaty. The property is held under the terms of the remainder of a 999 year Lease with a ground rent payable of £10 p.a. and a service charge currently £90.00 p.m.

Services: Mains water, mains electricity, mains drainage, gas fired central heating.

Local Authority: Somerset Council, Deane House, Belvedere Road, Taunton TA1 1HE

Property Location: w3w.co/unframed.landmark.ringers

Council Tax Band: A

IMPORTANT NOTICE Wilkie May & Tuckwood for themselves and for the vendors of the property, whose agents they are, give notice that: 1. the particulars are intended to give a fair and substantially correct overall description for the guidance of intending purchaser and do not constitute part of an offer or contract. Prospective purchasers and lessees ought to seek their own professional advice.

2. All descriptions, dimensions, areas, reference to condition and necessary permissions for use and occupation and other details are given in good faith, and are believed to be correct, but any intending purchasers should not rely on them as statements or representations of fact, but must satisfy themselves by inspection or otherwise as to the correctness of each of them. 3. No person in the employment of Wilkie May & Tuckwood has any authority to make or give any representations or warranty

whatever in relation to this property on behalf of Wilkie May & Tuckwood, nor enter into any contract on behalf of the vendor. 4. No responsibility can be accepted for any expenses incurred by intending purchasers in inspecting properties which have been sold, let or withdrawn. Photographs taken and details prepared November 2022. MEASUREMENTS AND OTHER INFORMATION All measurements are approximate. While we endeavour to make our sales particular accurate and reliable, if there is any point which is of particular importance to you, please contact the office and we will be pleased to check the information with you.

Code of Practice for Residential Estate Agents: Effective from 1 August 2011:

'8. Financial Evaluation 8a At the time that an offer has been made and is being considered by the seller, you must take reasonable steps to find out from the prospective buyer the source and availability of his funds for buying the property and pass this information to the seller. Such information will include whether the prospective buyer needs to sell a property, requires a mortgage, claims to be a cash buyer or any combination of these. Such relevant information that is available should be included in the Memorandum of Sale having regard to the provisions of the Data Protection Act.8b These reasonable steps must continue after acceptance of the offer until exchange of contracts (in Scotland, conclusion of missives) and must include regular monitoring of the prospective buyer's progress in achieving the funds required, and reporting such progress to the seller.

The agent has not tested any apparatus, equipment, fixtures and fittings or services and so cannot verify that they are in working order or fit for their purpose. A Buyer is advised to obtain verification from their solicitor or surveyor. References to the Tenure of the Property are based on information supplied by the Seller. The agent has not had sight of the title documents. A Buyer is advised to obtain verification from their Solicitor.