

Liberty House
Bessemer Road
Welwyn Garden City
AL7 1FU

 2 Double Bedrooms

 2 Bath/Shower Rooms

 1 Reception Room

 1 Allocated Parking Space

 Communal

 EPC Band D

Council Tax Band: C

£1,941.47 Apr 24/Mar 25.

Leasehold: 125 years from 1st October 201
Service Charge: £173 pm.

Guide Price
£325,000 Leasehold

 **ashtons**
for life's great moves



Situated on the first floor with lift access and allocated parking, this immaculately presented two bedroom two bathroom apartment is situated in a popular modern development just a short walk from the town centre amenities and mainline station.

Description

This first floor apartment has a smart modern interior and, although converted in 2016, still feels like a brand new home. With lift access and a large and welcoming communal lobby, upon entering the apartment the hall, which has a useful deep storage and utility cupboard, provides access to the reception room, bedrooms and family bathroom.

The living/dining room is a good size with dual aspect windows and space for entertaining and dining. An opening leads into the kitchen which is fitted with a range of storage cupboards and integrated appliances. Both bedrooms are generous doubles with ample space for wardrobes and drawers with the principal bedroom featuring an en-suite shower room. There is a security entry system and one allocated parking space with additional visitor bays if required. There is also a communal sitting/meeting room which the residents have access to.

Being sold with no onward chain.

Location

Nearby Welwyn Garden City town centre offers a wide range of amenities and shops including John Lewis department store, Sainsbury & Waitrose. The mainline rail station is within easy reach just a short walk away, with frequent trains to London Kings Cross and Moorgate to the south. Shire Park business centre is also nearby and the A1(M) junction 6 is a comfortable five minute drive away.

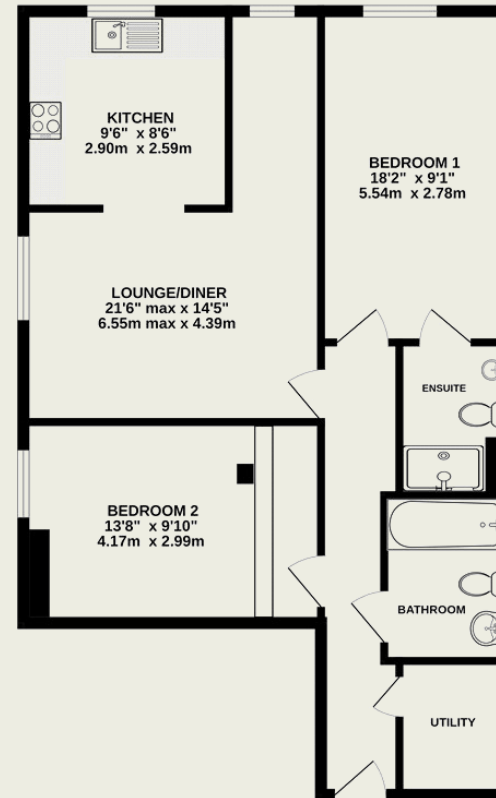

FIRST FLOOR
774 sq.ft. (71.9 sq.m.) approx.

This floorplan is for illustrative purposes only. The measurement and position of each element is approximate and must be viewed as such.

Important Information

These particulars do not constitute an offer or contract in whole or part. The statements contained herein are made without responsibility on the part of Ashtons or the vendors and they cannot be relied upon as representatives of fact. In respect of floor plans, these are for illustrative purposes only. The measurement and position of each element is approximate and must be viewed as such. Intending purchasers should therefore satisfy themselves by inspection or otherwise as to their correctness. The vendors do not make or give, and neither Ashtons nor any person in their employment has any authority to make or give, any representation or warranty whatsoever in relation to this property.

We offer a wide range of services through third-party providers including solicitors, surveyors, removal firms, mortgage providers and EPC suppliers. We receive additional payments for administering suppliers quoting software and making referrals. You are not under any obligation to use these services and it is your discretion whether you choose to deal with these parties or your own preferred supplier. You should be aware the average payment we received in 2021 equated to £48.36 per referral.