



**19 Walseker Lane | Woodall | Sheffield | S26 7YJ**

**Guide Price £350,000 to £375,000**

Bell & Co Estates are delighted to present this Three Bedroom, large Detached Home on this popular street in Woodall. Positioned on a substantial plot, with some modernisation this would make a truly amazing family home. In brief the property comprises of Entrance Hallway allowing access to the Lounge beaming with natural light and patio doors overlooking the garden, good size Study, Kitchen with store cupboard and access to the side of the property, Downstairs WC and a lovely front facing Dining Room. To the upstairs are three good size bedrooms, master with fitted wardrobe's, family bathroom with bath, sink, WC and separate shower. The landing also provides access to the balcony with views to the front and rear that are simply breathtaking. To the outside the front is mainly laid to lawn with a sweeping driveway leading to a Double Garage with workshop, carport and outbuildings including boiler house and Utility. To the rear is a large garden which is mainly laid to lawn with beautiful shrubbery and plants creating a lovely private and enclosed garden.

- No Chain
- Substantial Plot
- Large Family Home
- A great project
- Double Garage
- Outbuildings & Workshop
- Three good-size Bedrooms
- Large Bathroom

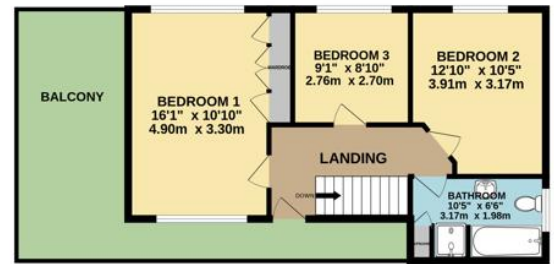
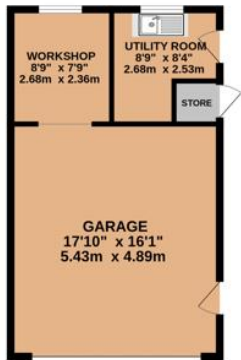

## Contact Details

79 Wales Road  
Kiveton Park  
Sheffield  
South Yorkshire  
S26 6RA

[www.bellcoestates.com](http://www.bellcoestates.com)

03333 580590

19 Walseker Lane  
Woodall  
Harthill  
SHEFFIELD  
S26 7YJ

Energy rating

**E**

Valid until  
**6 February 2034**

Certificate number  
**0350-2863-8320-2604-5431**

**Property type** Detached house

**Total floor area** 107 square metres

Agents Note: Whilst every care has been taken to prepare these sales particulars, they are for guidance purposes only. All measurements are approximate and for general guidance purposes only and whilst every care has been taken to ensure their accuracy, they should not be relied upon and potential buyers are advised to recheck the measurements