



## Stunning Period Cottage

Spital Lane, Cricklade, Wiltsire, SN6 6BQ

Offers in Excess Of £425,000

**mcfarlane**  
property.com

## Three Bedroom Period Cottage Cricklade North Wiltshire

- Stunning Three Bedroom Cottage
- Period Feature and Charm
- Overlooking Fields to the Rear

A simply stunning Three Bedroom Extended and Greatly Improved Cottage overlooking Open Fields on the edge of Cricklade. This cottage has been sympathetically updated whilst retaining the charm and features of a cottage of this age. The signature Kitchen that overlooks rolling fields to the rear boasting French doors to the patio and seating area. There is also a beautiful Living Room to the front elevation with contemporary décor and open fire. The Dining Area is also worthy of note with an exposed red brick fired breast. The Ground Floor Shower Room and Expansive Utility Room of some 4.6m offer versatility and storage. The Three Bedrooms to the First Floor are generous as with the contemporary Family Bathroom. There is a Generous Private Rear Garden overlooking fields to the rear. Off Road Parking to the Side and Front for Two Cars.





## Cricklade

The former market town of Cricklade is known for being The First Town on the Thames and a former Saxon settlement. The SSSI and NNR North Water Meadow is of note with the annually blooming snake headed fritillaries. The bustling high street offers a multitude of traders and eateries. There is also a dispensing pharmacy, dentist, optician, and GP surgery. Access to the larger market towns of Cirencester & Swindon is via ease of access via the neighboring A419.

Viewings by appointment only

Sole Selling Agents  
McFarlane Sales & Lettings  
36 High Street  
Cricklade  
Wiltshire  
SN6 6AY

(01793) 751 044



mcfarlane  
property.com



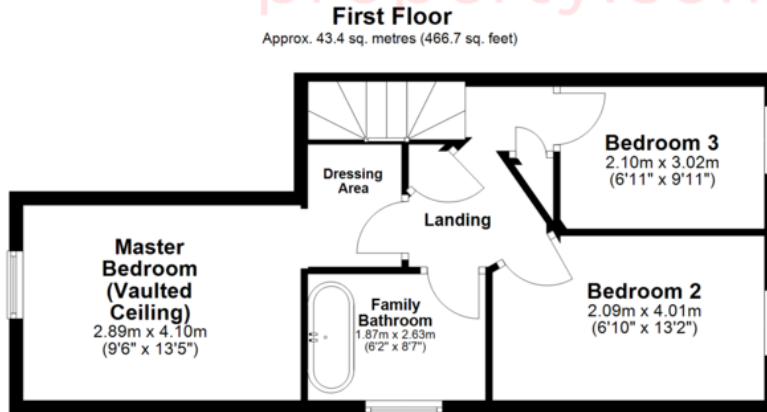
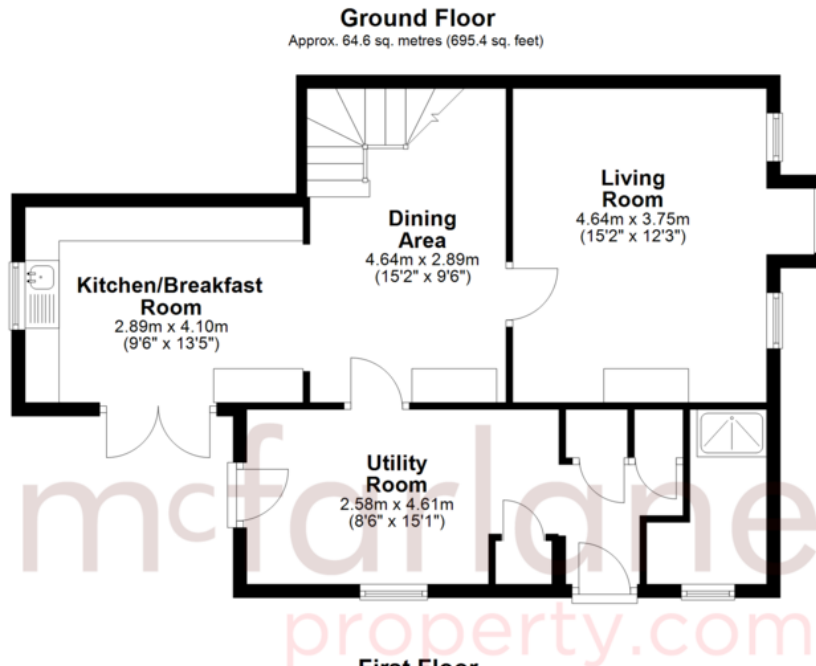

Total area: approx. 108.0 sq. metres (1162.0 sq. feet)

We   
where you  
**LIVE**

Our team are friendly, experienced and are all local. They know it better than they do their own living rooms and can help you find what you're looking for because **we love where we live.**

We would be delighted to show you around this property.

**Because every home  
needs a personal touch.**

**If you would like to view this  
property then please get in touch.**

☎ 01793 751044

✉ [cricklade@mcfarlaneproperty.com](mailto:cricklade@mcfarlaneproperty.com)

[mcfarlaneproperty.com](http://mcfarlaneproperty.com)

mcfarlane  
property.com

**Cricklade.**

102 High Street  
Cricklade SN6 6AA

☎ 01793 751044

**Marlborough.**

106 High Street  
Marlborough SN8 1LT

☎ 01672 514380

**Old Town.**

28-30 Wood Street  
Swindon SN1 4AB

☎ 01793 296880

**Swindon.**

The Village Centre,  
Redhouse SN25 2FW

☎ 01793 296600

Agents Note: Whilst every care has been taken to prepare these sales particulars, they are for guidance purposes only. All measurements are approximate are for general guidance purposes only and whilst every care has been taken to ensure their accuracy, they should not be relied upon and potential buyers are advised to recheck the measurements