



THE
BROUGHTON
A three bedroom detached and
semi-detached home



BLUEBELL
HOMES

CGI shows Broughton housetype, elevational treatments may vary.

THE BROUGHTON

A three bedroom detached and semi-detached home

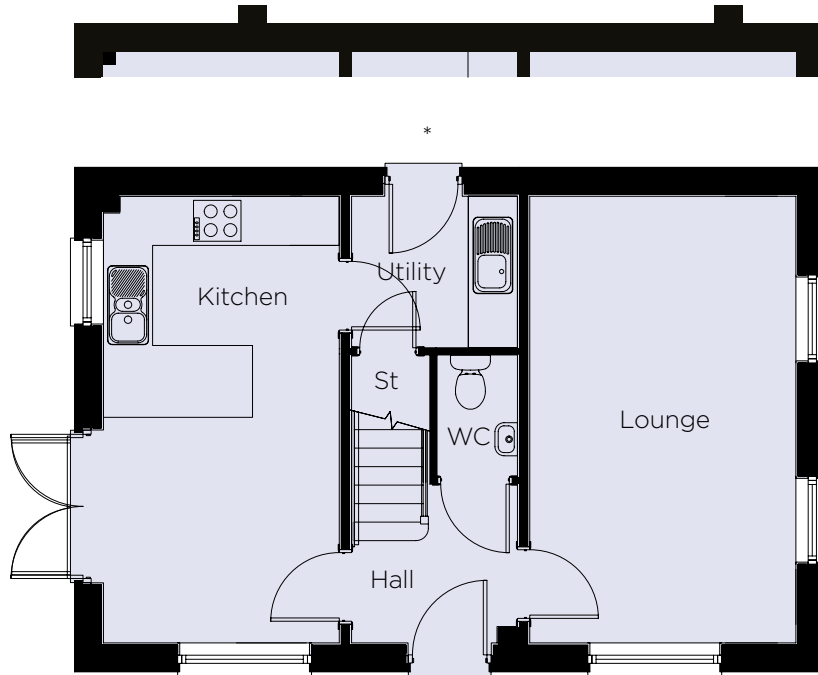

Ground Floor

Kitchen	2.88m x 2.70m	9'5" x 8'10"
Dining	2.88m x 2.76m	9'5" x 9'1"
Lounge	5.46m x 3.25m	17'11" x 10'8"

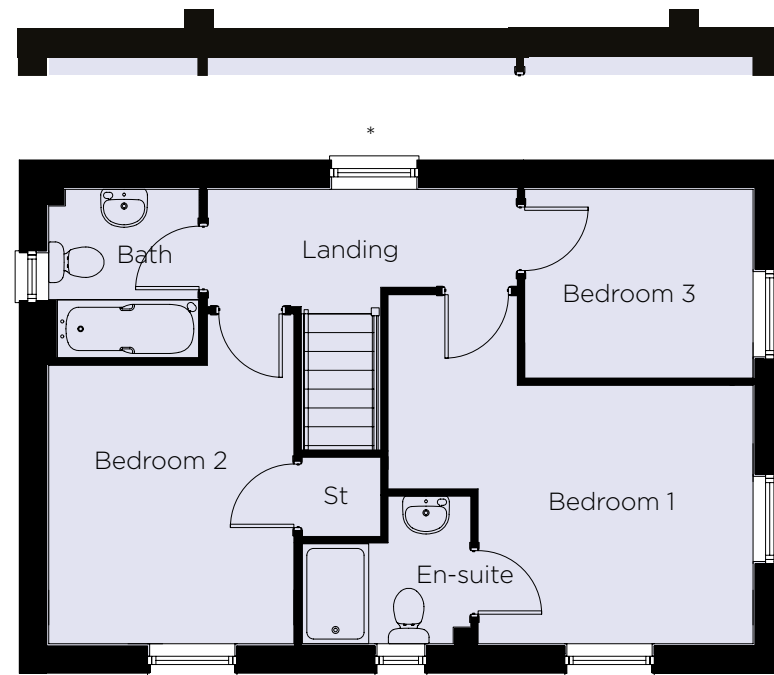

First Floor

Bedroom 1	4.38m x 3.10m	14'4" x 10'2"
Bedroom 2	3.33m x 2.94m	10'11" x 9'8"
Bedroom 3	2.74m x 2.27m	9'0" x 7'5"

Elevational treatments may vary by plot. Plot 194 will have no door to utility and window to landing as indicated by *

These images are designed to give an impression of the development and our housetypes - they may not reflect a specific plot and do not form part of any contract. Final finishes, landscaping and detail will vary. This information has been provided in good faith, however all layouts and measurements are approximate only. Some house types include areas of reduced headroom. Bathroom and kitchen layouts are indicative only and designs may change due to our process of continuous product development. Images used in marketing materials may be computer generated or photography of previous developments. Dimensions are taken to the maximum.

**CONSUMER
CODE FOR
HOME BUILDERS**

www.consumercode.co.uk



**BLUEBELL
HOMES**