



122 Chester Street | Chesterfield | S40 1DN

Guide Price £150,000 to £160,000

Bell & Co Estates are delighted to present this TWO BEDROOM END-TERRACE home selling with no vendor chain. In brief the property comprises of front facing Lounge, Dining Room with open fire and surround with patio doors opening onto the rear garden and rear facing Kitchen with further rear door. There is also a spacious understairs storage cupboard which houses the fully functioning boiler with plumbing for the washing machine. Upstairs are TWO LARGE BEDROOMS and large Family Bathroom complete with corner bath and separate shower cubicle. This property also benefits from a NEW ROOF with a 20 YEAR GUARANTEE and Flat Roof to the kitchen with a 5 YEAR GUARANTEE! To the front of the property is a stoned area with side gate providing access to the rear patio with outside tap and electrical point, decking and shed. This is a perfect first time buyers home or investment opportunity. Close to the town centre, local schools as this is within the Brookfield School catchment, transport links and amenities this home is in a great location.

- NO CHAIN!
- Two Bedroom End Terraced
- Perfect First Time Buyers Home
- Kitchen
- Dining Room
- Spacious Lounge
- NEW ROOF with Guarantee



GROUND FLOOR
432 sq.ft. (40.1 sq.m.) approx.

1ST FLOOR
393 sq.ft. (36.5 sq.m.) approx.

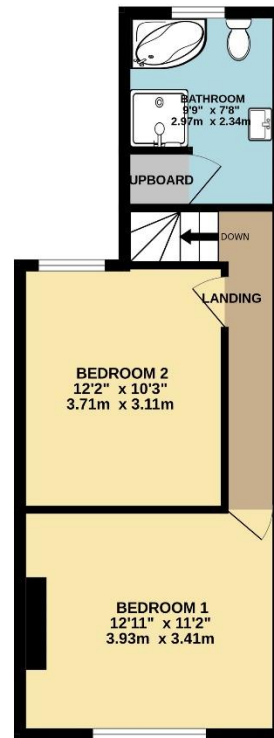
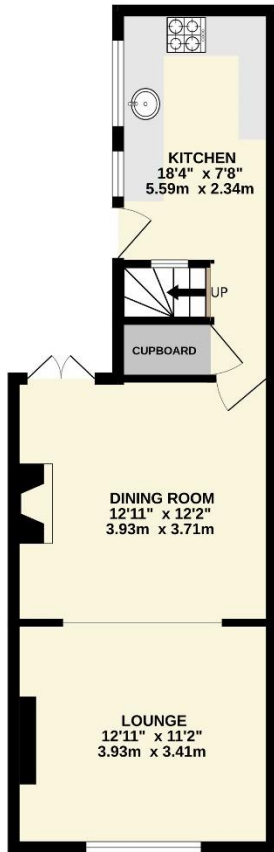

Contact Details

79 Wales Road
Kiveton Park
Sheffield
South Yorkshire
S26 6RA

www.bellcoestates.com

03333 580590

122 Chester Street
CHESTERFIELD
S40 1DN

Energy rating

D

Valid until
13 February 2034

Certificate number
9527-3034-3202-8874-8200

Property type End-terrace house

Total floor area 81 square metres

Agents Note: Whilst every care has been taken to prepare these sales particulars, they are for guidance purposes only. All measurements are approximate and for general guidance purposes only and whilst every care has been taken to ensure their accuracy, they should not be relied upon and potential buyers are advised to recheck the measurements