



Flat 2, Maison Victor Hugo, Greve D'Azette, St. Clement, Jersey **BROADLANDS**

£335,000

FINDING YOU A HOME SINCE 1972

Flat 2, Maison Victor Hugo, Greve D'Azette

St. Clement, Jersey

- No onward chain
- 1 designated parking space
- Great first home or buy to let
- Modern building and well presented
- Walk to work
- Direct access on to the beach
- Extremely large studio 570 sq ft
- Call Doug on 07700702585 or doug@broadlandsjersey.com



Flat 2, Maison Victor Hugo, Greve D'Azette

St. Clement, Jersey

Larger than many one bedroom apartments on the market, consisting of 570 sq ft. Well presented and airy and light throughout. With direct access to the beach and within walking distance of Marks and Spencer, town and on a frequent bus route, the property is a perfect first home or ideal buy to let. Separate kitchen with a full range of integrated appliances and house bathroom. Great size studio. Would make a great first home or investment.





Studio

Great size w studio room with a bay window. Built in cupboards with a foldaway bed. Separate fully integrated kitchen. House bathroom.

Parking

Secure gated parking for 1 car.

Services

Service charges £100 pcm.





GROUND FLOOR
570 sq.ft. (52.9 sq.m.) approx.

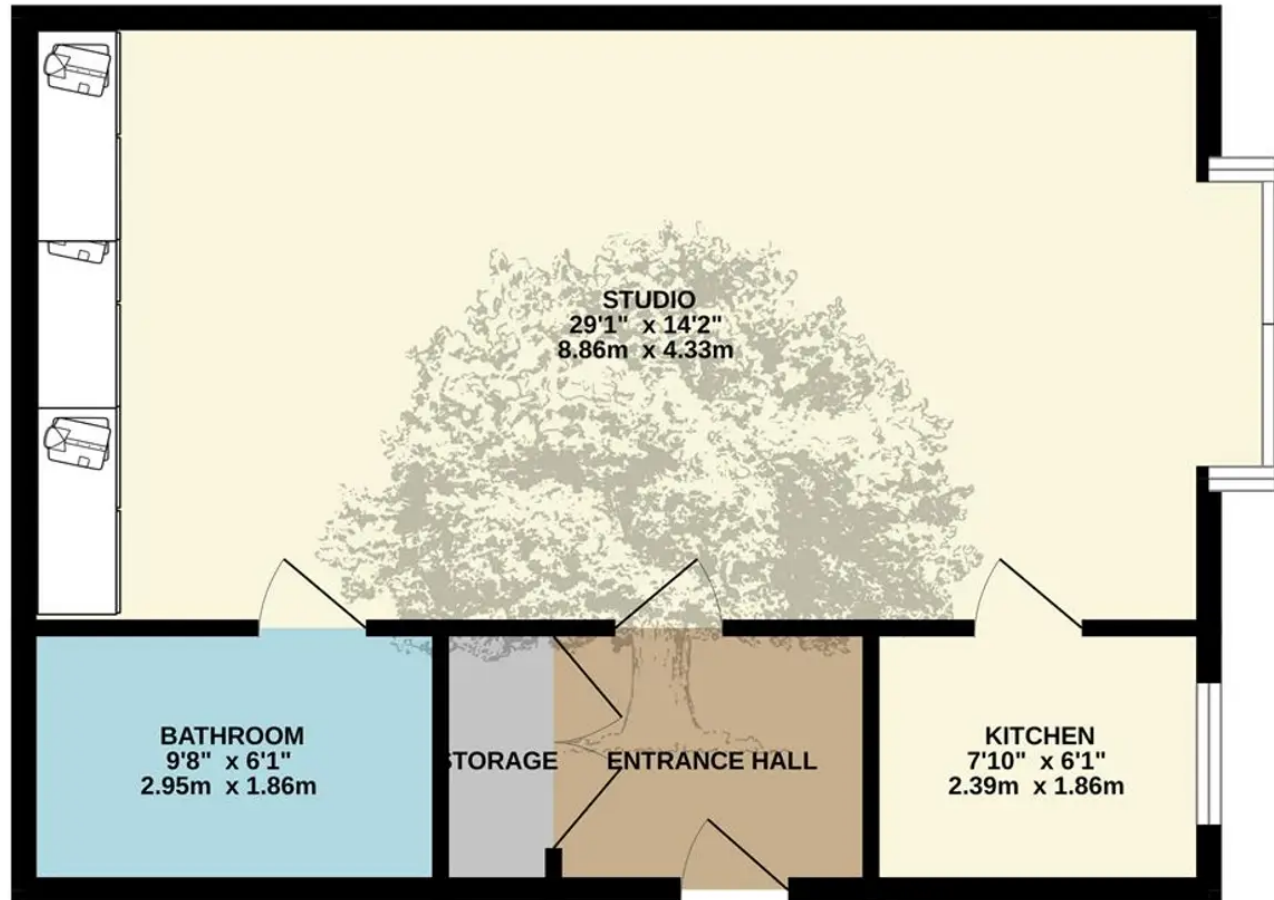

TOTAL FLOOR AREA : 570 sq.ft. (52.9 sq.m.) approx.

Whilst every attempt has been made to ensure the accuracy of the floorplan contained here, measurements of doors, windows, rooms and any other items are approximate and no responsibility is taken for any error, omission or mis-statement. This plan is for illustrative purposes only and should be used as such by any prospective purchaser. The services, systems and appliances shown have not been tested and no guarantee as to their operability or efficiency can be given.

Made with Metropix ©2023



Broadlands

Broadlands Estates, Library Place - JE2 3NL

01534 880770 • enquiries@broadlandsjersey.com • www.broadlandsjersey.com/

BROADLANDS

FINDING YOU A HOME SINCE 1972