



**Flat 5, Ashley House, St. Saviours Hill, St. Saviour, Jersey**  
**£399,000**

**BROADLANDS**  
FINDING YOU A HOME SINCE 1972

# Flat 5, Ashley House, St. Saviours Hill

St. Saviour, Jersey

Located towards the top of St Saviour's Hill.

- Walk to work
- Spacious 2 bedroom apartment
- Amenities close by
- Well presented
- 1 designated parking space
- Generous lounge
- Stunning distant sea views
- Vendor will pay for your legal fees with Vibert's lawyers and one year service charges
- Call Doug on 07700702585 or [doug@broadlandsjersey.com](mailto:doug@broadlandsjersey.com)





# Flat 5, Ashley House, St. Saviours Hill

St. Saviour, Jersey

Stunning sea views from your lounge. Located on the 4th floor, this spacious 2 bedroom apartment is well presented throughout and comes with 1 designated parking space. Light and airy and located on St Saviour's Hill, ideal for walking to work and close to all the amenities you would require. The property comprises of two double bedrooms, spacious lounge, house bathroom and separate kitchen with one designated parking space. This would make a great first home or ideal buy to let. No onward chain and a motivated vendor. The vendor has offered to pay your legal fees if you use Vibert's. The vendor will pay the first year of the service charges. The apartment qualifies for the new government First step scheme.





**Living**

Generous lounge with separate kitchen.

**Sleeping**

2 x double bedrooms and house bathroom.

**Parking**

One designated parking space.

**Services**

All main services, electric heating. Service charges T.B.A.







FOURTH FLOOR  
674 sq.ft. (62.7 sq.m.) approx.

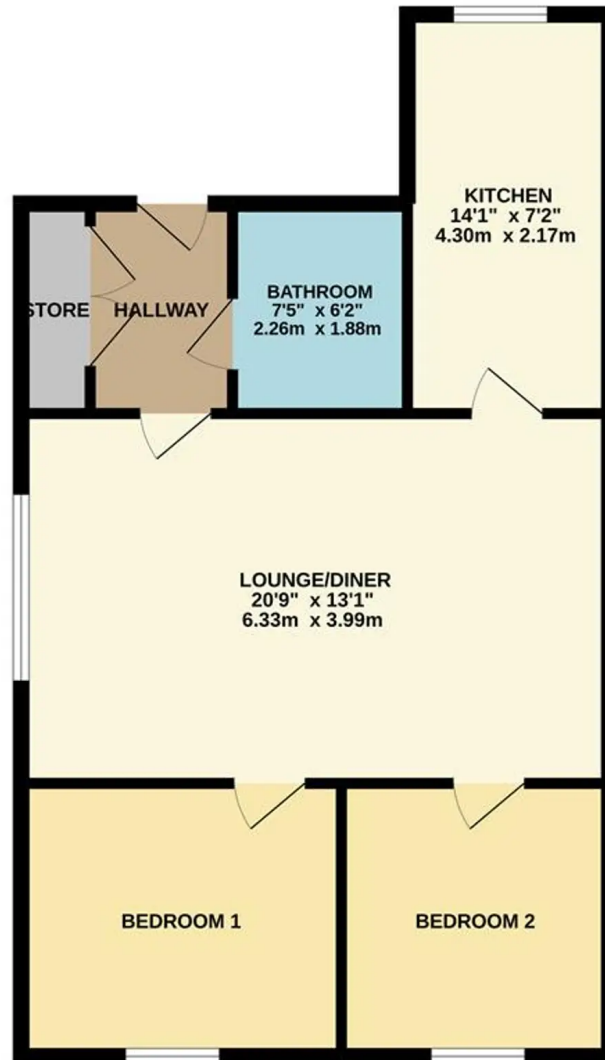

TOTAL FLOOR AREA : 674 sq.ft. (62.7 sq.m.) approx.

Whilst every attempt has been made to ensure the accuracy of the floorplan contained here, measurements of doors, windows, rooms and any other items are approximate and no responsibility is taken for any error, omission or mis-statement. This plan is for illustrative purposes only and should be used as such by any prospective purchaser. The services, systems and appliances shown have not been tested and no guarantee as to their operability or efficiency can be given.  
Made with Metropix ©2022





## Broadlands

Broadlands Estates, Library Place - JE2 3NL

01534 880770 • [enquiries@broadlandsjersey.com](mailto:enquiries@broadlandsjersey.com) • [www.broadlandsjersey.com/](http://www.broadlandsjersey.com/)

# BROADLANDS

FINDING YOU A HOME SINCE 1972