



Magdala Mount Lower Kings Cliff, St. Helier
£2,100,000

BROADLANDS

FINDING YOU A HOME SINCE 1972

Magdala Mount Lower Kings Cliff

St. Helier, Jersey

- Beautiful period residence
- Five bedrooms & three bathrooms
- Spacious & light
- Lots of features including high ceilings, elegant cornices and large picture windows
- Integral one bed flat
- Two private gardens & swimming pool
- Purpose built wine cellar
- Double garage & lots of parking
- Sweeping views over St Helier
- Sole agent - WhatsApp Don 07829 917172 / don@broadlandsjersey.com



Magdala Mount Lower Kings Cliff

St. Helier, Jersey

Nestling in a quiet position overlooking St Helier, it retains much of its authentic period charm and many original features. Built in the days when great emphasis was placed on style and space, this 4,500 square feet property offers a comfortable living experience hard to find with more recent builds. The accommodation over four floors includes two large reception rooms - one 465 square feet and the other 357 square feet - a fully fitted eat-in kitchen, sun room, office, five bedrooms, dressing room, three bath/shower rooms, games room and wine store. Outside is a large private garden with covered swimming pool, second raised garden with panoramic views over St Helier, a double garage and plenty of parking. The versatile accommodation also includes an integral one bed flat, ideal for a housekeeper, carer or as a unit to let. Ideally located within walking distance of the town centre yet far enough away from the hustle and bustle, this property offers so much. Call now to view.





Living

Welcoming entrance hall with feature cornices and two chandeliers. Door to thirty-one foot living room with picture windows to front and rear, two chandeliers and two functional fireplaces. Through to sunroom with views over St Helier and double doors to terrace. Door to office.

Sleeping

The property benefits from five double bedrooms. The main suite comprises 24 foot bedroom - with two picture windows to front and feature fireplace - dressing room and refurbished bathroom. Two further bedrooms and house bathroom occupy the first floor. Upstairs are two further doubles, one with study and ensuite shower room.

Flat

One bed qualified unit comprising lounge, kitchen, bedroom and bathroom.

Games Room and Wine Store

Versatile room ideal as a games room or gym situated at lower ground floor level. Bespoke wine store designed and fitted by one of the Island's leading wine companies.

Outside

Large garden to rear mostly laid to lawn. Covered swimming pool. Second raised garden with panoramic views over St Helier. Large garage with plenty of storage space. Lots of parking.

Services

All mains excluding gas. OFCH. Large oil tank feeds main house. Second dedicated oil tank for Aga. Wired for satellite and fibre.



LOWER GROUND FLOOR
 204 SQ. FT. (19.0 SQ. M.) APPROX.



GROUND FLOOR
 1245 SQ. FT. (115.0 SQ. M.) APPROX.

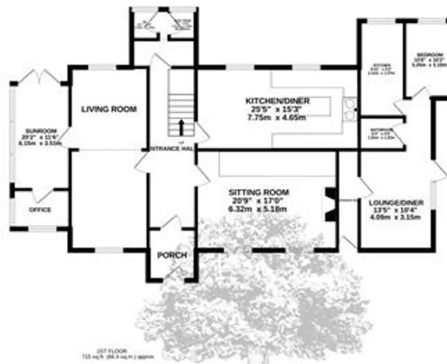

1ST FLOOR
 713 SQ. FT. (65.9 SQ. M.) APPROX.

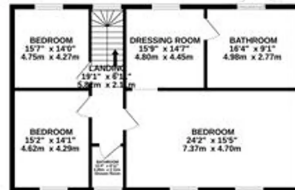

2ND FLOOR
 703 SQ. FT. (64.9 SQ. M.) APPROX.

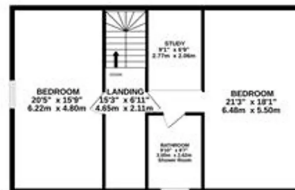

TOTAL FLOOR AREA : 4500sq.ft. (418.1 sq.m.) approx.

Whilst every attempt has been made to ensure the accuracy of the floorplan contained here, measurements of doors, windows, rooms and any other items are approximate and no responsibility is taken for any error, omission or mis-statement. This plan is for illustrative purposes only and should be used as such by any prospective purchaser. The services, systems and appliances shown have not been tested and no guarantee as to their operability or efficiency can be given.
 Made with Metropix ©2023



Broadlands

Broadlands Estates, Library Place - JE2 3NL

01534 880 770 • enquiries@broadlandsjersey.com • www.broadlandsjersey.com/

BROADLANDS

FINDING YOU A HOME SINCE 1972