



B4 Victor Hugo Greve D'Azette, St. Clement
£895,000

BROADLANDS
FINDING YOU A HOME SINCE 1972

B4 Victor Hugo Greve D'Azette

St. Clement, Jersey

Heading East along Greve D'Azette, Victor Hugo is on the right hand side just before the junction with Green Road.

- Large 3 bedroom, 3 bathroom apartment
- Amazing sea views
- Sought after prestigious development
- Good size store cupboard
- 2 parking spaces in tandem
- On the no.1 bus route
- Sole agent
- Contact James on 07829 835076 or james@broadlandsjersey.com



B4 Victor Hugo Greve D'Azette

St. Clement, Jersey

Superb seafront apartment located on the 1st floor of the prestigious development, Maison Victor Hugo at Greve D'Azette. Offering generously proportioned accommodation, comprising of 3 double bedrooms and 2 bathrooms. The principle bedroom benefitting from an ensuite bathroom and double doors onto the balcony.

Exceptionally large living room with sliding doors opening to the balcony, eat in kitchen and utility room. Secure underground parking for 2 cars, plus plenty of visitors parking, lock up store room and lift access from the carpark. With direct access to the beach and within walking distance of Marks and Spencer, town and on a frequent bus route, the property is a perfect downsize/ lock up and leave and likewise perfect for the busy professional.





Living

Welcoming entrance hall, opening to a large living room with sliding doors to south facing balcony, offering superb sea views, and a separate fully fitted kitchen with breakfast bar and far reaching views over town, utility room plus guest WC.

Sleeping

Generous principle bedroom with sea views, built in wardrobes, ensuite bathroom and sliding doors opening to the balcony. Second and third doubles at the rear of the building and main bathroom.

Outside

Along with private balcony there is a communal patio garden/ seating area and direct beach access.

Services

All mains excluding gas. Electric heating. Caretaker available on site Monday- Friday. Service charge is £359 per month and includes caretaker, water rates, foncier rates, communal maintenance/ cleaning/ gardening/ lighting and sinking fund.





FIRST FLOOR
1263 sq.ft. (117.3 sq.m.) approx.

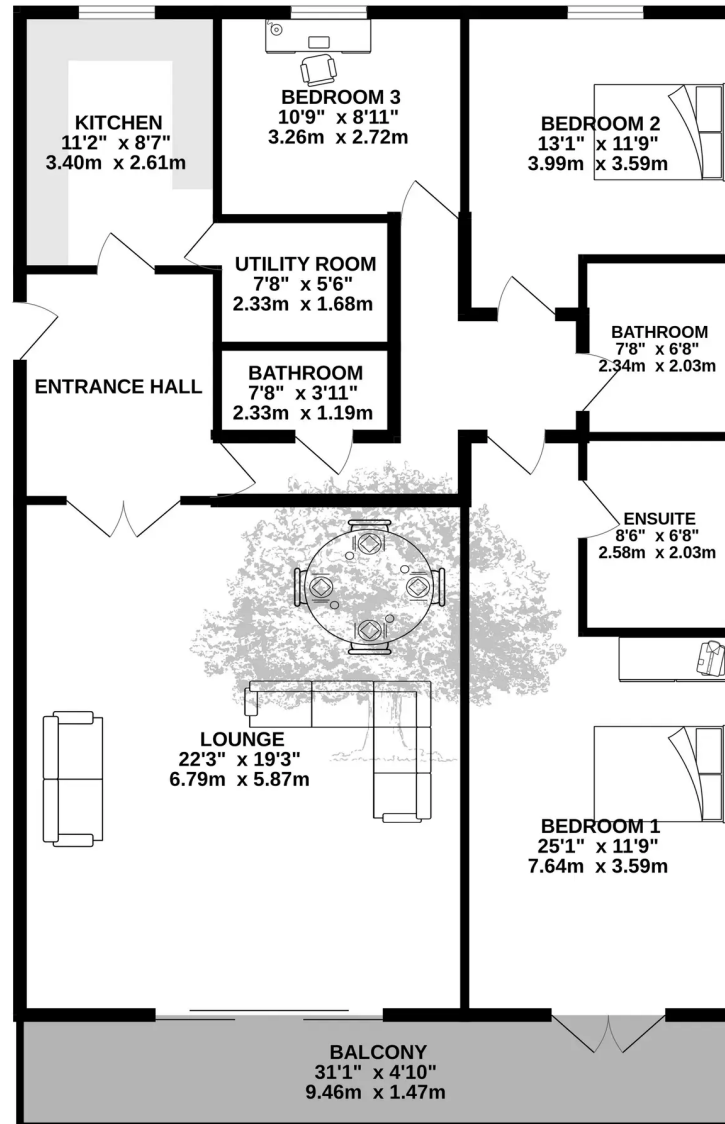

TOTAL FLOOR AREA : 1263 sq.ft. (117.3 sq.m.) approx.

Whilst every attempt has been made to ensure the accuracy of the floorplan contained here, measurements of doors, windows, rooms and any other items are approximate and no responsibility is taken for any error, omission or mis-statement. This plan is for illustrative purposes only and should be used as such by any prospective purchaser. The services, systems and appliances shown have not been tested and no guarantee as to their operability or efficiency can be given.
Made with Metropix ©2023



FINDING YOU A HOME
SINCE 1972 · B

Broadlands

Broadlands Estates, Library Place - JE2 3NL

01534 880770 • enquiries@broadlandsjersey.com • www.broadlandsjersey.com/

BROADLANDS

FINDING YOU A HOME SINCE 1972