



6 Strathcona Way, Flackwell Heath

£530,000



Robertsons

6 Strathcona Way

Flackwell Heath, High Wycombe

A semi detached family home quietly situated near the end of a cul-de-sac in this popular village location. Entrance hall, Sitting room, Dining room, Kitchen, Three bedrooms, Bathroom, Gas central heating, Double glazing, Garage and parking, Gardens. NO CHAIN.

Entrance porch

Door to entrance hall, window to side

Entrance hall

Radiator, stairs to first floor with understairs storage cupboard, wall thermostate, telephone point, window to side

Sitting room

Tiled fireplace with gas point, two wall light points, radiator, dimmer switch, window to front

Dining room

With sliding patio doors to garden, radiator, three wall light points, dimmer switch

Kitchen

Fitted with a range of eye and base level units incorporating sink unit with mixer tap and drainer, built in Bosch oven, fitted four ring ceramic hob with extractor over, space for fridge freezer, space and plumbing for washing machine, radiator, part tiled walls, wall mounted Potterton gas fired central heating boiler, windows to side and rear, door to garden





First floor

Landing

Window to side, access to loft space, airing cupboard housing foam clad hot water cylinder and shelved storage

Bedroom 1

Radiator, window to front

Bedroom 2

Radiator, built in wardrobe, window to front

Bedroom 3

Radiator, window to rear

Bathroom

White suite comprising panelled bath with Mira shower over, W.C., wash hand basin, part tiled walls, electric heater, heated towel rail, wall light point, window to rear

Front garden/Parking

A driveway provides parking. The remainder is laid to lawn with flower and shrub borders

Garage

With metal up and over door, light and power, window to rear

Rear garden

A paved patio leads to the remainder of garden which is laid to lawn with flower and shrub borders. All is enclosed by panelled fencing and extends to 49' x 28' (max.)



Approximate Gross Internal Area
Ground Floor = 48.9 sq m / 526 sq ft
First Floor = 44.5 sq m / 479 sq ft
Garage = 13.7 sq m / 147 sq ft
Total = 107.1 sq m / 1152 sq ft

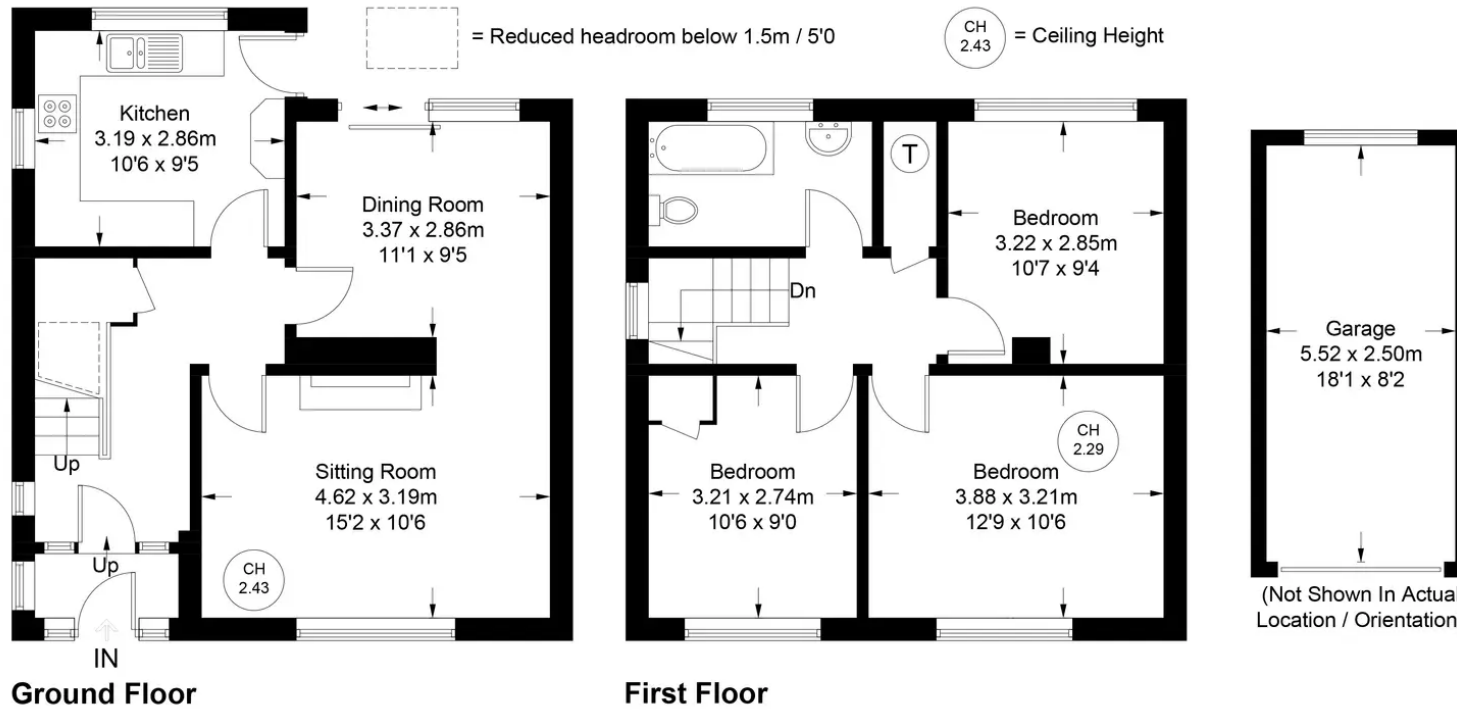

Floor Plan produced for Robertsons by Media Arcade ©.

Illustration for identification purposes only. Window and door openings are approximate. Whilst every attempt is made to assure accuracy in the preparation of this plan, please check all dimensions, shapes and compass bearings before making any decisions reliant upon them.



Robertsons