



# 129 Cranbrook Drive

Maidenhead, Berkshire

CHARLIE FISHER



129 CRANBROOK DRIVE, MAIDENHEAD





# Details

## PROPERTY PROFILE

---



Family home close to Furze Platt Senior School  
3 bedrooms, 1 bathroom  
Impressive garden building with gym and salon  
Close to National Trust land  
Maidenhead town centre and Main line Railway

Discover 129 Cranbrook Drive, a captivating family home offering versatile living spaces at every turn.

As you step inside, you're greeted by the inviting expanse of the ground floor, with a stunning open-plan drawing and dining room. Dual aspect windows frame views to the front and rear gardens. The well-appointed kitchen provides access to the garden. This space is perfect for both intimate gatherings and lively family dinners.

The bedrooms are all found on the first floor and are serviced by a family bathroom.

To the front of the house you find a generous driveway and garage providing ample off street parking. The rear gardens have been thoughtfully designed and finished to create an inviting space for outdoor living and entertaining.

The impressive garden room is divided into two self-contained spaces – a fully-fitted salon and a versatile gym. These spaces are very well finished and provide very flexible uses, catering to a range of lifestyle needs.

**For more information contact  
Charlie Fisher, Managing Partner  
Fisher & Partners Sunningdale**

# Location

---

## THE NEIGHBOURHOOD

---

Conveniently located near Maidenhead town centre, yet boasting a semi-rural ambiance, Cranbrook Drive offers the best of both worlds.

Maidenhead train station provides a regular and quick access to London via the overland train and Elizabeth Line tube services.

Furze Platt Senior School is very close by, as are a variety of schooling options for all ages, offering families access to excellent educational facilities.

Maidenhead has a wide range of charming pubs, restaurants, shops, supermarkets, cinema and other leisure facilities.

129 Cranbrook Drive  
Maidenhead  
Berkshire  
SL6 6RY

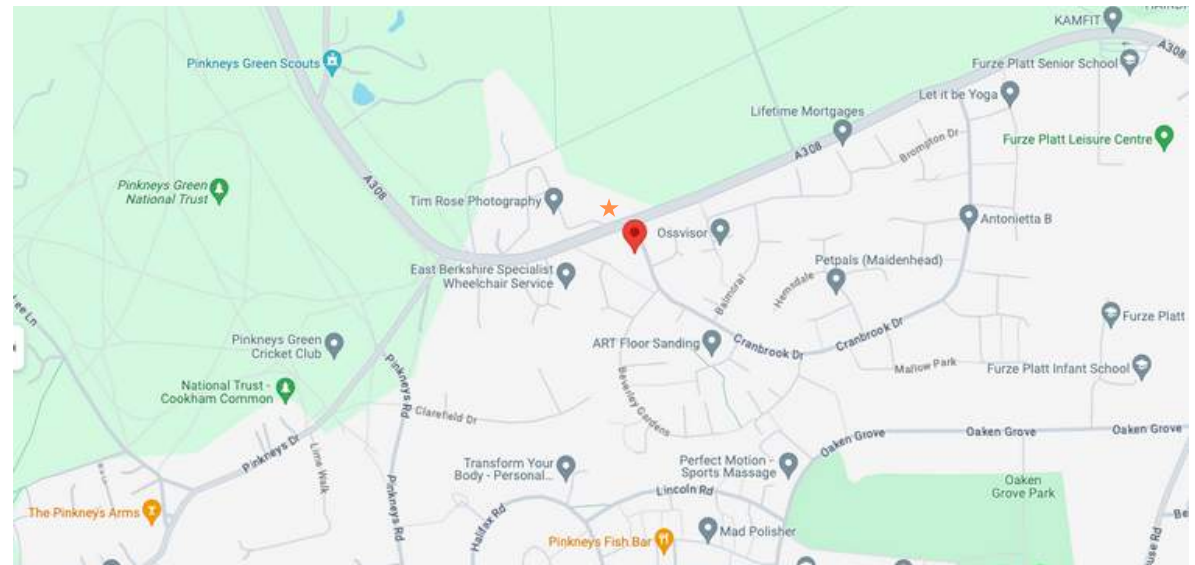



129 GRANBROOK DRIVE, MAIDENHEAD



129 CRANBROOK DRIVE, MAIDENHEAD





129 GRANBROOK DRIVE, MAIDENHEAD



129 CRANBROOK DRIVE, MAIDENHEAD







129 CRANBROOK DRIVE, MAIDENHEAD

129 CRANBROOK DRIVE, MAIDENHEAD







129 CRANBROOK DRIVE, MAIDENHEAD



129 CRANBROOK DRIVE, MAIDENHEAD





# Cranbrook Drive, Maidenhead

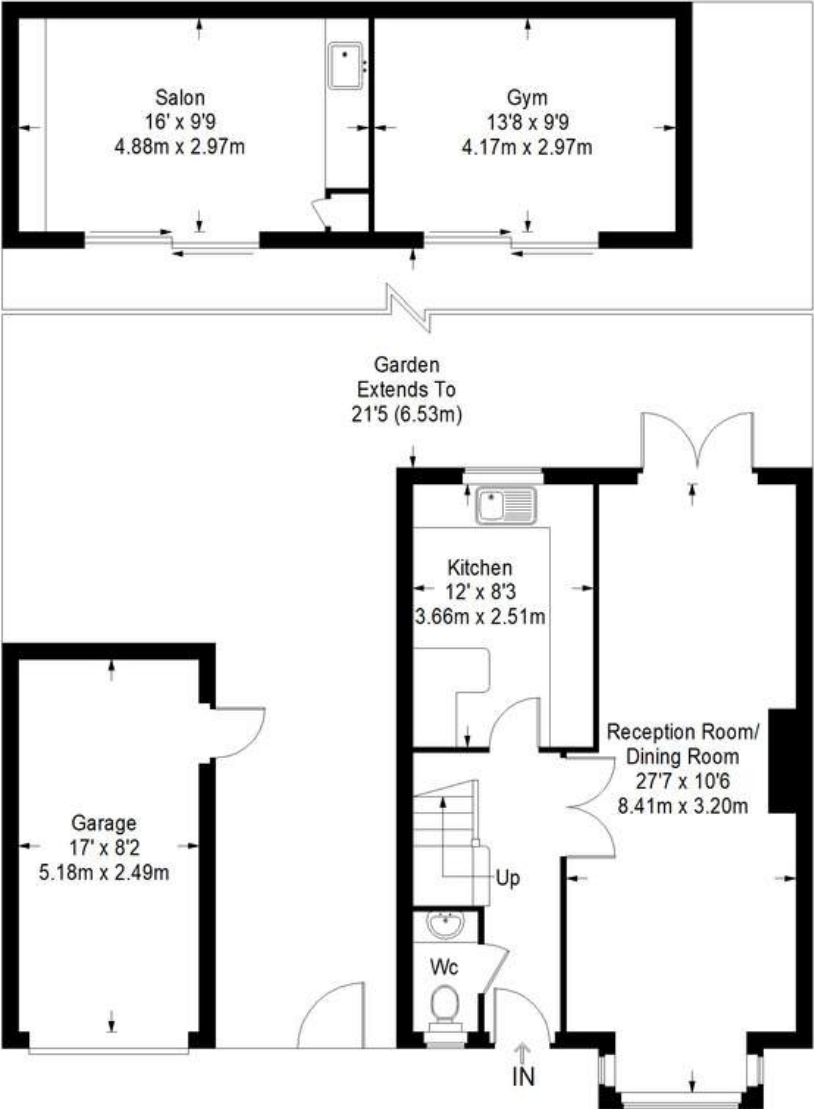

**Ground Floor = 458 sq ft**

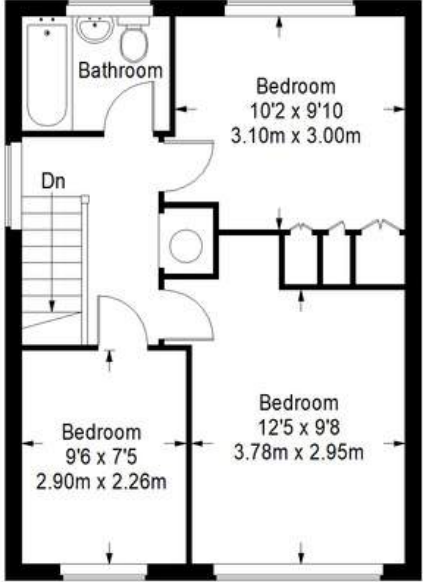

**First Floor = 438 sq ft**

Approximate Gross Internal Area  
 GROUND FLOOR = 458 sq ft / 42.55 sq m  
 FIRST FLOOR = 438 sq ft / 40.69 sq m  
 GARAGE = 142 sq ft / 13.19 sq m  
 SALON/ GYM = 293 sq ft / 27.22 sq m  
 Total = 1331 sq ft / 123.65 sq m



This plan is for layout guidance only. Not drawn to scale unless stated. Windows and door openings are approximate. Whilst every care is taken in the preparation of this plan, please check all dimensions, shapes and compass bearings before making any decisions reliant upon them. (ID357409)

129 CRANBROOK DRIVE, MAIDENHEAD

# Your Managing Partner

Fisher & Partners is transforming the way property is sold.

We're committed to providing exceptional service from start to sale, to make your home buying or selling experience as smooth and successful as possible.

# Team



Charlie Fisher  
Managing Partner, Sunningdale Region



---

Fisher & Partners

---

☎ 01344 948866

🖱 [www.fisherandpartners.com](http://www.fisherandpartners.com)

✉ [charlie@fisherandpartners.com](mailto:charlie@fisherandpartners.com)



SCAN TO BOOK A VIEWING

Contact Us  
Today

