



**WELL PRESENTED THREE BEDROOM FAMILY HOME WITH NO ONWARD CHAIN**

---

Aldbury Road, Mill End, Rickmansworth, Hertfordshire, WD3 8LJ

**ROBSONS**

## WELL PRESENTED THREE BEDROOM FAMILY HOME WITH NO ONWARD CHAIN

- PROPERTY IS ONLY 12 YEARS OLD
- KITCHEN/LIVING/DINING ROOM
- CONSERVATORY
- GUEST WC
- THREE BEDROOMS
- FAMILY BATHROOM
- REAR GARDEN & OFF-STREET PARKING
- NO ONWARD CHAIN

### Description

Available to the market with no onward chain, this well-proportioned three-bedroom family home, conveniently situated within easy reach of local amenities, schools and transport links.

The ground floor comprises a hallway, with a guest cloakroom, under stairs storage and stairs to the first floor. There is a front aspect kitchen offering modern units, integrated appliances, a breakfast bar and a spacious open-plan living/dining room with French doors opening out to a light and bright conservatory overlooking the garden.





To the first floor there are three well-appointed bedrooms and a modern, fully tiled bathroom with bath and shower cubicle.

Externally, this property boasts a well-maintained rear garden laid with easy to maintain Astouurf, a raised decked area and a garden shed. To the front there is a driveway providing off-street parking and access to the rear garden via a side gate.

### Location

Rickmansworth town centre has a wide range of boutique shops, coffee houses, restaurants and major supermarkets. The Metropolitan and Chiltern line train services connect you to London Baker Street, Marylebone Station and beyond. The M25 motorway is available at both junction 17 and 18, connecting you to the national motorway network. Major London airports are also within reach. The area is well served for good quality private and state schools for all ages. Chorleywood and Rickmansworth offer everything for the sporting individual from rugby, cricket, football, tennis, horse riding and golf. Rickmansworth Aquadrome is an ideal setting for walks, sailing, fishing and water skiing.

### Additional Information

Tenure: Freehold  
Local Authority: Three Rivers District Council  
Council Tax: Band C  
Energy Efficiency Rating: Band C



Aldbury Road, Mill End, Rickmansworth, Hertfordshire  
Approximate Gross Internal Area  
86 Sq M/925 Sq Ft

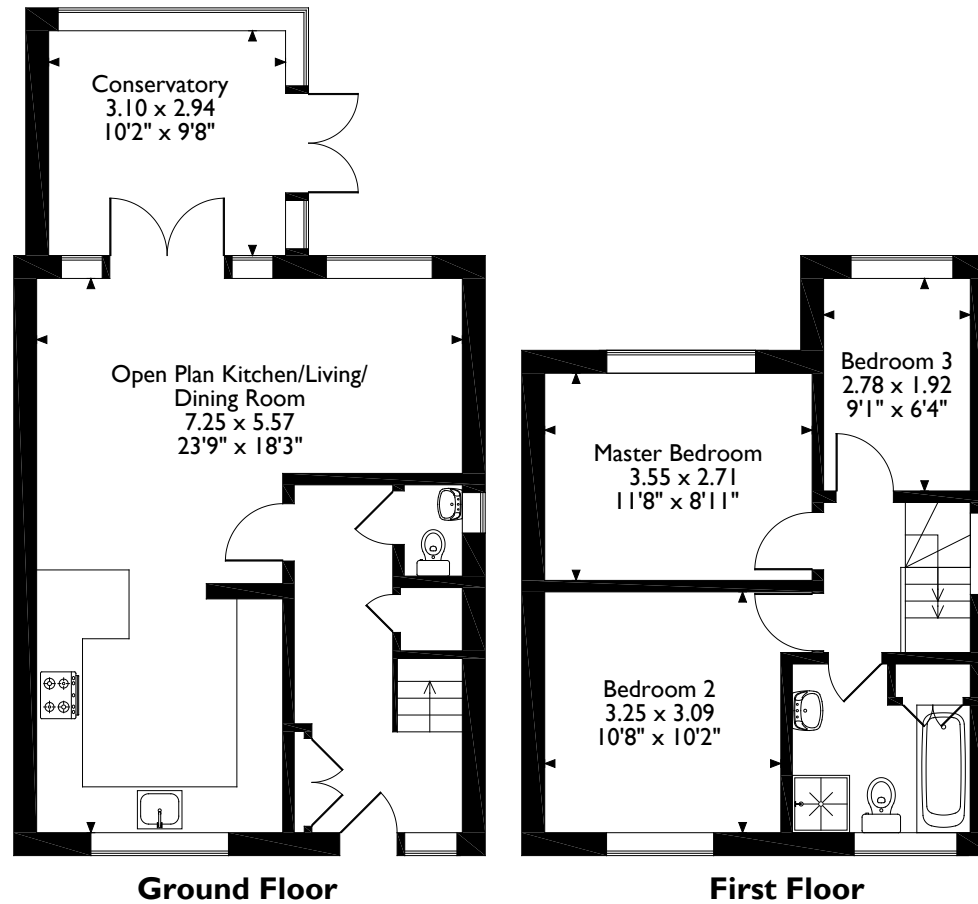

Please note that the location of doors, windows and other items are approximate and this floorplan is to be used for illustrative purposes only. Unauthorized reproduction is prohibited.

**ROBSONS**

130 High Street, Rickmansworth, Hertfordshire, WD3 1AB  
Tel: 01923 777762 rickmansworth@robsonswb.com

[www.robsonswb.com](http://www.robsonswb.com)

www.  
the  
londonoffice.co.uk  
40 ST JAMES'S PLACE SW1