



CHARMING & WELL-PRESENTED TWO BEDROOM HOME IN PRIME LOCATION

Bury Lane, Rickmansworth, Hertfordshire, WD3 1DN



CHARMING & WELL-PRESENTED TWO BEDROOM HOME IN PRIME LOCATION

- 23' RECEPTION ROOM & KITCHEN
- PRINCIPAL BEDROOM
- SECOND BEDROOM
- FAMILY SHOWER ROOM
- SOUTH-FACING REAR GARDEN
- TOWN CENTRE LOCATION

Description

Walking distance to Rickmansworth Station this bright, charming and well-presented two-bedroom home featuring an attractive, south-facing rear garden. This beautiful 19th century property is situated in a popular location in the heart of Rickmansworth Town Centre within easy reach of highly regarded schools, transport links and local amenities.

The ground floor comprises a 23' light and bright open plan reception/dining room and a separate well-equipped kitchen. The kitchen features a range of units providing ample storage space and freestanding appliances, including a cooker, washer/dryer, fridge-freezer and space for a dishwasher with plumbing already in situ.





To the first floor there is a principal bedroom benefiting from fitted wardrobes and a large storage cupboard, a second bedroom and a family bathroom, with a power shower unit and an airing cupboard.

Externally, this lovely home boasts an attractive south-facing rear garden with mature shrubs and flower beds, a paved area to enjoy outside dining and a garden shed.

Location

Rickmansworth town centre has a wide range of boutique shops, coffee houses, restaurants and major supermarkets. The Metropolitan and Chiltern line train services connect you to London Baker Street, Marylebone Station and beyond. The M25 motorway is available at both junction 17 and 18, connecting you to the national motorway network. Major London airports are also within reach. The area is well served for good quality private and state schools for all ages. Chorleywood and Rickmansworth offer everything for the sporting individual from rugby, cricket, football, tennis, horse riding and golf. Rickmansworth Aquadrome is an ideal setting for walks, sailing, fishing and water skiing.

Additional Information

Tenure: Freehold

Local Authority: Three Rivers District Council

Council Tax: Band D

Energy Efficiency Rating: Band D



Bury Lane, Rickmansworth, Hertfordshire
Approximate Gross Internal Area
65 Sq M/699 Sq Ft

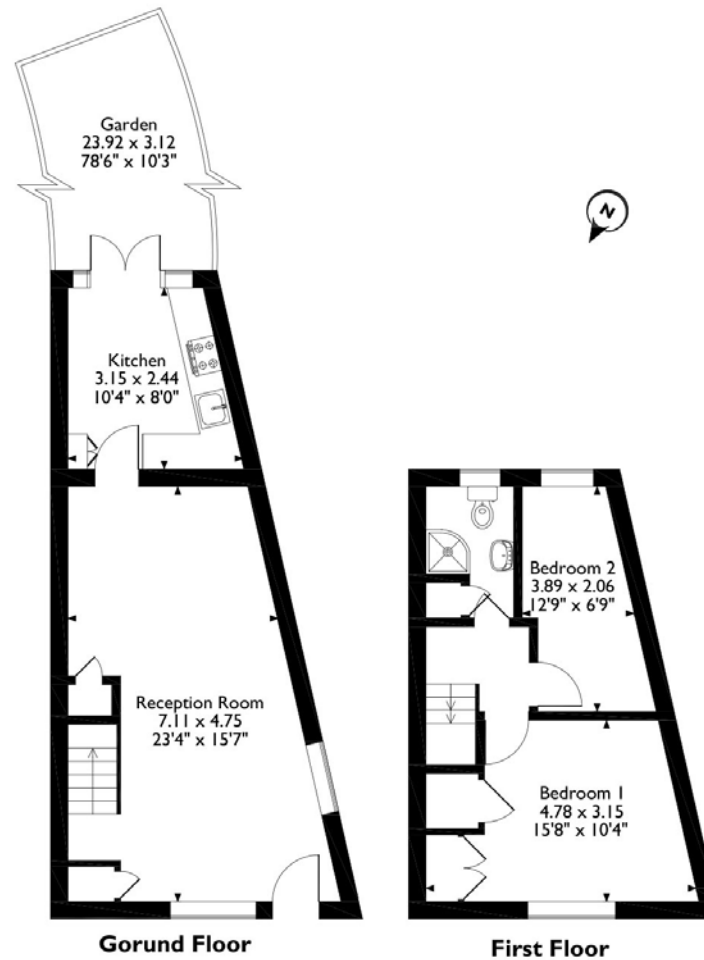

Please note that the location of doors, windows and other items are approximate and this floorplan is to be used for illustrative purposes only. Unauthorized reproduction is prohibited.

ROBSONS

130 High Street, Rickmansworth, Hertfordshire, WD3 1AB
Tel: 01923 777762 rickmansworth@robsonswb.com

www.robsonswb.com

www.the-londonoffice.co.uk
40 ST JAMES'S PLACE SW1